

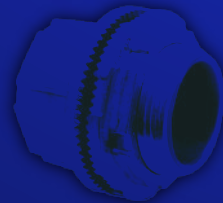

*SINGLE SOURCE...
ELECTRICAL & LIGHTING*

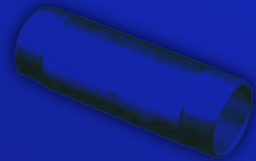
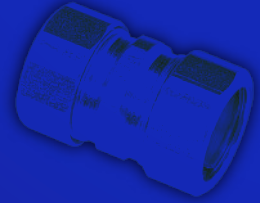

FITTINGS

MORRISPRODUCTS.COM



MORRIS PRODUCTS

was founded in 1994, in Queensbury, NY. Originally created as a supplier of electrical products – wiring devices, lugs and connectors, cable ties and other accessories – Morris' mission was, and remains, to serve the needs of electrical distributors. With a staff of 2 office workers, and 2 warehouse workers, Morris Products soon outgrew its small location, and expanded to a much larger facility in the late 1990s. With that growth, Morris Products expanded with the addition of a full offering of wire management products, compression and mechanical connectors, conduit fittings, and LED Lighting. In 2016, Morris was acquired by DiversiTech Corporation, adding to a strong family of brands for the electrical and HVAC markets.

Today, Morris Products operates out of a state-of-the-art 65,000 square foot facility in Queensbury, NY, and offers electrical distributors more than 8,000 items in inventory, spanning 30 product categories. In addition to the main facility, MORRIS supplies electrical wholesalers from their west coast warehouse in Adelanto, CA, as well as numerous regional rep warehouses.

As a company, we maintain a laser focus on customer service with same day/next day shipping, allowing broken cartons, and no minimum orders. Experience the Morris Advantage, and let us earn your business.

***SINGLE SOURCE...
ELECTRICAL & LIGHTING***

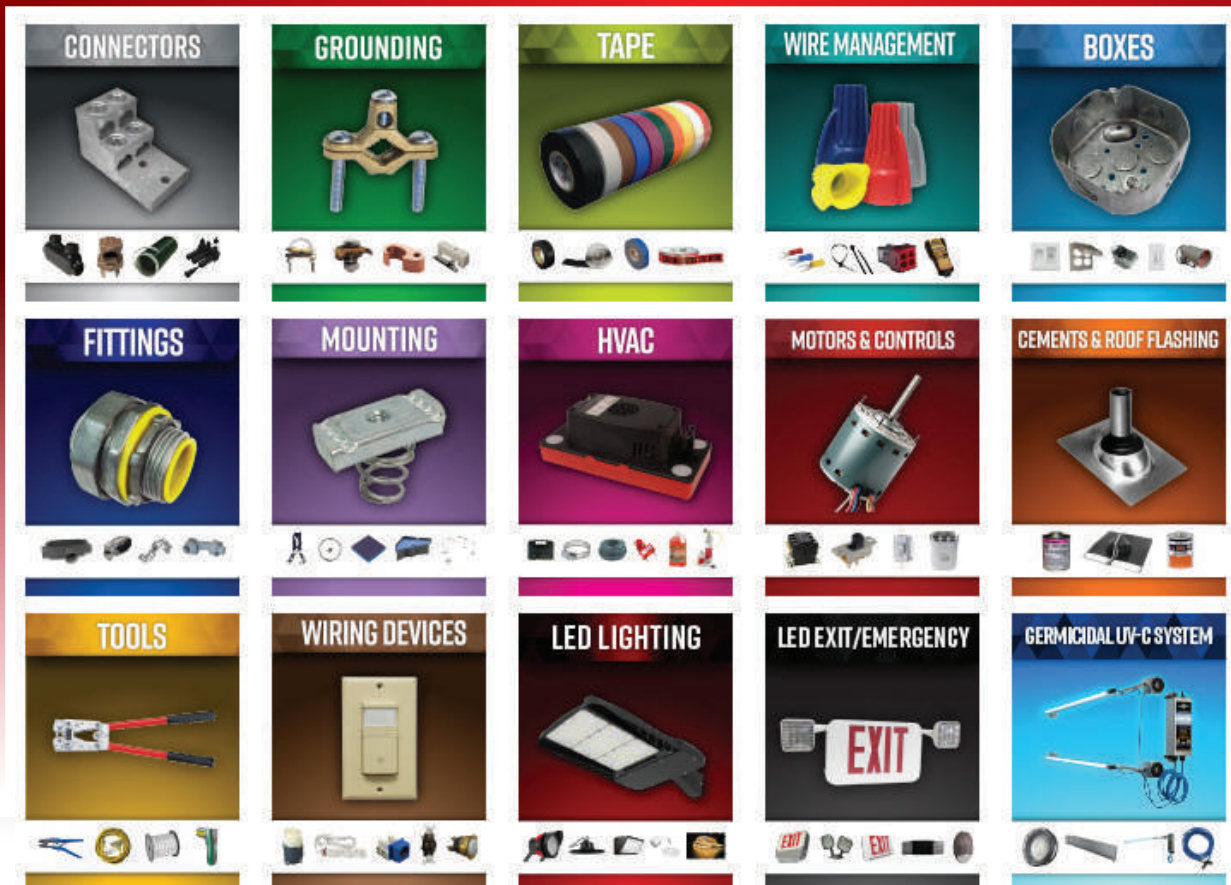

TABLE OF CONTENTS

RIGID FITTINGS	PG: 1-10
EMT FITTINGS	PG: 11-18
CONDUIT BODIES	PG: 19-28
LIQUIDTITE	PG: 29-32
BUSHINGS & KNOCKOUT PLUGS	PG: 33-37
CABLE CORD GRIPS	PG: 38-41
NM, FLEX & BX CONNECTORS	PG: 42-49
SERVICE ENTRANCE	PG: 50-54
BLANKS w/ KO PLUGS	PG: 55-56
PIPE, ROMEX & BX STRAPS	PG: 57-59
STRUT ACCESSORIES	PG: 60-65
CABLE FASTENINGS	PG: 66-67

FITTINGS



Malleable Rigid Set Screw Box Connector



- Connect Thread-less Rigid Conduit to boxes and enclosures
- Malleable Iron
- Concrete Tight
- Male Hub Thread (NPT)
- Zinc Finish

DIMENSIONS = INCHES

CAT. NO.	TRADE SIZE	DIMENSIONS			INNER BOX	OUTER BOX
		A	B	C		
14340	1/2"	1.30	0.75	1.10	25	250
14341	3/4"	1.40	0.91	1.33	25	250
14342	1"	1.54	0.96	1.61	25	100
14343	1-1/4"	1.97	1.30	1.95	5	50
14344	1-1/2"	2.09	1.40	2.18	5	50
14345	2"	2.32	1.57	2.67	-	20

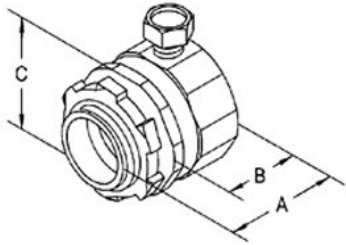

Rigid Set Screw

Malleable Rigid Set Screw Couplings



- Couple Sections of Thread-less Rigid Conduit together
- Malleable Iron
- Concrete Tight
- Zinc Finish

DIMENSIONS = INCHES

CAT. NO.	TRADE SIZE	DIMENSIONS				INNER BOX	OUTER BOX
		A	B	C	D		
14350	1/2"	1.46	1.10	.86	.63	25	250
14351	3/4"	1.40	1.33	1.05	.63	25	250
14352	1"	1.93	1.61	1.36	.63	10	100
14353	1-1/4"	1.97	1.95	1.69	.63	5	50
14354	1-1/2"	2.09	2.18	1.90	.63	5	50
14355	2"	2.32	2.67	2.40	.63	-	20
14356	2-1/2"	3.73	3.45	2.92	.63	-	12
14357	3"	4.10	3.95	3.52	.63	-	12
14358	3-1/2"	4.52	4.45	4.10	.63	-	6
14359	4"	5.62	5.01	4.52	.63	-	6

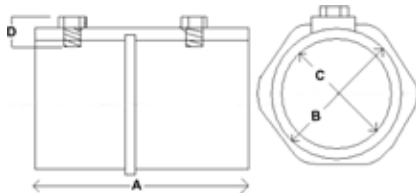

Rigid Short Radius Elbows

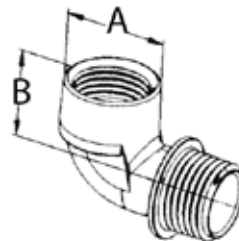

- For Connecting Rigid Conduit or IMC to an Outlet Box in Tight Radius Applications
- Zinc Die Cast

DIMENSIONS = INCHES

CAT. NO.	TRADE SIZE	DIMENSIONS		INNER BOX	OUTER BOX
		A	B		
14408	1/2"	.95	.95	25	250
14409	3/4"	1.16	1.00	15	150



Rigid Steel Compression Box Connector



- Connect Thread-less Rigid Conduit to boxes and enclosures
- Zinc Plated Steel
- Concrete Tight
- Male Hub Thread (NPT)

DIMENSIONS = INCHES

CAT. NO.	TRADE SIZE	DIMENSIONS			INNER BOX	OUTER BOX
		A	B	C		
I4360	1/2"	1.37	0.50	1.22	20	200
I4361	3/4"	1.44	0.53	1.46	10	100
I4362	1"	1.72	0.67	1.72	5	50
I4363	1-1/4"	1.93	0.68	2.15	5	50
I4364	1-1/2"	2.03	0.72	2.36	-	12
I4365	2"	2.02	0.72	2.89	-	12



Rigid Compression



Rigid Steel Compression Insulated Box Connector

- Connect Thread-less Rigid Conduit to boxes and enclosures
- Zinc Plated Steel
- Insulated Throat
- Concrete Tight
- Male Hub Thread (NPT)

DIMENSIONS = INCHES

CAT. NO.	TRADE SIZE	DIMENSIONS			INNER BOX	OUTER BOX
		A	B	C		
I4370	1/2"	1.37	0.51	1.22	20	200
I4371	3/4"	1.44	0.53	1.46	10	100
I4372	1"	1.72	0.67	1.72	5	50
I4373	1-1/4"	1.93	0.68	2.15	5	50
I4374	1-1/2"	2.03	0.72	2.36	-	12
I4375	2"	2.02	0.72	2.89	-	12

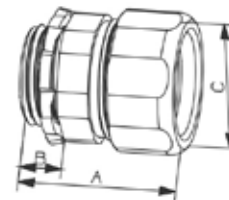

Rigid Steel Compression Couplings

- Couple Sections of Thread-less Rigid Conduit together
- Zinc Plated Steel
- Concrete Tight

DIMENSIONS = INCHES

CAT. NO.	TRADE SIZE	DIMENSIONS		INNER BOX	OUTER BOX
		A	B		
I4380	1/2"	1.83	1.22	10	100
I4381	3/4"	1.97	1.46	10	100
I4382	1"	2.11	1.72	5	50
I4383	1-1/4"	2.39	2.15	5	50
I4384	1-1/2"	2.52	2.36	-	12
I4385	2"	2.40	2.89	-	5

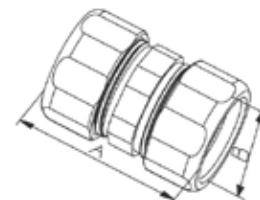



Rigid Steel Couplings

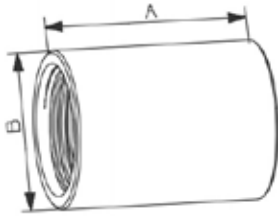

- Connect Threaded Rigid Conduit
- Zinc Plated Steel
- Concrete Tight
- Male Hub Thread (NPT)

DIMENSIONS = INCHES

CAT. NO.	TRADE SIZE	DIMENSIONS		INNER BOX
		LENGTH	OD	
14387	1/2"	1.63	1.01	100
14388	3/4"	1.64	1.25	50
14389	1"	1.97	1.53	30
14390	1-1/4"	2.03	1.87	25
14391	1-1/2"	2.06	2.16	25
14392	2"	2.13	2.65	20
14393	2-1/2"	3.19	3.25	12
14394	3"	3.31	3.87	12
14395	3-1/2"	3.41	4.50	12
14396	4"	3.52	4.88	6
14397	5"	3.95	6.00	2
14398	6"	4.25	7.20	1

Rigid Couplings

Malleable Rigid 3-Piece Couplings

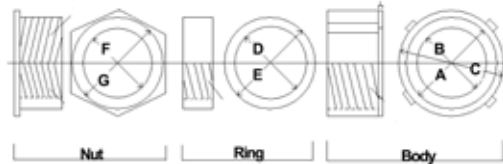

- Used to Join 2 lengths of Threaded Conduit when Neither Can Be Rotated
- Threaded (NPT) for Rigid Conduit and IMC
- Concrete Tight

DIMENSIONS = INCHES

CAT. NO.	TRADE SIZE	DIMENSIONS							INNER BOX	OUTER BOX
		A	B	C	D	E	F	G		
14440	1/2"	1.01	.869	1.30	.788	.981	.775	1.05	20	200
14441	3/4"	1.20	1.10	1.55	.970	1.19	.965	1.25	10	100
14442	1"	1.52	1.33	1.78	1.22	1.50	1.23	1.58	5	50
14443	1-1/4"	1.91	1.69	2.20	1.58	1.85	1.56	1.90	5	50
14444	1-1/2"	2.15	1.93	2.50	1.83	2.10	1.78	2.20	3	30
14445	2"	2.65	2.40	3.08	2.25	2.58	2.25	2.75	-	20
14446	2-1/2"	3.20	2.90	3.75	2.70	3.10	2.70	3.31	-	10
14447	3"	3.85	3.58	4.40	3.35	3.82	3.30	4.40	-	5
14448	3-1/2"	4.09	4.05	5.04	4.10	4.15	4.00	4.90	-	5
14449	4"	4.89	4.55	5.40	4.30	4.85	4.33	5.02	-	2
14450	5"	5.89	5.55	6.75	5.43	5.84	5.43	5.93	-	1
14451	6"	6.93	6.62	7.62	6.50	6.81	6.50	6.87	-	1

Malleable Rigid Split Couplings

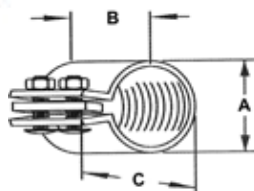

- A Speed Union for Economically Joining 2 Threaded Rigid Metal Conduits
- A Neoprene Gasket provides a Concrete Tight Seal at the Joint
- Use where Conduit Runs are Closely Spaced; or Conduit is tight against Wall, Ceiling or other Obstruction
- Use where Conduits Cannot be Rotated

DIMENSIONS = INCHES

CAT. NO.	TRADE SIZE	DIMENSIONS			INNER BOX	OUTER BOX
		A	B	C		
14452	2"	2.75	2.04	3.30	5	25
14453	2-1/2"	3.20	2.98	4.23	2	10
14454	3"	3.85	3.14	4.85	2	10
14455	3-1/2"	4.48	3.26	5.36	1	5
14456	4"	4.83	3.34	6.07	1	5



NEW

90° Galvanized Rigid Conduit Elbows



- Galvanized
- Rigid & IMC
- NPT Thread
- For use with conduit

CAT. NO.	ORIENTATION	TRADE SIZE	DIMENSIONS			OUTER BOX
			RADIUS	OFFSET B	TANGENT	
16101	90°	1/2"	-	-	-	50
16102	90°	3/4"	-	-	-	50
16103	90°	1"	-	-	-	25
16104	90°	1-1/4"	-	-	-	20
16105	90°	1-1/2"	-	-	-	15
16106	90°	2"	-	-	-	10
16107	90°	2"	24"	35	11	108
16108	90°	2"	36"	48	12	108
16109	90°	2"	48"	60	12	108
16110	90°	2-1/2"	-	-	-	50
16111	90°	2-1/2"	-	-	-	70
16112	90°	2-1/2"	-	-	-	70
16113	90°	2-1/2"	-	60	12	108
16114	90°	3"	-	-	-	35
16115	90°	3"	24"	35	11	48
16116	90°	3"	36"	48	12	48
16117	90°	3"	36"	48	12	48
16118	90°	3-1/2"	-	-	-	35
16119	90°	4"	-	-	-	35
16120	90°	4"	24"	35	11	40
16121	90°	4"	36"	48	12	40
16122	90°	4"	48"	60	12	40



Rigid Elbows



NEW

45° Galvanized Rigid Conduit Elbows

- Galvanized
- Rigid & IMC
- NPT Thread
- For use with conduit

CAT. NO.	ORIENTATION	TRADE SIZE	DIMENSIONS			OUTER BOX
			RADIUS	OFFSET B	TANGENT	
16151	45°	1/2"	-	-	-	50
16152	45°	3/4"	-	-	-	50
16153	45°	1"	-	-	-	25
16154	45°	1-1/4"	-	-	-	20
16155	45°	1-1/2"	-	-	-	15
16156	45°	2"	-	-	-	10
16157	45°	2"	24"	16"	12"	108
16158	45°	2"	36"	19"	12"	108
16159	45°	2"	48"	23"	12"	108
16160	45°	2-1/2"	-	-	-	50
16161	45°	2-1/2"	24"	16"	12"	70
16162	45°	2-1/2"	36"	19"	12"	70
16163	45°	2-1/2"	48"	23"	12"	70
16164	45°	3"	-	-	-	35
16165	45°	3"	24"	16"	12"	48
16166	45°	3"	36"	19"	12"	48
16167	45°	3"	48"	23"	12"	48
16168	45°	3-1/2"	-	-	-	35
16172	45°	4"	-	-	-	35
16173	45°	4"	24"	16"	12"	40
16174	45°	4"	36"	19"	12"	40
16175	45°	4"	48"	23"	12"	40





EMT/RIGID To BOX Combination Pulling Elbow - Zinc Die Cast

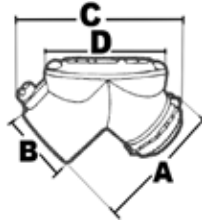

- Used to Connect a run of EMT, Threaded Rigid or IMC conduit to a Box at a 90° Bend
- Threaded and Set Screw Conduit Entrance
- Removable Aluminum Cover and Neoprene Gasket facilitates wire pulling
- Assembled with Zinc Die Cast Locknut
- Combo Head Set Screws

DIMENSIONS = INCHES

CAT. NO.	TRADE SIZE	DIMENSIONS				INNER BOX	OUTER BOX
		A	B	C	D		
15040	1/2"	1.31	1.01	2.40	1.78	20	200
15041	3/4"	1.44	1.19	2.66	2.14	15	150
15042	1"	1.94	1.53	3.66	3.24	6	60

Rigid Pulling Elbows

EMT/RIGID To EMT/RIGID Combination Pulling Elbow - Zinc

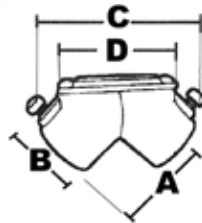

- Used to facilitate pulling conductors through a sharp bend in a run of EMT, Threaded Rigid or IMC conduit
- Threaded and Set Screw Conduit Entrance
- Removable Aluminum Cover and Neoprene Gasket facilitates wire pulling
- Combo Head Set Screws

DIMENSIONS = INCHES

CAT. NO.	TRADE SIZE	DIMENSIONS				INNER BOX	OUTER BOX
		A	B	C	D		
15044	1/2"	1.37	1.01	2.63	1.78	20	200
15045	3/4"	1.43	1.23	2.73	2.14	15	150

Rigid to Rigid Pull Elbows - Zinc Die Cast

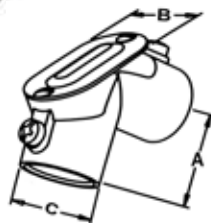

- For use as a Wire Pulling Elbow to Facilitate Wire Pulling on a Sharp Bend in run of Threaded Rigid or IMC Conduit
- Removable Cover allows easy access to facilitate wire pulling
- Furnished with Neoprene Gasket and Cover
- Rain Tight

DIMENSIONS = INCHES

CAT. NO.	TRADE SIZE	DIMENSIONS			OUTER BOX
		A	B	C	
14400	1/2"	1.31	1.03	0.99	100
14401	3/4"	1.39	1.30	1.26	50
14402	1"	1.96	1.55	1.52	30
14403	1-1/4"	2.32	1.90	1.91	20



Rigid to Box Pull Elbows - Zinc Die Cast



- For Connecting Threaded Rigid Conduit or IMC to Box or Enclosures to Form 90° bend
- Removable Cover allows easy access to Facilitate Wire Pulling
- Furnished with Neoprene Gasket and Cover
- Rain Tight

DIMENSIONS = INCHES

CAT. NO.	TRADE SIZE	DIMENSIONS			OUTER BOX
		A	B	C	
14404	1/2"	1.34	1.03	0.97	100
14405	3/4"	1.40	1.30	1.19	50
14406	1"	1.97	1.55	1.51	30
14407	1-1/4"	2.32	1.90	1.91	20

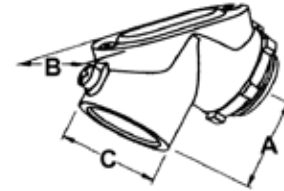

Straight Malleable Concrete Slab Inserts For Threaded Rigid Conduit



- Allows In-Slab Ceiling Drops & Floor Mounts in Poured Concrete
- Provides Flush Threaded Conduit Hub for mounting, pulling, & future access to conduit systems
- Design allows In-Slab Conduit System Prefabrication
- Designed for Straight Through Conduit Runs and Mounting of Floor boxes in slabs over 6" thick

DIMENSIONS = INCHES

CAT. NO.	TRADE SIZE	DIMENSIONS			OUTER BOX
		A	B	C	
14420	1/2"	1.50	1.75	1.25	20
14421	3/4"	2.72	2.00	1.75	20
14422	1"	2.50	3.25	1.50	10

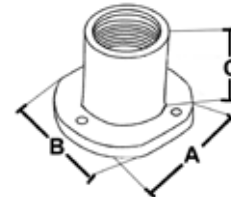

90° Malleable Concrete Slab Inserts For Threaded Rigid Conduit



- Allows In-Slab Ceiling Drops & Floor Mounts in Poured Concrete
- Provides Flush Threaded Conduit Hub for mounting, pulling, and future access to conduit systems
- Allows In-Slab Conduit System Prefabrication - Flush Design
- Designed to Eliminate Bending of conduit in slabs over 4" thick
- Designed for 90° Bends Through Conduit Runs

DIMENSIONS = INCHES

CAT. NO.	TRADE SIZE	DIMENSIONS				OUTER BOX
		A	B	C	D	
14423	1/2"	1.50	1.75	3.12	3.62	20
14424	3/4"	2.75	2.00	3.06	3.68	20
14425	1"	2.50	3.75	2.93	3.68	10

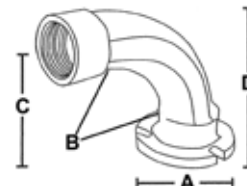



Rigid Offset Nipples - Zinc Die Cast

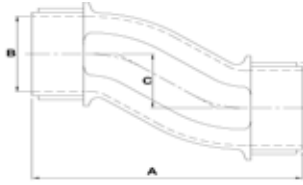

- Use as an Offset Connector between Two Enclosures
- To Offset the Axis of Raceways 3/4"

DIMENSIONS = INCHES

CAT. NO.	TRADE SIZE	DIMENSIONS			INNER BOX	OUTER BOX
		A	B	C		
14460	1/2"	2.42	.59	.75	35	350
14461	3/4"	2.42	.78	.75	20	200
14462	1"	2.58	1.00	.75	15	150
14463	1-1/4"	2.83	1.32	.75	5	50
14464	1-1/2"	2.87	1.53	.75	5	50
14465	2"	3.11	1.99	.75	3	30
14466	2-1/2"	4.13	2.35	.75	-	18
14467	3"	4.47	2.95	.75	-	15

Rigid Nipples

1" Long Conduit Speed Nipple - Zinc Die Cast

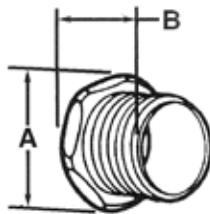

- Use with Rigid Coupling to Terminate Threaded Conduit to a Knockout, Box or Enclosure, where space is limited within the box
- Use with a Locknut to provide a Short Raceway between Boxes and enclosures

DIMENSIONS = INCHES

CAT. NO.	TRADE SIZE	DIMENSIONS		INNER BOX	OUTER BOX
		A	B		
14502	1/2"	1.04	1.00	100	1,000
14503	3/4"	1.34	1.00	50	500
14504	1"	1.63	1.00	25	250

Rigid Nipples - Zinc Die Cast

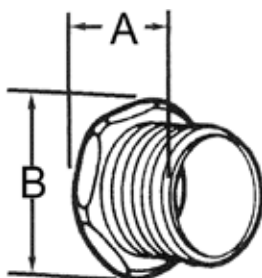

- Use with Rigid Coupling to Terminate Threaded Conduit to a Knockout, Box or Enclosure, where space is limited within the box
- Used with a Locknut to provide a Short Raceway between Boxes and Enclosures

DIMENSIONS = INCHES

CAT. NO.	TRADE SIZE	DIMENSIONS		INNER BOX	OUTER BOX
		A	B		
14480	1/2"	.64	.98	100	1,000
14481	3/4"	.72	1.18	100	1,000
14482	1"	.81	1.50	50	500
14483	1-1/4"	.94	1.77	25	250
14484	1-1/2"	1.07	2.17	25	150
14485	2"	1.08	2.60	15	90
14486	2-1/2"	1.09	3.09	-	20
14487	3"	1.25	3.71	-	20
14488	3-1/2"	1.27	4.24	-	10
14489	4"	1.27	4.70	-	10



Rigid Nipples with Insulated Throat - Zinc



- Use with Rigid Coupling to Terminate Threaded Conduit to a Knockout Box or Enclosure where space is limited within the box
- Used with a Locknut to provide a Short Raceway between Boxes and Enclosures
- Insulated Throat

DIMENSIONS = INCHES

CAT. NO.	TRADE SIZE	DIMENSIONS		INNER BOX	OUTER BOX
		A	B		
14490	1/2"	.68	.98	100	1,000
14491	3/4"	.82	1.18	100	1,000
14492	1"	.85	1.50	50	500
14493	1-1/4"	1.00	1.77	25	250
14494	1-1/2"	1.13	2.17	25	150
14495	2"	1.14	2.60	15	90
14496	2-1/2"	1.16	3.09	-	20
14497	3"	1.33	3.71	-	20
14498	3-1/2"	1.35	4.24	-	10
14499	4"	1.35	4.70	-	10

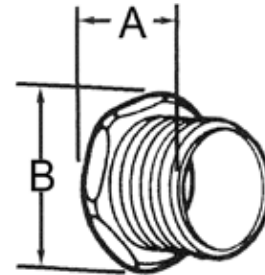

- Connect Threaded Rigid Conduit
- Zinc Plated Steel
- Concrete Tight
- Male Hub Thread (NPT)

CAT. NO.	TRADE SIZE	INNER BOX
14600	1/2" X CLOSE	25
14601	1/2" X 1-1/2"	25
14602	1/2" X 2"	25
14603	1/2" X 3"	25
14604	1/2" X 4"	25
NEW 15601	1/2" X 12"	25
14610	3/4" X CLOSE	25
14611	3/4" X 1-1/2"	25
14612	3/4" X 2"	25
14613	3/4" X 3"	25
14614	3/4" X 4"	25
NEW 15605	3/4" X 6"	25
NEW 15606	3/4" X 8"	25
NEW 15607	3/4" X 10"	25
NEW 15608	3/4" X 12"	25
14615	1" X CLOSE	25
14616	1" X 2"	25
14617	1" X 2-1/2"	25
14618	1" X 3"	25
14619	1" X 4"	25
NEW 15612	1" X 6"	25
NEW 15615	1" X 12"	25
NEW 14647	1-1/4" X CLOSE	25
NEW 14648	1-1/4" X 2"	25
NEW 14635	1-1/4" X 3"	25
NEW 14636	1-1/4" X 4"	25
NEW 14637	1-1/4" X 6"	25
NEW 15627	1-1/4" X 12"	30
14638	1-1/2" X CLOSE	25
14639	1-1/2" X 2"	25
14640	1-1/2" X 3"	25
14641	1-1/2" X 4"	25
14650	1-1/2" X 6"	25
NEW 15636	1-1/2" X 12"	20
14642	2" X CLOSE	25

Rigid Steel Nipples

CAT. NO.	TRADE SIZE	INNER BOX
14643	2" X 3"	25
14644	2" X 4"	25
14645	2" X 5"	25
14646	2" X 6"	25
NEW 15643	2" X 8"	20
NEW 15644	2" X 10"	20
NEW 15645	2" X 12"	15
NEW 15650	2-1/2" X CLOSE	40
NEW 15651	2-1/2" X 3"	40
NEW 15653	2-1/2" X 4"	30
NEW 15655	2-1/2" X 6"	20
NEW 15656	2-1/2" X 8"	10
NEW 15657	2-1/2" X 10"	10
NEW 15658	2-1/2" X 12"	10
14655	3" X CLOSE	10
14656	3" X 3"	10
14657	3" X 4"	10
14658	3" X 5"	10
14659	3" X 6"	10
NEW 15661	3" X 8"	7
NEW 15662	3" X 10"	5
NEW 15663	3" X 12"	5
NEW 15670	3-1/2" X CLOSE	5
NEW 15671	3-1/2" X 3"	10
NEW 15673	3-1/2" X 4"	8
NEW 15674	3-1/2" X 5"	4
NEW 15675	3-1/2" X 6"	4
NEW 15676	3-1/2" X 8"	4
14691	3-1/2" X 10"	10
14693	4" X 4"	6
14695	4" X 5"	5
14697	4" X 6"	5
NEW 15680	4" X 8"	4
NEW 15681	4" X 10"	4
NEW 15682	4" X 12"	4



Rigid Nipples



Conduit Bushings - Zinc Die Cast



- Used with a locknut to terminate threaded Rigid and IMC conduit to a box or enclosure
- Bushings rounded surface prevents damage to wire insulation during pulling

DIMENSIONS = INCHES

CAT. NO.	TRADE SIZE	DIMENSIONS		INNER BOX	OUTER BOX
		A	B		
I4530	1/2"	1.06	0.41	140	1,400
I4531	3/4"	1.28	0.41	100	1,000
I4532	1"	1.54	0.50	50	500
I4533	1-1/4"	1.89	0.54	30	300
I4534	1-1/2"	2.12	0.62	20	200
I4535	2"	2.64	0.51	15	150
I4536	2-1/2"	3.23	0.62	-	75
I4537	3"	3.82	0.83	-	65
I4538	3-1/2"	4.95	0.85	-	50
I4539	4"	4.84	3.95	-	40

Rigid Bushings

Conduit Bushings with Insulated Throat - Zinc Die Cast



- Used with a locknut to terminate threaded Rigid and IMC conduit to a box or enclosure
- Bushings rounded surface prevents damage to wire insulation during pulling
- Insulated Throat

DIMENSIONS = INCHES

CAT. NO.	TRADE SIZE	DIMENSIONS		INNER BOX	OUTER BOX
		A	B		
I4540	1/2"	1.06	0.41	140	1,400
I4541	3/4"	1.28	0.41	100	1,000
I4542	1"	1.54	0.50	50	500
I4543	1-1/4"	1.89	0.54	30	300
I4544	1-1/2"	2.12	0.62	20	200
I4545	2"	2.64	0.51	15	150
I4546	2-1/2"	3.23	0.62	-	75
I4547	3"	3.82	0.83	-	65
I4548	3-1/2"	4.95	0.85	-	50
I4549	4"	4.84	3.91	-	40

Grounding Bushing Insulated Throat with Aluminum Lug - Zinc



- Used with a locknut to terminate threaded Rigid & IMC conduit to a box or enclosure and to provide a smooth pulling surface
- Thermoplastic liner prevents damage to wire insulation
- Lug provides for bonding jumper to a neutral bus bar
- Resists corrosion, chemicals, and temperature extremes
- Set-screw provided with each fitting locks bushing in any desired position

DIMENSIONS = INCHES

CAT. NO.	TRADE SIZE	GROUNDING LUG RANGE	DIMENSIONS			INNER BOX	OUTER BOX
			A	B	C		
I4570	1/2"	#14 - #4	1.04	0.56	0.43	50	500
I4571	3/4"	#14 - #4	1.26	0.75	0.49	40	400
I4572	1"	#14 - #4	1.56	0.97	0.55	25	250
I4574	1-1/4"	#14 - #4	1.95	1.30	0.60	25	250
I4576	1-1/2"	#14 - #2	2.14	1.48	0.65	25	250
I4578	2"	#14 - #2	2.85	1.81	0.68	10	100
I4579	2-1/2"	#14 - #1/0	3.19	2.30	0.79	5	50
I4581	3"	#14 - #1/0	3.82	2.83	0.87	5	50
I4583	3-1/2"	#14 - #2/0	4.28	3.35	0.87	4	40
I4585	4"	#14 - #2/0	4.86	3.78	0.91	4	40

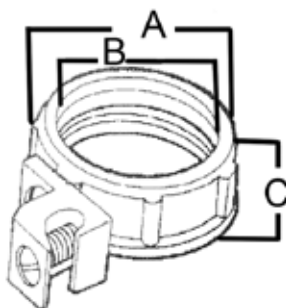



Thermoplastic Conduit Bushings



- Use to Protect Conductors in Rigid or IMC Conduit from Abrasion/Damage during Pull
- Rounded surface of bushing prevents damage to wire insulation
- Thermoplastic material-heat, impact & torque resistant

DIMENSIONS = INCHES

CAT. NO.	TRADE SIZE	DIMENSIONS		INNER BOX	OUTER BOX
		A	B		
21732	1/2"	1.06	0.43	100	1,000
21733	3/4"	1.31	0.43	100	1,000
21734	1"	1.59	0.48	50	500
21735	1-1/4"	1.96	0.56	25	250
21736	1-1/2"	2.18	0.56	25	250
21737	2"	2.68	0.59	20	200
21738	2-1/2"	3.25	0.72	-	50
21739	3"	3.87	0.75	-	25
21740	3-1/2"	4.37	0.77	-	25
21741	4"	5.00	0.77	-	10
21742	5"	6.25	1.00	-	10
21743	6"	7.50	1.00	-	10

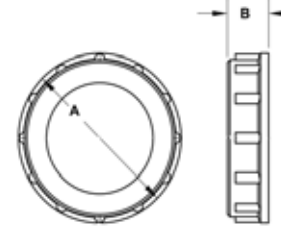

Malleable Reducing Bushings

- Reduce the trade size of a tapered entry on a conduit fitting
- Threaded for rigid and IMC condulets, Hex Shoulder
- Rolled edge protects wire insulation

DIMENSIONS = INCHES

CAT. NO.	TRADE SIZE	DIMENSIONS		INNER BOX	OUTER BOX
		A	B		
14700	2-1/2" X 1"	2.83	1.22	-	10
14701	2-1/2" X 1-1/4"	2.83	1.58	-	10
14702	2-1/2" X 1-1/2"	2.83	1.83	-	10
14703	2-1/2" X 2"	2.83	2.28	-	10
14704	3-1/2" X 1-1/2"	3.45	1.83	-	10
14705	3-1/2" X 2"	3.45	2.28	-	10
14706	3-1/2" X 2-1/2"	3.96	2.70	-	10
14707	3-1/2" X 3"	3.96	3.35	-	10
14708	4" X 2-1/2"	4.45	2.70	-	10
14709	4" X 3-1/2"	4.45	4.10	-	10



Steel Reducing Bushings

DIMENSIONS = INCHES

CAT. NO.	TRADE SIZE	DIMENSIONS		INNER BOX	OUTER BOX
		A	B		
14660	1/2" X 3/8"	.63	.91	100	1,000
14661	3/4" X 1/2"	.65	1.02	100	1,000
14662	1" X 1/2"	.72	1.27	50	500
14663	1" X 3/4"	.72	1.27	50	500
14664	1-1/4" X 1/2"	.82	1.62	10	100
14665	1-1/4" X 3/4"	.82	1.62	25	250
14666	1-1/4" X 1"	.81	1.62	25	250
14667	1-1/2" X 1/2"	.85	1.85	25	100
14668	1-1/2" X 3/4"	.85	1.85	25	100
14669	1-1/2" X 1"	.85	1.85	25	100
14670	1-1/2" X 1-1/4"	.85	1.85	25	250
14671	2" X 1/2"	.97	2.23	10	40
14672	2" X 3/4"	.97	2.23	10	40
14673	2" X 1"	.97	2.23	10	40
14674	2" X 1-1/4"	.97	2.23	10	100
14675	2" X 1-1/2"	.97	2.23	10	100
14676	3" X 1/2"	1.57	3.43	-	10
14677	3" X 3/4"	1.57	3.43	-	10
14678	3" X 1"	1.57	3.43	-	10
14679	3" X 1-1/4"	1.57	3.43	-	10
14680	3" X 1-1/2"	1.57	3.43	-	10
14681	3" X 2"	1.57	3.43	-	10
14682	3" X 2-1/2"	1.57	3.43	-	5
14683	4" X 1/2"	1.68	4.43	-	5
14684	4" X 3/4"	1.68	4.43	-	5
14685	4" X 1"	1.68	4.43	-	5
14686	4" X 1-1/4"	1.68	4.43	-	5
14687	4" X 1-1/2"	1.68	4.43	-	5
14688	4" X 2"	1.68	4.43	-	5
14689	4" X 3"	1.68	4.43	-	5

- Reduce trade size of tapered entry on a conduit fitting
- Threaded for Rigid Conduit & IMC
- Rolled edge protects wire insulation

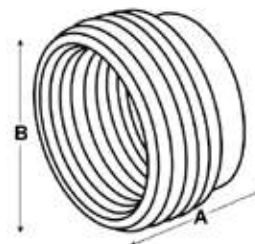



EMT Set Screw Connectors - Zinc Die Cast

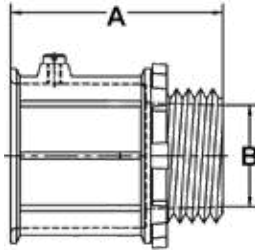

- Use to connect EMT Conduit to Steel Outlet Box, Load Center, or other Metal Enclosures
- Concrete Tight (When Taped)
- Die-Cast Zinc, Male hub threads NPS
- Pre-Set/Pre-Staked Combo Head Set-Screws
- UL Listed for EMT Conduit
- 2-1/2" - 4" are also UL Listed for use with Rigid & IMC
- 2-1/2" - 4" Uses 2 Set Screws

DIMENSIONS = INCHES

CAT. NO.	TRADE SIZE	DIMENSIONS		INNER BOX	OUTER BOX
		A	B		
14850	1/2"	1.16	0.93	50	500
14851	3/4"	1.38	1.17	25	250
14852	1"	1.50	1.42	25	200
14853	1-1/4"	1.97	1.82	10	100
14854	1-1/2"	2.26	2.07	10	60
14855	2"	2.56	2.52	5	40
14856	2-1/2"	3.09	3.30	-	12
14857	3"	3.37	3.91	-	12
14858	3-1/2"	3.52	3.43	-	6
14859	4"	3.76	4.88	-	6

EMT Zinc Set Screw

EMT Set Screw Connectors - Insulated Throat - Zinc Die Cast

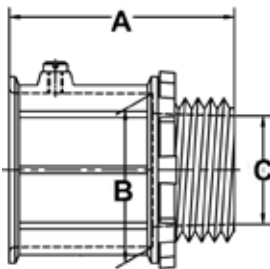

- Use to connect EMT Conduit to Steel Outlet Box, Load Center, or other Metal Enclosures
- Insulated Throat
- Concrete Tight (When Taped)
- Die-Cast Zinc, Male hub threads NPS
- Pre-Set/Pre-Staked Combo Head Set-Screws
- UL Listed for EMT Conduit
- 2-1/2" - 4" are also UL Listed for use with Rigid & IMC
- 2-1/2" - 4" Uses 2 Set Screws

DIMENSIONS = INCHES

CAT. NO.	TRADE SIZE	DIMENSIONS			INNER BOX	OUTER BOX
		A	B	C		
14860	1/2"	1.14	.72	.59	50	500
14861	3/4"	1.33	.94	.78	25	250
14862	1"	1.54	1.18	1.00	25	200
14863	1-1/4"	1.99	1.53	1.32	10	100
14864	1-1/2"	2.13	1.76	1.53	10	60
14865	2"	2.44	2.22	1.99	5	40
14866	2-1/2"	3.03	2.92	2.34	-	12
14867	3"	3.22	3.55	2.88	-	12
14868	3-1/2"	3.58	4.05	3.31	-	6
14869	4"	3.72	4.55	3.86	-	6

EMT Set Screw Couplings - Zinc Die Cast

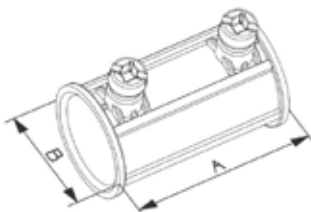

- Use to connect EMT Conduit to EMT Conduit
- Concrete Tight (When Taped)
- Die-Cast Zinc
- Pre-set/Pre-staked Combo Head Set-screws
- UL Listed for EMT Conduit
- 2-1/2" - 4" are also UL Listed for use with Rigid & IMC
- 2-1/2" - 4" Uses 4 Set Screws

DIMENSIONS = INCHES

CAT. NO.	TRADE SIZE	DIMENSIONS		INNER BOX	OUTER BOX
		A	B		
14870	1/2"	1.49	0.91	50	500
14871	3/4"	1.94	1.18	25	250
14872	1"	2.28	1.41	20	200
14873	1-1/4"	2.62	1.82	10	100
14874	1-1/2"	2.91	2.04	10	60
14875	2"	3.48	2.52	5	20
14876	2-1/2"	4.01	3.30	-	12
14877	3"	4.46	3.91	-	12
14878	3-1/2"	4.88	4.05	-	6
14879	4"	5.25	4.91	-	6



EMT Set Screw Connectors - Steel



- Use to Connect EMT Conduit to Steel Box, Load Center, or other Metal Enclosures
- Heavy Steel Walls
- Pre-Set/Pre-Staked Combo Head Set-Screws
- Male NPSM hub threads
- Concrete Tight (When Taped)
- UL Listed for EMT Conduit
- 2-1/2" - 4" are also for use with Rigid & IMC
- 2-1/2" - 4" Uses 2 Set Screws

DIMENSIONS = INCHES

CAT. NO.	TRADE SIZE	DIMENSIONS		INNER BOX	OUTER BOX
		A	B		
14880	1/2"	.84	1.47	50	500
14881	3/4"	1.06	1.57	25	250
14882	1"	1.32	1.86	20	200
14883	1-1/4"	1.68	2.24	-	25
14884	1-1/2"	1.91	2.24	-	25
14885	2"	2.37	2.35	-	20
14886	2-1/2"	3.14	2.89	-	12
14887	3"	3.77	2.95	-	12
14888	3-1/2"	4.28	3.23	-	6
14889	4"	4.78	3.33	-	6

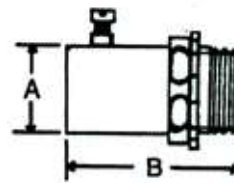

EMT Set Screw Connectors - Insulated Throat - Steel

- Use to Connect EMT Conduit to Steel Box, Load Center, or other Metal Enclosures
- Insulated Throat
- Heavy Steel Walls
- Pre-Set/Pre-Staked Combo Head Set-Screws
- Male NPSM hub threads
- Concrete Tight (When Taped)
- UL Listed for EMT Conduit
- 2-1/2" - 4" are also for use with Rigid & IMC
- 2-1/2" - 4" Uses 2 Set Screws

DIMENSIONS = INCHES

CAT. NO.	TRADE SIZE	DIMENSIONS		INNER BOX	OUTER BOX
		A	B		
14890	1/2"	.84	1.51	50	500
14891	3/4"	1.06	1.61	25	250
14892	1"	1.32	1.90	20	200
14893	1-1/4"	1.68	2.28	-	25
14894	1-1/2"	1.91	2.28	-	25
14895	2"	2.37	2.40	-	20
14896	2-1/2"	3.14	2.95	-	12
14897	3"	3.77	3.02	-	12
14898	3-1/2"	4.28	3.29	-	6
14899	4"	4.78	3.39	-	6

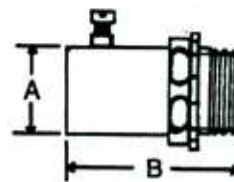

EMT Set Screw Couplings - Steel

- Use to Join Two Lengths of EMT Conduit together
- Heavy Steel Walls
- Pre-Set/Pre-Staked Combo Head Set-Screws
- Concrete Tight (When Taped)
- UL Listed for EMT Conduit
- 2-1/2" - 4" are also for use with Rigid & IMC
- 2-1/2" - 4" Uses 4 Set Screws

DIMENSIONS = INCHES

CAT. NO.	TRADE SIZE	DIMENSIONS		INNER BOX	OUTER BOX
		A	B		
14900	1/2"	.84	1.59	50	500
14901	3/4"	1.06	1.80	25	250
14902	1"	1.32	2.04	10	100
14903	1-1/4"	1.68	2.76	-	25
14904	1-1/2"	1.91	2.97	-	25
14905	2"	2.37	3.22	-	20
14906	2-1/2"	3.14	3.86	-	12
14907	3"	3.77	4.23	-	12
14908	3-1/2"	4.28	4.48	-	6
14909	4"	4.78	4.72	-	6

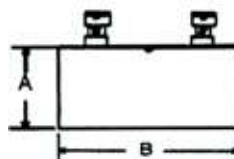



EMT Compression Connectors - Zinc Die Cast



- To secure and terminate EMT to knockouts in concrete tight box, dry or damp location applications
- Male NPSM hub threads
- Concrete tight
- UL Listed for EMT Conduit
- 2-1/2" - 4" are also UL Listed for use with Rigid & IMC

DIMENSIONS = INCHES

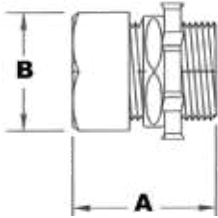

CAT. NO.	TRADE SIZE	DIMENSIONS		INNER BOX	OUTER BOX
		A	B		
14910	1/2"	1.26	0.97	50	500
14911	3/4"	1.21	1.26	25	250
14912	1"	1.58	1.52	15	150
14913	1-1/4"	1.62	1.91	10	100
14914	1-1/2"	1.87	2.28	10	40
14915	2"	2.146	2.61	5	20
14916	2-1/2"	2.54	3.37	-	12
14917	3"	2.54	3.94	-	12
14918	3-1/2"	2.60	4.45	-	6
14919	4"	2.60	1.94	-	6

EMT Compression Connectors - Insulated Throat - Zinc Die Cast



- To secure and terminate EMT to knockouts in concrete tight box, dry or damp location application
- Male NPSM hub threads
- Concrete tight
- UL Listed for EMT Conduit
- 2-1/2" - 4" are also UL Listed for use with Rigid & IMC

DIMENSIONS = INCHES

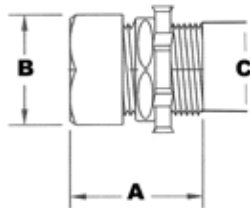

CAT. NO.	TRADE SIZE	DIMENSIONS			INNER BOX	OUTER BOX
		A	B	C		
14920	1/2"	1.32	0.97	.59	50	500
14921	3/4"	1.27	1.26	.78	25	250
14922	1"	1.64	1.52	1.00	15	150
14923	1-1/4"	1.70	1.91	1.32	10	100
14924	1-1/2"	1.95	2.28	1.53	10	40
14925	2"	2.23	2.61	1.99	5	20
14926	2-1/2"	2.62	3.37	2.35	-	12
14927	3"	2.62	3.94	2.95	-	12
14928	3-1/2"	2.68	4.45	3.43	-	6
14929	4"	2.68	4.94	3.91	-	6

EMT Compression Couplings - Zinc Die Cast



- To join lengths of EMT for concrete tight, dry or damp location applications
- Concrete tight
- UL Listed for EMT Conduit
- 2-1/2" - 4" are also UL Listed for use with Rigid & IMC

DIMENSIONS = INCHES

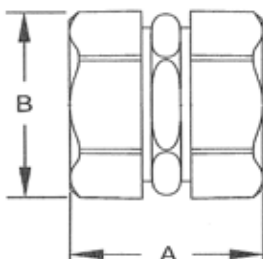

CAT. NO.	TRADE SIZE	DIMENSIONS		INNER BOX	OUTER BOX
		A	B		
14930	1/2"	1.53	0.97	50	500
14931	3/4"	1.58	1.26	25	250
14932	1"	1.87	1.52	15	150
14933	1-1/4"	2.25	1.91	10	100
14934	1-1/2"	3.18	2.28	10	50
14935	2"	2.44	2.61	5	20
14936	2-1/2"	3.15	3.37	-	12
14937	3"	3.15	3.94	-	12
14938	3-1/2"	3.27	4.45	-	6
14939	4"	3.27	4.94	-	6



Steel EMT Compression Connectors



- Use to connect EMT conduit to steel outlet box, load center, or other metal enclosure
- Heavy Steel Walls, Zinc Plated
- Male hub threads - NPSM
- Concrete tight (When Taped)
- UL Listed for EMT Conduit
- 2-1/2" - 4" are also UL Listed for use with Rigid & IMC

DIMENSIONS - INCHES

CAT. NO.	TRADE SIZE	DIMENSIONS				INNER BOX	OUTER BOX
		A	B	C	D		
14940	1/2"	1.06	1.37	1.13	.73	25	250
14941	3/4"	1.30	1.46	1.38	.95	25	250
14942	1"	1.59	1.58	1.72	1.19	-	75
14943	1-1/4"	2.08	2.05	2.06	1.54	-	25
14944	1-1/2"	2.27	2.13	2.37	1.77	-	20
14945	2"	2.72	2.24	2.89	2.22	-	10
14946	2-1/2"	3.46	3.27	3.52	2.93	-	8
14947	3"	4.02	3.50	4.20	3.58	-	4
14948	3-1/2"	4.62	3.78	4.79	4.05	-	4
14949	4"	5.02	3.80	5.32	4.58	-	6

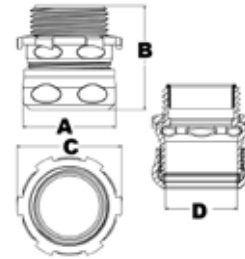

Steel EMT Compression Connectors - Insulated Throat

- Use to connect EMT conduit to steel outlet box, load center, or other metal enclosure
- Heavy Steel Walls, Zinc Plated
- Insulated throat
- Male hub threads - NPSM
- Concrete tight (When Taped)
- UL Listed for EMT Conduit
- 2-1/2" - 4" are also UL Listed for use with Rigid & IMC

DIMENSIONS - INCHES

CAT. NO.	TRADE SIZE	DIMENSIONS				INNER BOX	OUTER BOX
		A	B	C	D		
14950	1/2"	1.06	1.41	1.13	.73	25	250
14951	3/4"	1.30	1.50	1.38	.95	25	250
14952	1"	1.59	1.61	1.72	1.19	-	75
14953	1-1/4"	2.08	2.10	2.06	1.54	-	25
14954	1-1/2"	2.27	2.17	2.37	1.77	-	20
14955	2"	2.72	2.29	2.89	2.22	-	15
14956	2-1/2"	3.46	3.35	3.52	2.93	-	8
14957	3"	4.02	3.58	4.20	3.58	-	4
14958	3-1/2"	4.62	3.86	4.79	4.05	-	4
14959	4"	5.02	3.88	5.32	4.58	-	4

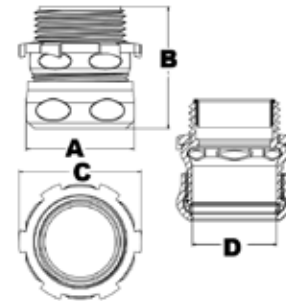

Steel EMT Compression Couplings

- Use to join to lengths of EMT conduit together
- Heavy Steel Walls, Zinc Plated
- Concrete tight (When Taped)
- UL Listed for EMT Conduit
- 2-1/2" - 4" are also UL Listed for use with Rigid & IMC

DIMENSIONS - INCHES

CAT. NO.	TRADE SIZE	DIMENSIONS				INNER BOX	OUTER BOX
		A	B	C	D		
14960	1/2"	1.72	1.06	1.00	.73	25	250
14961	3/4"	1.73	1.30	1.22	.95	25	250
14962	1"	1.91	1.59	1.48	1.19	10	100
14963	1-1/4"	2.53	2.08	1.93	1.54	-	25
14964	1-1/2"	2.62	2.27	2.16	1.77	-	20
14965	2"	2.78	2.72	2.57	2.22	-	10
14966	2-1/2"	3.94	3.70	3.46	2.93	-	8
14967	3"	4.17	4.38	4.02	3.58	-	4
14968	3-1/2"	4.70	4.68	4.62	4.05	-	4
14969	4"	4.96	5.40	5.02	4.58	-	6

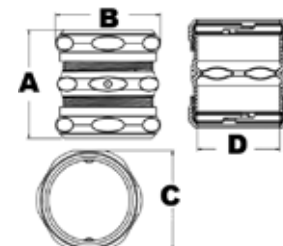



Steel EMT Rain Tight Compression Connectors

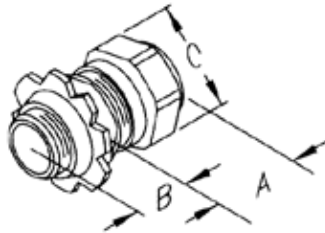

- Use to connect EMT conduit to steel outlet box, load center, or other metal enclosure in a dry or wet location
- Internal Sealing Ring & Knockout Gasket create Raintight Seal
- Heavy Steel Walls, Zinc Plated
- Concrete Tight
- UL Listed for EMT Conduit
- 2-1/2" - 4" are also UL Listed for use with Rigid & IMC

DIMENSIONS = INCHES

CAT. NO.	TRADE SIZE	DIMENSIONS			INNER BOX	OUTER BOX
		A	B	C		
14970	1/2"	1.14	.51	1.08	50	500
14971	3/4"	1.42	.51	1.35	25	250
14972	1"	1.58	.57	1.65	10	100
14973	1-1/4"	1.60	.61	2.02	10	100
14974	1-1/2"	1.93	.63	2.24	10	50
14975	2"	2.23	.67	2.80	5	50
14976	2-1/2"	2.80	.83	3.60	-	12
14977	3"	3.00	.83	4.25	-	12
14978	3-1/2"	3.35	.83	4.80	-	6
14979	4"	3.47	.83	5.24	-	6

Steel EMT Rain Tight Compression Connectors-Insulated Throat

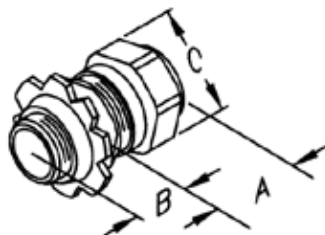

- Use to connect EMT conduit to steel outlet box, load center, or other metal enclosure in dry or wet location
- Internal Sealing Ring & Knockout Gasket create Raintight Seal
- Heavy Steel Walls, Zinc Plated
- Insulated throat
- Concrete Tight
- UL Listed for EMT Conduit
- 2-1/2" - 4" are also UL Listed for use with Rigid & IMC

DIMENSIONS = INCHES

CAT. NO.	TRADE SIZE	DIMENSIONS			INNER BOX	OUTER BOX
		A	B	C		
14980	1/2"	1.18	.51	1.08	50	500
14981	3/4"	1.46	.51	1.35	25	250
14982	1"	1.61	.57	1.65	10	100
14983	1-1/4"	1.69	.61	2.02	10	100
14984	1-1/2"	2.00	.61	2.24	10	50
14985	2"	2.36	.67	2.76	5	50
14986	2-1/2"	2.87	.83	3.62	-	12
14987	3"	3.07	.83	4.25	-	12
14988	3-1/2"	3.42	.83	4.80	-	6
14989	4"	3.54	.83	5.24	-	6

Steel EMT Compression Rain Tight Couplings

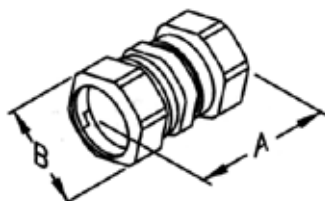

- Use to connect two lengths of EMT conduit together in a dry or wet location
- Internal Sealing Ring creates Rain Tight Seal
- Heavy Steel Walls, Zinc Plated
- Concrete Tight
- UL Listed for EMT Conduit
- 2-1/2" - 4" are also UL Listed for use with Rigid & IMC

DIMENSIONS = INCHES

CAT. NO.	TRADE SIZE	DIMENSIONS		INNER BOX	OUTER BOX
		A	B		
14990	1/2"	1.81	1.08	50	500
14991	3/4"	1.89	1.35	25	250
14992	1"	2.30	1.65	10	100
14993	1-1/4"	2.68	2.02	10	100
14994	1-1/2"	2.74	2.24	10	50
14995	2"	2.95	2.76	5	50
14996	2-1/2"	3.90	3.62	-	12
14997	3"	4.11	4.25	-	12
14998	3-1/2"	4.53	4.80	-	6
14999	4"	4.65	5.24	-	6



EMT To Box Offset Set Screw Connector - Zinc Die Cast



- Use to connect EMT conduit to a Metal Box or Enclosure where Offset is Required
- Zinc Die-Cast
- Combo Head Set-Screw
- Assembled with Zinc Die Cast Locknut
- Concrete Tight (When Taped)

DIMENSIONS = INCHES

CAT. NO.	TRADE SIZE	DIMENSIONS		INNER BOX	OUTER BOX
		A	B		
15010	1/2"	2.11	.37	20	200
15011	3/4"	2.85	.75	10	100
15012	1"	3.14	1.19	-	100

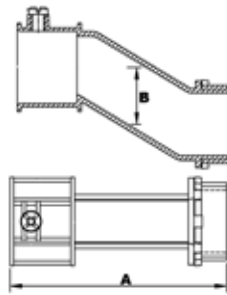

EMT To Box Offset Compression Connector - Zinc Die Cast

- Use to connect EMT conduit to a Metal Outlet Box or Enclosure where an Offset is Required
- Zinc Die-Cast
- Compression Style
- Assembled with Zinc Die Cast Locknut
- Concrete Tight (When Taped)

DIMENSIONS = INCHES

CAT. NO.	TRADE SIZE	DIMENSIONS		INNER BOX	OUTER BOX
		A	B		
15014	1/2"	2.11	.37	20	200
15015	3/4"	2.88	.75	10	100

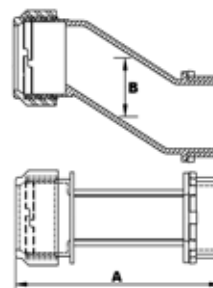

EMT to EMT Inside Corner Set Screw Pulling Elbows

- Use to Connect EMT Conduit together on a 90° Inside Corner
- Combo Head Set Screws
- Zinc Die Cast

DIMENSIONS = INCHES

CAT. NO.	TRADE SIZE	DIMENSIONS			INNER BOX	OUTER BOX
		A	B	C		
15020	1/2"	2.32	2.32	.59	10	100
15021	3/4"	2.64	2.64	.78	5	50
15022	1"	2.94	2.94	1.19	-	50

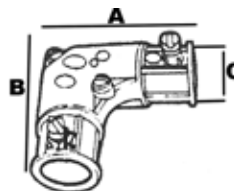

EMT Insulating Bushings

DIMENSIONS = INCHES

CAT. NO.	TRADE SIZE	DIMENSIONS		BAG QTY
		A	B	
21700	1/2"	.522	.570	100
21701	3/4"	.538	.764	50
21702	1"	.614	.954	25
21703	1-1/4"	.620	1.26	25
21704	1-1/2"	.620	1.44	25
21705	2"	.620	1.86	20
21706	2-1/2"	1.12	2.34	-
21707	3"	1.19	2.78	-
21708	3-1/2"	1.22	3.27	-
21709	4"	1.22	3.71	-

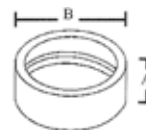

- EMT Insulating Bushings protect cables from abrasion
- Fast & Easy press-on installation
- Meets NEC Article 300-15C requirements
- Listed for use in environmental air handling spaces per 2005 NEC code requirements 300-22C
- Polyethylene rated at 194°F(90°C)



EMT To BOX Set Screw Pulling Elbows - Zinc Die Cast



- Used to Connect EMT to a Metal Box/Enclosure at a 90° Bend
- Removable Aluminum Cover and Neoprene Gasket facilitates wire pulling
- Zinc Die Cast
- Assembled with Zinc Die Cast locknut
- Combo Head Set Screws

DIMENSIONS = INCHES

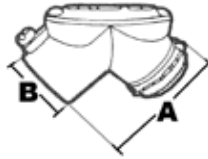

CAT. NO.	TRADE SIZE	DIMENSIONS		OUTER BOX
		A	B	
15030	1/2"	1.34	.97	100
15031	3/4"	1.40	1.26	50
15032	1"	1.97	1.51	30
15033	1-1/4"	2.32	1.91	20

EMT To EMT Set Screw Pulling Elbows - Zinc Die Cast



- Used to Connect EMT together at a 90° bend
- Zinc Die Cast
- Removable Aluminum Cover and Neoprene Gasket facilitates wire pulling
- Combo Head Set Screws

DIMENSIONS = INCHES

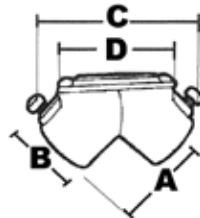

CAT. NO.	TRADE SIZE	DIMENSIONS				OUTER BOX
		A	B	C	D	
15035	1/2"	1.31	0.96	2.56	1.78	100
15036	3/4"	1.39	1.23	2.81	2.15	50
15037	1"	1.96	1.51	3.88	3.17	30
15038	1-1/4"	2.32	1.91	4.62	3.25	20

EMT/RIGID To BOX Combination Pulling Elbow - Zinc Die Cast



- Used to Connect a run of EMT, Threaded Rigid or IMC conduit to a Box at a 90° Bend
- Threaded and Set Screw Conduit Entrance
- Removable Aluminum Cover and Neoprene Gasket facilitates wire pulling
- Assembled with Zinc Die Cast Locknut
- Combo Head Set Screws

DIMENSIONS = INCHES

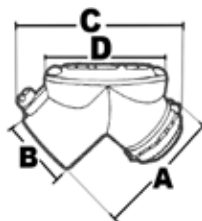

CAT. NO.	TRADE SIZE	DIMENSIONS				INNER BOX	OUTER BOX
		A	B	C	D		
15040	1/2"	1.31	0.96	2.40	1.78	20	200
15041	3/4"	1.39	1.23	2.66	2.14	15	150
15042	1"	1.96	1.52	3.66	3.24	6	60

EMT/RIGID To EMT/RIGID Combination Pulling Elbow - Zinc



- Used to facilitate pulling conductors through a sharp bend in a run of EMT, Threaded Rigid or IMC conduit
- Threaded and Set Screw Conduit Entrance
- Removable Aluminum Cover and Neoprene Gasket facilitates wire pulling
- Combo Head Set Screws

DIMENSIONS = INCHES

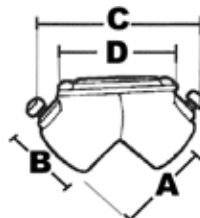

CAT. NO.	TRADE SIZE	DIMENSIONS				INNER BOX	OUTER BOX
		A	B	C	D		
15044	1/2"	1.31	0.96	2.63	1.78	20	200
15045	3/4"	1.39	1.23	2.73	2.14	15	150



NEW

90° EMT Elbows



- Hot Dip Galvanized
- For use with conduit

CAT. NO.	ORIENTATION	TRADE SIZE	DIMENSIONS			OUTER BOX
			RADIUS	OFFSET B	TANGENT	
16001	90°	1/2"	4.00	6.90	2.9	50
16002	90°	3/4"	4.50	7.40	2.9	50
16003	90°	1"	5.80	8.70	3	25
16004	90°	1-1/4"	7.30	10.60	3.3	20
16005	90°	1-1/2"	8.30	11.90	3.6	15
16006	90°	2"	9.50	13.80	4.3	10
16007	90°	2-1/2"	10.50	15.80	5.3	156
16008	90°	3"	13.00	18.80	5.8	35
16009	90°	3-1/2"	15.00	21.80	6.8	35
16010	90°	4"	16.00	23.10	7.1	35



NEW

45° EMT Elbows



- Hot Dip Galvanized
- For use with conduit

CAT. NO.	ORIENTATION	TRADE SIZE	DIMENSIONS				OUTER BOX
			RADIUS	OFFSET B	OFFSET C	TANGENT	
16011	45°	1/2"	4	7	2.9	1.9	50
16012	45°	3/4"	4.5	7.4	3	2	50
16013	45°	1"	5.8	9.5	4	2.7	25
16014	45°	1-1/4"	7.3	13.1	5.4	4.3	20
16015	45°	1-1/2"	8.3	14	5.8	4.3	15
16016	45°	2"	9.5	16.1	6.6	5.4	10
16017	45°	2-1/2"	10.5	19	7.9	6.8	240
16018	45°	3"	13	20.5	8.5	6.7	35
16019	45°	3-1/2"	15	22.8	9.5	7.1	35
16020	45°	4"	16	29.2	12.1	10.5	35



Aluminum Rigid Conduit Bodies T Type - Threaded

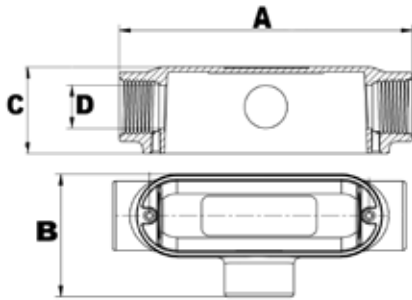

- Tapered Threaded Hubs (NPT)
- RainTight when used with Gasketed Covers
- Die-Cast from High-Strength, Corrosion and Weather Resistant Copper Free Aluminum Alloy
- Flat Back Design for easy mounting close to walls

To Provide Access to Conductors for Pulling, Splicing, and Maintenance. Threaded for Rigid & IMC Conduit

DIMENSIONS = INCHES

CAT. NO.	TRADE SIZE	DIMENSIONS - T SERIES				BOX QTY
		A	B	C	D	
14060	1/2"	4.72	2.03	1.36	.61	50
14061	3/4"	5.51	2.30	1.63	.81	50
14062	1"	6.46	2.68	1.89	1.04	25
14063	1-1/4"	8.35	3.52	2.50	1.37	10
14064	1-1/2"	8.35	3.52	2.50	1.60	10
14065	2"	10.55	4.27	3.41	2.06	10
14066	2-1/2"	13.46	5.89	3.98	2.46	1
14067	3"	13.46	5.89	4.53	3.06	1
14068	3-1/2"	16.30	7.66	5.60	3.54	1
14069	4"	16.30	7.66	5.60	4.02	1
WITH COVER AND GASKET						
14070	1/2"	4.72	2.03	1.36	.61	50
14071	3/4"	5.51	2.30	1.63	.81	50
14072	1"	6.46	2.68	1.89	1.04	10
14073	1-1/4"	8.35	3.52	2.50	1.37	10
14074	1-1/2"	8.35	3.52	2.50	1.60	10
14075	2"	10.55	4.27	3.41	2.06	10
14076	2-1/2"	13.46	5.89	3.98	2.46	1
14077	3"	13.46	5.89	4.53	3.06	1
14078	3-1/2"	16.30	7.66	5.60	3.54	1
14079	4"	16.30	7.66	5.60	4.02	1

Aluminum Rigid Conduit Bodies LB Type - Threaded

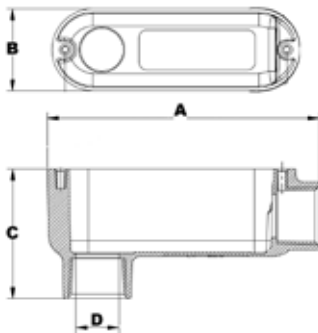

- Tapered Threaded Hubs (NPT)
- RainTight when used with Gasketed Covers
- Die-Cast from High-Strength, Corrosion and Weather Resistant Copper Free Aluminum Alloy
- Flat Back Design for easy mounting close to walls

To Provide Access to Conductors for Pulling, Splicing, and Maintenance. Threaded for Rigid & IMC Conduit

DIMENSIONS = INCHES

CAT. NO.	TRADE SIZE	DIMENSIONS - LB SERIES				BOX QTY
		A	B	C	D	
14040	1/2"	4.31	1.34	2.09	.61	50
14041	3/4"	5.08	1.56	2.39	.81	50
14042	1"	5.92	1.82	2.78	1.04	25
14043	1-1/4"	7.82	2.51	3.52	1.37	10
14044	1-1/2"	7.82	2.51	3.52	1.60	10
14045	2"	10.05	3.19	4.51	2.06	10
14046	2-1/2"	12.83	4.49	5.31	2.46	1
14047	3"	12.83	4.49	5.91	3.06	1
14048	3-1/2"	15.65	5.55	7.09	3.54	1
14049	4"	15.65	5.55	7.09	4.02	1
WITH COVER AND GASKET						
14050	1/2"	4.31	1.34	2.09	.61	50
14051	3/4"	5.08	1.56	2.39	.81	50
14052	1"	5.92	1.82	2.78	1.04	25
14053	1-1/4"	7.82	2.51	3.52	1.37	10
14054	1-1/2"	7.82	2.51	3.52	1.60	10
14055	2"	10.05	3.19	4.51	2.06	10
14056	2-1/2"	12.83	4.49	5.31	2.46	1
14057	3"	12.83	4.49	5.91	3.06	1
14058	3-1/2"	15.65	5.55	7.09	3.54	1
14059	4"	15.65	5.55	7.09	4.02	1



Aluminum Rigid Conduit Bodies LR Type - Threaded



To Provide Access to Conductors for Pulling, Splicing, and Maintenance. Threaded for Rigid & IMC Conduit

DIMENSIONS = INCHES

CAT. NO.	TRADE SIZE	DIMENSIONS-LR SERIES				BOX QTY
		A	B	C	D	
I4080	1/2"	4.31	2.03	1.36	.61	50
I4081	3/4"	5.08	2.30	1.63	.81	50
I4082	1"	5.92	2.68	1.89	1.04	25
I4083	1-1/4"	7.82	3.52	2.50	1.37	10
I4084	1-1/2"	7.82	3.52	2.50	1.60	10
I4085	2"	10.05	4.27	3.41	2.06	10
I4086	2-1/2"	12.83	5.89	3.98	2.46	1
I4087	3"	12.83	5.89	4.53	3.06	1
I4088	3-1/2"	15.65	7.66	5.59	3.54	1
I4089	4"	15.65	7.66	5.59	4.02	1
WITH COVER AND GASKET						
I4090	1/2"	4.31	2.03	1.36	.61	50
I4091	3/4"	5.08	2.30	1.63	.81	50
I4092	1"	5.92	2.68	1.89	1.04	25
I4093	1-1/4"	7.82	3.52	2.50	1.37	10
I4094	1-1/2"	7.82	3.52	2.50	1.60	10
I4095	2"	10.05	4.27	3.41	2.06	10
I4096	2-1/2"	12.83	5.89	3.98	2.46	1
I4097	3"	12.83	5.89	4.53	3.06	1
I4098	3-1/2"	15.65	7.66	5.59	3.54	1
I4099	4"	15.65	7.66	5.59	4.02	1

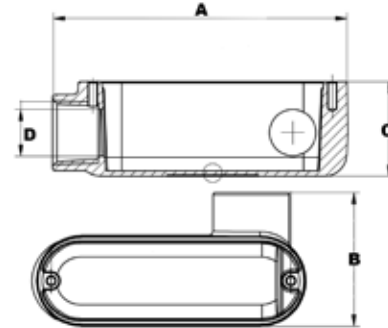

- Tapered Threaded Hubs (NPT)
- RainTight when used with Gasketed Covers
- Die-Cast from High-Strength, Corrosion and Weather Resistant, Copper Free Aluminum Alloy
- Flat Back Design for easy mounting close to walls

Conduit Bodies



Aluminum Rigid Conduit Bodies LL Type - Threaded

To Provide Access to Conductors for Pulling, Splicing, and Maintenance. Threaded for Rigid & IMC Conduit

DIMENSIONS = INCHES

CAT. NO.	TRADE SIZE	DIMENSIONS-LL SERIES				BOX QTY
		A	B	C	D	
I4100	1/2"	4.31	2.03	1.36	.61	50
I4101	3/4"	5.08	2.30	1.63	.81	50
I4102	1"	5.92	2.68	1.89	1.04	25
I4103	1-1/4"	7.82	3.52	2.50	1.37	10
I4104	1-1/2"	7.82	3.52	2.50	1.60	10
I4105	2"	10.05	4.27	3.41	2.06	10
I4106	2-1/2"	12.83	5.89	3.98	2.46	1
I4107	3"	12.83	5.89	4.53	3.06	1
I4108	3-1/2"	15.65	7.66	5.59	3.54	1
I4109	4"	15.65	7.66	5.59	4.02	1
WITH COVER AND GASKET						
I4110	1/2"	4.31	2.03	1.36	.61	50
I4111	3/4"	5.08	2.30	1.63	.81	50
I4112	1"	5.92	2.68	1.89	1.04	25
I4113	1-1/4"	7.82	3.52	2.50	1.37	10
I4114	1-1/2"	7.82	3.52	2.50	1.60	10
I4115	2"	10.05	4.27	3.41	2.06	10
I4116	2-1/2"	12.83	5.89	3.98	2.46	1
I4117	3"	12.83	5.89	4.53	3.06	1
I4118	3-1/2"	15.65	7.66	5.59	3.54	1
I4119	4"	15.65	7.66	5.59	4.02	1

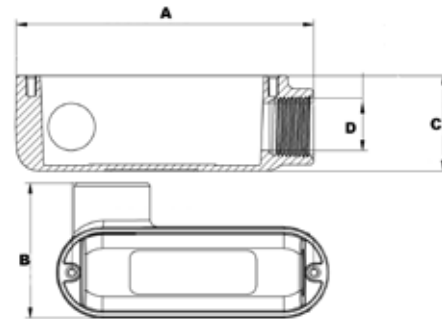

- Tapered Threaded Hubs (NPT)
- RainTight when used with Gasketed Covers
- Die-Cast from High-Strength, Corrosion and Weather Resistant, Copper Free Aluminum Alloy
- Flat Back Design for easy mounting close to walls



Aluminum Rigid Conduit Bodies C Type-Threaded



Conduit Bodies

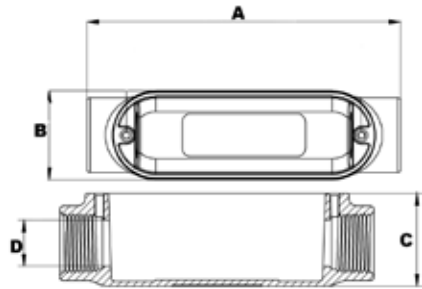

- Tapered Threaded Hubs (NPT)
- RainTight when used with Gasketed Covers
- Die-Cast from High-Strength, Corrosion and Weather Resistant, Copper Free Aluminum Alloy
- Flat Back Design for easy mounting close to walls

To Provide Access to Conductors for Pulling, Splicing, and Maintenance. Threaded for Rigid & IMC Conduit

DIMENSIONS = INCHES

CAT. NO.	TRADE SIZE	DIMENSIONS-C SERIES				BOX QTY
		A	B	C	D	
14120	1/2"	4.72	1.34	1.36	.61	50
14121	3/4"	5.51	1.56	1.63	.81	50
14122	1"	6.46	1.82	1.89	1.04	25
14123	1-1/4"	8.35	2.51	2.50	1.37	10
14124	1-1/2"	8.35	2.51	2.50	1.60	10
14125	2"	10.55	3.19	3.41	2.06	10
14126	2-1/2"	13.46	4.49	3.98	2.46	1
14127	3"	13.46	4.49	4.53	3.06	1
14128	3-1/2"	16.30	5.55	5.59	3.54	1
14129	4"	16.30	5.55	5.59	4.02	1
WITH COVER AND GASKET						
14130	1/2"	4.72	1.34	1.36	.61	50
14131	3/4"	5.51	1.56	1.63	.81	50
14132	1"	6.46	1.82	1.89	1.04	10
14133	1-1/4"	8.35	2.51	2.50	1.37	10
14134	1-1/2"	8.35	2.51	2.50	1.60	10
14135	2"	10.55	3.19	3.41	2.06	10
14136	2-1/2"	13.46	4.49	3.98	2.46	1
14137	3"	13.46	4.49	4.53	3.06	1
14138	3-1/2"	16.30	5.55	5.59	3.54	1
14139	4"	16.30	5.55	5.59	4.02	1

Aluminum Mogul Conduit Bodies with Cover & Gasket

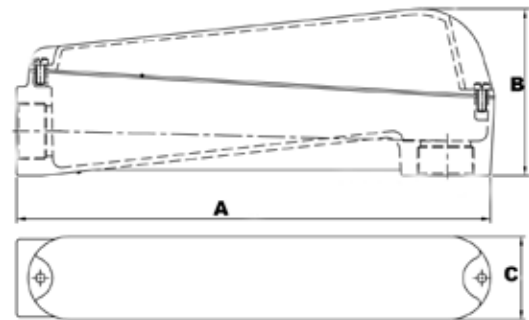

- Larger body size facilitates pulling of large and heavy conductors
- Specially designed raised cast covers provide additional wiring area
- Moguls are used for pulling straight, 45° or 90° angle turns and/or making taps and splices
- Exclusive built-in rollers facilitate cable pulling
- Smooth, rounded integral bushing in each hub protects conductor insulation
- Accurately tapped, tapered threads for tight, rigid joints and ground continuity
- Covers have captive stainless steel screws to speed installation, prevent 'freezing' of screws
- Includes cellulose/rubber Flex Sealing Gasket
- Length Requirement: distance between centerline of each hub bushing (conduit stop) exceeds six times the trade diameter of the conduit

WITH COVER & GASKET

DIMENSIONS = INCHES

CAT. NO.	TRADE SIZE	DIMENSIONS			WIRESIZE	BOX QTY
		A	B	C		
14300	1-1/4"	9.65	3.54	2.50	3 #1/0 AWG	2
14301	1-1/2"	14.53	5.41	3.13	3 #3/0 AWG	1
14302	2"	14.53	5.41	3.13	3 #300 MCM	1
14303	2-1/2"	22.01	7.54	4.53	3 #400 MCM	1
14304	3"	22.01	7.54	4.53	3 #700 MCM	1
14305	3-1/2"	28.84	8.94	5.51	3 #900 MCM	1
14306	4"	28.84	8.94	5.51	3 #1000 MCM	1



Aluminum EMT Set Screw Conduit Bodies T Type



To Provide Access to Conductors for Pulling, Splicing, and Maintenance. For EMT Conduit

- Set Screw for EMT Conduit
- RainTight when used with Gasketed Covers
- Die-Cast from High-Strength, Corrosion and Weather Resistant Copper Free Aluminum Alloy
- Flat Back Design for easy mounting close to walls

DIMENSIONS = INCHES

CAT. NO.	TRADE SIZE	DIMENSIONS-T SERIES				BOX QTY
		A	B	C	D	
14160	1/2"	4.75	2.03	1.36	.72	50
14161	3/4"	5.51	2.30	1.63	.96	50
14162	1"	6.46	2.68	1.89	1.18	25
14163	1-1/4"	8.35	3.52	2.50	1.53	10
14164	1-1/2"	8.36	3.52	2.50	1.76	10
14165	2"	10.55	4.27	3.41	2.21	10
WITH COVER AND GASKET						
14170	1/2"	4.75	2.03	1.36	.72	50
14171	3/4"	5.51	2.30	1.63	.96	50
14172	1"	6.46	2.68	1.89	1.18	25
14173	1-1/4"	8.35	3.52	2.50	1.53	10
14174	1-1/2"	8.36	3.52	2.50	1.76	10
14175	2"	10.55	4.27	3.41	2.21	10

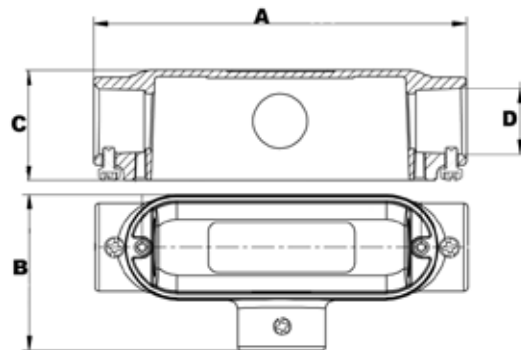

Conduit Bodies



Aluminum EMT Set Screw Conduit Bodies LB Type

To Provide Access to Conductors for Pulling, Splicing, and Maintenance. For EMT Conduit

- Set Screw for EMT Conduit
- RainTight when used with Gasketed Covers
- Die-Cast from High-Strength, Corrosion and Weather Resistant Copper Free Aluminum Alloy
- Flat Back Design for easy mounting close to walls

DIMENSIONS = INCHES

CAT. NO.	TRADE SIZE	DIMENSIONS-LB SERIES				BOX QTY
		A	B	C	D	
14140	1/2"	4.31	1.34	2.09	.72	50
14141	3/4"	5.08	1.56	2.39	.96	50
14142	1"	5.92	1.82	2.78	1.18	25
14143	1-1/4"	7.82	2.51	3.52	1.53	10
14144	1-1/2"	7.82	2.51	3.52	1.76	10
14145	2"	10.05	3.19	4.51	2.21	10
WITH COVER AND GASKET						
14150	1/2"	4.31	1.34	2.09	.72	50
14151	3/4"	5.08	1.56	2.39	.96	50
14152	1"	5.92	1.82	2.78	1.18	25
14153	1-1/4"	7.82	2.51	3.52	1.53	10
14154	1-1/2"	7.82	2.51	3.52	1.76	10
14155	2"	10.05	3.19	4.51	2.21	10

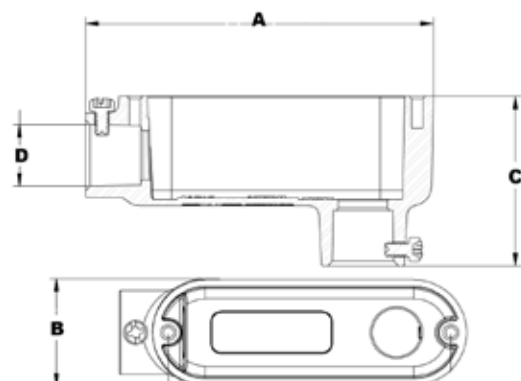



Aluminum EMT Set Screw Conduit Bodies LR Type



Conduit Bodies



To Provide Access to Conductors for Pulling, Splicing, and Maintenance. For EMT Conduit

- Set Screw for EMT Conduit
- RainTight when used with Gasketed Covers
- Die-Cast from High-Strength, Corrosion and Weather Resistant Copper Free Aluminum Alloy
- Flat Back Design for easy mounting close to walls

DIMENSIONS = INCHES

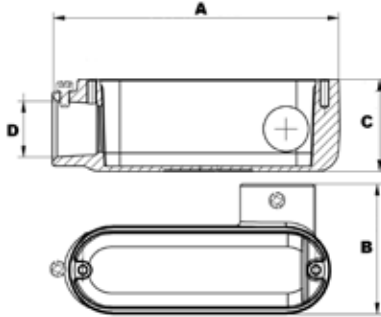

CAT. NO.	TRADE SIZE	DIMENSIONS-LR SERIES				BOX QTY
		A	B	C	D	
14180	1/2"	4.31	2.03	1.36	.72	50
14181	3/4"	5.08	2.30	1.63	.96	50
14182	1"	5.92	2.68	1.89	1.18	25
14183	1-1/4"	7.82	3.52	2.50	1.52	10
14184	1-1/2"	7.82	3.52	2.50	1.76	10
14185	2"	10.05	4.27	3.41	2.21	10
WITH COVER AND GASKET						
14190	1/2"	4.31	2.03	1.36	.72	50
14191	3/4"	5.08	2.30	1.63	.96	50
14192	1"	5.92	2.68	1.89	1.18	25
14193	1-1/4"	7.82	3.52	2.50	1.52	10
14194	1-1/2"	7.82	3.52	2.50	1.76	10
14195	2"	10.05	4.27	3.41	2.21	10

Aluminum EMT Set Screw Conduit Bodies LL Type



To Provide Access to Conductors for Pulling, Splicing, and Maintenance. For EMT Conduit

- Set Screw for EMT Conduit
- RainTight when used with Gasketed Covers
- Die-Cast from High-Strength, Corrosion and Weather Resistant Copper Free Aluminum Alloy
- Flat Back Design for easy mounting close to walls

DIMENSIONS = INCHES

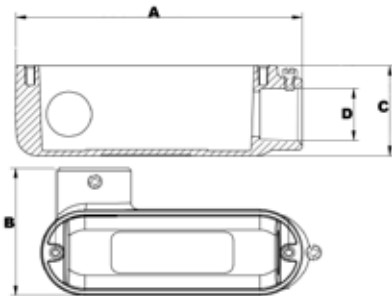

CAT. NO.	TRADE SIZE	DIMENSIONS-LL SERIES				BOX QTY
		A	B	C	D	
14200	1/2"	4.31	2.03	1.36	.72	50
14201	3/4"	5.08	2.30	1.63	.96	50
14202	1"	5.92	2.68	1.89	1.18	25
14203	1-1/4"	7.82	3.52	2.50	1.52	10
14204	1-1/2"	7.82	3.52	2.50	1.76	10
14205	2"	10.05	4.27	3.41	2.21	10
WITH COVER AND GASKET						
14210	1/2"	4.31	2.03	1.36	.72	50
14211	3/4"	5.08	2.30	1.63	.96	50
14212	1"	5.92	2.68	1.89	1.18	25
14213	1-1/4"	7.82	3.52	2.50	1.52	10
14214	1-1/2"	7.82	3.52	2.50	1.76	10
14215	2"	10.05	4.27	3.41	2.21	10



Aluminum EMT Set Screw Conduit Bodies Type C



To Provide Access to Conductors for Pulling, Splicing, and Maintenance. For EMT Conduit

- Set Screw for EMT Conduit
- RainTight when used with Gasketed Covers
- Die-Cast from High-Strength, Corrosion and Weather Resistant Copper Free Aluminum Alloy
- Flat Back Design for easy mounting close to walls



DIMENSIONS = INCHES

CAT. NO.	TRADE SIZE	DIMENSIONS-C SERIES				BOX QTY
		A	B	C	D	
I4220	1/2"	4.72	1.34	1.36	.72	50
I4221	3/4"	5.51	1.56	1.63	.96	50
I4222	1"	6.46	1.82	1.89	1.18	25
I4223	1-1/4"	8.35	2.51	2.50	1.52	10
I4224	1-1/2"	8.35	2.51	2.50	1.76	10
I4225	2"	10.55	3.19	3.41	2.21	10
WITH COVER AND GASKET						
I4230	1/2"	4.72	1.34	1.36	.72	50
I4231	3/4"	5.51	1.56	1.63	.96	50
I4232	1"	6.46	1.82	1.89	1.18	25
I4233	1-1/4"	8.35	2.51	2.50	1.52	10
I4234	1-1/2"	8.35	2.51	2.50	1.76	10
I4235	2"	10.55	3.19	3.41	2.21	10

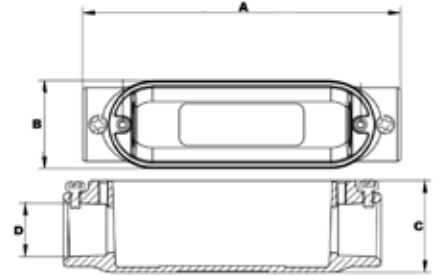

Conduit Bodies

Trade Size in Inches		Wire Size (THWN, THHN) Conductor Size AWG/kcmil																				
		14	12	10	8	6	4	3	2	1	1/0	2/0	3/0	4/0	250	300	350	400	500	600	700	750
1/2	EMT	12	9	5	3	2	1	1	1	1	1	--	--	--	--	--	--	--	--	--	--	--
	IMC	14	10	6	3	2	1	1	1	1	1	1	--	--	--	--	--	--	--	--	--	--
	GALV	13	9	6	3	2	1	1	1	1	1	1	--	--	--	--	--	--	--	--	--	--
3/4	EMT	22	16	10	6	4	2	1	1	1	1	1	1	1	--	--	--	--	--	--	--	--
	IMC	24	17	11	6	4	3	2	1	1	1	1	1	1	--	--	--	--	--	--	--	--
	GALV	22	16	10	6	4	2	1	1	1	1	1	1	1	--	--	--	--	--	--	--	--
1	EMT	35	26	16	9	7	4	3	3	1	1	1	1	1	1	1	1	--	--	--	--	--
	IMC	39	29	18	10	7	4	4	3	2	1	1	1	1	1	1	1	1	--	--	--	--
	GALV	36	26	17	9	7	4	3	3	1	1	1	1	1	1	1	1	1	--	--	--	--
1-1/4	EMT	61	45	28	16	12	7	6	5	4	3	2	1	1	1	1	1	1	1	1	1	--
	IMC	68	49	31	18	13	8	6	5	4	3	2	1	1	1	1	1	1	1	1	1	1
	GALV	63	46	29	16	12	7	6	5	4	3	2	1	1	1	1	1	1	1	1	1	--
1-1/2	EMT	84	61	38	22	16	10	8	7	5	4	3	2	1	1	1	1	1	1	1	1	1
	IMC	91	67	42	24	17	10	9	7	5	4	3	2	1	1	1	1	1	1	1	1	1
	GALV	85	62	39	22	16	10	8	7	5	4	3	2	1	1	1	1	1	1	1	1	1
Trade Size in Inches		Wire Size (THWN, THHN) Conductor Size AWG/kcmil																				
		14	12	10	8	6	4	3	2	1	1/0	2/0	3/0	4/0	250	300	350	400	500	600	700	750
2	EMT	138	101	63	36	26	16	13	11	8	7	6	5	4	3	2	1	1	1	1	1	1
	IMC	149	109	68	39	38	17	15	12	9	8	6	5	4	3	2	2	1	1	1	1	1
	GALV	140	102	64	37	27	16	14	11	8	7	6	5	4	3	3	2	2	1	1	1	1
2-1/2	EMT	241	176	111	64	46	28	24	20	15	12	10	8	7	6	5	4	4	3	2	2	1
	IMC	211	154	97	56	40	25	21	17	13	11	9	7	6	5	4	4	3	3	2	1	1
	GALV	200	146	92	53	38	23	20	17	12	10	8	7	6	5	4	3	3	2	1	1	1
3	EMT	364	226	167	96	69	43	36	30	22	19	16	13	11	9	7	6	6	5	4	3	3
	IMC	362	238	150	86	62	38	32	27	20	17	14	12	9	8	7	6	5	4	3	3	3
	GALV	309	225	142	82	59	36	31	26	19	16	13	11	9	7	6	5	5	4	3	3	3
3-1/2	EMT	476	347	219	126	91	56	47	40	29	25	20	17	14	11	10	9	8	6	5	4	4
	IMC	436	318	200	115	83	51	43	36	27	23	19	16	13	10	9	8	7	6	5	4	4
	GALV	412	301	189	109	79	48	41	34	25	21	18	15	12	10	8	7	7	5	4	4	4
4	EMT	608	443	279	161	116	71	60	51	37	32	26	22	18	15	13	11	10	8	7	6	5
	IMC	562	410	258	149	107	66	56	47	35	29	24	20	17	13	12	10	9	7	6	5	5
	GALV	531	387	244	140	101	62	53	44	33	27	23	19	16	13	11	10	8	7	6	5	5

Above information referenced from tables C1, C4, and C8 in the National Electric Code of 2008. For more information on the following types of conduit, please see the table listed below in the appendix C of the National Electric Code of 2008.
 Rigid PVC Conduit, Schedule 80 -- Table C9
 Rigid PVC Conduit, Schedule 40 -- Table C10
 Flexible Metallic Conduit -- Table C3
 Liquidtight Flexible Metallic Conduit -- Table C7
 Liquidtight Flexible Nonmetallic Conduit (Type FNM-C) -- Table C5
 If you have any other questions see the NEC Code Book.



Aluminum Combination Conduit Bodies T Type



Conduit Bodies



To Provide Access to Conductors for Pulling, Splicing, and Maintenance. For Rigid, IMC & EMT Conduit

- Threaded for Rigid & IMC Conduits
- Set Screw for EMT Conduit
- RainTight when used with Gasketed Covers
- Die-Cast from High-Strength, Corrosion and Weather Resistant Copper Free Aluminum Alloy
- Flat Back Design for easy mounting close to walls

DIMENSIONS = INCHES

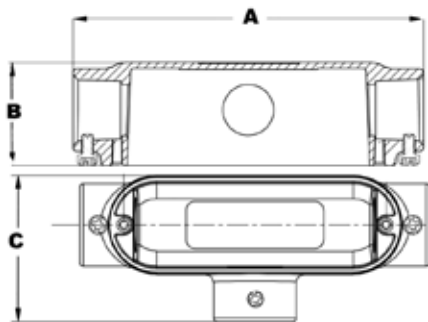

CAT. NO.	TRADE SIZE	DIMENSIONS-T SERIES			BOX QTY
		A	B	C	
I4252	1/2"	4.72	1.36	2.03	50
I4253	3/4"	5.51	1.63	2.30	50
I4254	1"	6.46	1.89	2.68	25
I4255	1-1/4"	8.35	2.50	3.52	10
I4256	1-1/2"	8.35	2.50	3.52	10
I4257	2"	10.55	3.41	4.27	10
WITH COVER AND GASKET					
I4258	1/2"	4.72	1.36	2.03	50
I4259	3/4"	5.51	1.63	2.30	50
I4260	1"	6.46	1.89	2.68	25
I4261	1-1/4"	8.35	2.50	3.52	10
I4262	1-1/2"	8.35	2.50	3.52	10
I4263	2"	10.55	3.41	4.27	10

Aluminum Combination Conduit Bodies LB Type



To Provide Access to Conductors for Pulling, Splicing, and Maintenance. For Rigid, IMC & EMT Conduit

- Threaded for Rigid & IMC Conduits
- Set Screw for EMT Conduit
- RainTight when used with Gasketed Covers
- Die-Cast from High-Strength, Corrosion and Weather Resistant Copper Free Aluminum Alloy
- Flat Back Design for easy mounting close to walls

DIMENSIONS = INCHES

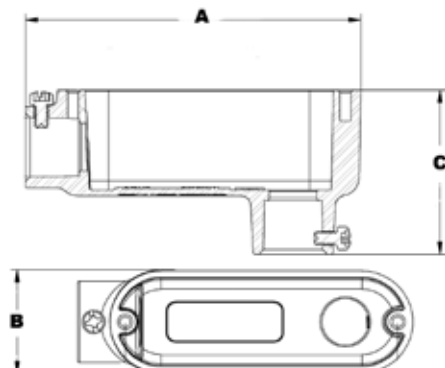

CAT. NO.	TRADE SIZE	DIMENSIONS-LB SERIES			BOX QTY
		A	B	C	
I4240	1/2"	4.31	1.34	2.09	50
I4241	3/4"	5.08	1.56	2.39	50
I4242	1"	5.92	1.82	2.78	25
I4243	1-1/4"	7.82	2.51	3.52	10
I4244	1-1/2"	7.82	2.51	3.52	10
I4245	2"	10.05	3.19	4.51	10
WITH COVER AND GASKET					
I4246	1/2"	4.31	1.34	2.09	50
I4247	3/4"	5.08	1.56	2.39	50
I4248	1"	5.92	1.82	2.78	25
I4249	1-1/4"	7.82	2.51	3.52	10
I4250	1-1/2"	7.82	2.51	3.52	10
I4251	2"	10.05	3.19	4.51	10



Aluminum Combination Conduit Bodies LR Type



To Provide Access to Conductors for Pulling, Splicing, and Maintenance. For Rigid, IMC & EMT Conduit

- Threaded for Rigid & IMC Conduits
- Set Screw for EMT Conduit
- RainTight when used with Gasketed Covers
- Die-Cast from High-Strength, Corrosion and Weather Resistant Copper Free Aluminum Alloy
- Flat Back Design for easy mounting close to walls

DIMENSIONS = INCHES

CAT. NO.	TRADE SIZE	DIMENSIONS-LR SERIES			BOX QTY
		A	B	C	
I4264	1/2"	4.31	2.03	1.36	50
I4265	3/4"	5.08	2.30	1.63	50
I4266	1"	5.92	2.68	1.89	25
I4267	1-1/4"	7.82	3.52	2.50	10
I4268	1-1/2"	7.82	3.52	2.50	10
I4269	2"	10.05	4.27	3.41	10
WITH COVER AND GASKET					
I4270	1/2"	4.31	2.03	1.36	50
I4271	3/4"	5.08	2.30	1.63	50
I4272	1"	5.92	2.68	1.89	25
I4273	1-1/4"	7.82	3.52	2.50	10
I4274	1-1/2"	7.82	3.52	2.50	10
I4275	2"	10.05	4.27	3.41	10

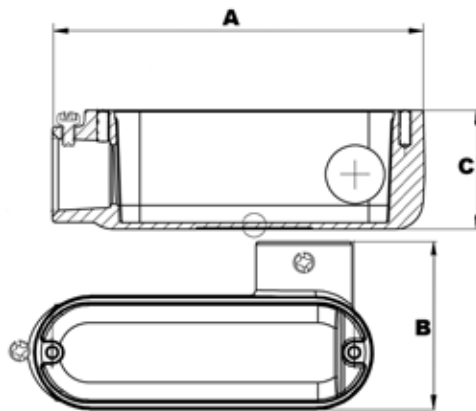

Aluminum Combination Conduit Bodies LL Type

To Provide Access to Conductors for Pulling, Splicing, and Maintenance. For Rigid, IMC & EMT Conduit

- Threaded for Rigid & IMC Conduits
- Set Screw for EMT Conduit
- RainTight when used with Gasketed Covers
- Die-Cast from High-Strength, Corrosion and Weather Resistant Copper Free Aluminum Alloy
- Flat Back Design for easy mounting close to walls

DIMENSIONS = INCHES

CAT. NO.	TRADE SIZE	DIMENSIONS-LL SERIES			BOX QTY
		A	B	C	
I4276	1/2"	4.31	2.03	1.36	50
I4277	3/4"	5.08	2.30	1.63	50
I4278	1"	5.92	2.68	1.89	25
I4279	1-1/4"	7.82	3.52	2.50	10
I4280	1-1/2"	7.82	3.52	2.50	10
I4281	2"	10.05	4.27	3.41	10
WITH COVER AND GASKET					
I4282	1/2"	4.31	2.03	1.36	50
I4283	3/4"	5.08	2.30	1.63	50
I4284	1"	5.92	2.68	1.89	25
I4285	1-1/4"	7.82	3.52	2.50	10
I4286	1-1/2"	7.82	3.52	2.50	10
I4287	2"	10.05	4.27	3.41	10

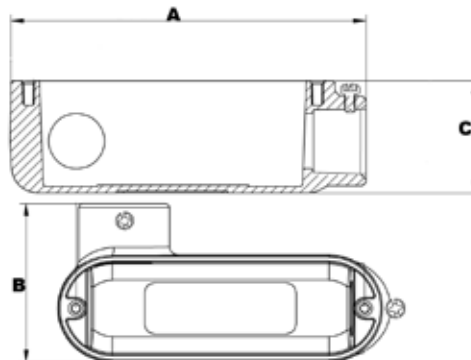



Aluminum Combination Conduit Bodies C Type



Conduit Bodies



To Provide Access to Conductors for Pulling, Splicing, and Maintenance. For Rigid, IMC & EMT Conduit

- Threaded for Rigid & IMC Conduits
- Set Screw for EMT Conduit
- RainTight when used with Gasketed Covers
- Die-Cast from High-Strength, Corrosion and Weather Resistant Copper Free Aluminum Alloy
- Flat Back Design for easy mounting close to walls

DIMENSIONS = INCHES

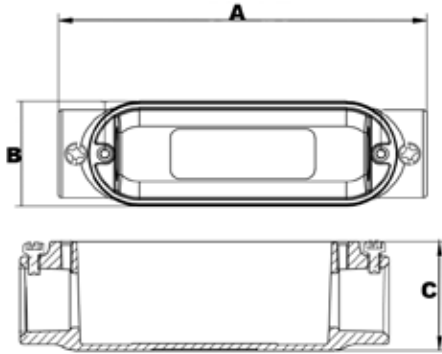

CAT. NO.	TRADE SIZE	DIMENSIONS-C SERIES			BOX QTY
		A	B	C	
14288	1/2"	4.72	1.34	1.36	50
14289	3/4"	5.51	1.56	1.63	50
14290	1"	6.46	1.82	1.89	25
14291	1-1/4"	8.35	2.51	2.50	10
14292	1-1/2"	8.35	2.51	2.50	10
14293	2"	10.55	3.19	3.41	10
WITH COVER AND GASKET					
14294	1/2"	4.72	1.34	1.36	50
14295	3/4"	5.51	1.56	1.63	50
14296	1"	6.46	1.82	1.89	25
14297	1-1/4"	8.35	2.51	2.50	10
14298	1-1/2"	8.35	2.51	2.50	10
14299	2"	10.55	3.19	3.41	10

Aluminum Service Entrance Condulets



- Tapered Threaded Hubs (NPT)
- Raintight with Gasketed covers
- Die Cast from High-Strength, Corrosion and Weather Resistant Copper Free Aluminum Alloy
- Flat Back Design for easy mounting close to walls

WITH GASKETED COVER

DIMENSIONS = INCHES

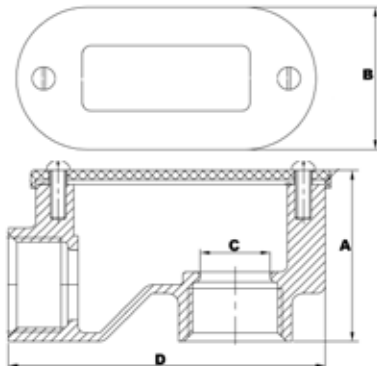

CAT. NO.	TRADE SIZE	DIMENSIONS				BOX QTY
		A	B	C	D	
14307	1/2"	1.59	1.38	.59	3.15	300
14308	3/4"	1.89	1.71	.78	3.58	50
14310	1-1/4"	2.05	1.93	1.00	4.17	50
14313*	1-1/4"	2.56	2.48	1.31	7.78	32
14314*	2"	3.68	3.13	1.99	10.10	12

*Extra Long



Steel Conduit Body Covers



- Used with Conduit Body to cover opening
- Assembled with captive zinc plated steel screws
- Raised Center to Accommodate Cable Bend Radius

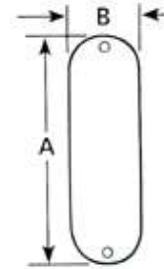

DIMENSIONS = INCHES

CAT. NO.	TRADE SIZE	DIMENSIONS		INNER BOX	OUTER BOX
		A	B		
I4002	1/2"	3.90	1.34	25	250
I4003	3/4"	4.67	1.54	25	200
I4004	1"	5.37	1.79	10	100
I4005	1-1/4" - 1-1/2"	7.28	2.50	-	50
I4006	2"	9.49	3.15	-	50
I4007	2-1/2" - 3"	12.21	4.53	-	20
I4008	3-1/2" - 4"	14.96	5.51	-	10



Aluminum Conduit Body Covers

- Used with Conduit Body to cover opening
- Stamped from high-strength corrosion and weather resistant copper-free aluminum alloy
- Assembled with captive zinc plated steel screws
- Raised Center to Accommodate Cable Bend Radius

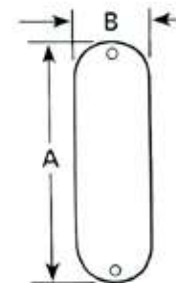

DIMENSIONS = INCHES

CAT. NO.	TRADE SIZE	DIMENSIONS		INNER BOX	OUTER BOX
		A	B		
I4010	1/2"	3.88	1.34	10	250
I4011	3/4"	4.67	1.56	10	250
I4012	1"	5.39	1.77	10	100
I4013	1-1/4" - 1-1/2"	7.28	2.50	10	50
I4014	2"	9.47	3.13	10	50
I4015	2-1/2" - 3"	12.21	4.53	-	25
I4016	3-1/2" - 4"	14.96	5.51	-	20

Neoprene Rubber Conduit Body Gasket

- Gasket used with Conduit Body for a rain tight seal
- Neoprene Rubber Material

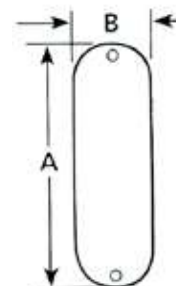

DIMENSIONS = INCHES

CAT. NO.	TRADE SIZE	DIMENSIONS		INNER BOX	OUTER BOX
		A	B		
I4030	1/2"	3.90	1.34	100	1,000
I4031	3/4"	4.67	1.54	100	1,000
I4032	1"	5.37	1.73	50	500
I4033	1-1/4" - 1-1/2"	7.28	2.50	50	500
I4034	2"	9.49	3.15	30	300
I4035	2-1/2" - 3"	12.21	4.53	10	100
I4036	3-1/2" - 4"	14.96	5.51	10	100



LiquidTite Flexible Conduit



T750-12100

- Type B Non-metallic liquidtight conduit
- For outside, inside and industrial uses
- Motor & Controls Installations
- HVAC Applications
- Power Distribution to Equipment
- Machine Tool Applications
- Transformer Terminations
- Outdoor lighting Applications
- Joins with metallic or non-metallic connectors
- 176° (80°C) Rated
- U.L. and C.U.L. Listed
- Non-conductive and non-corrosive
- Lightweight for easy handling, transportation, and installation
- Resistant to oil, acid, ozone, and alkaline
- Crush, abrasion, and strain resistant
- Smooth interior ideal for pulling cable
- Easy to cut into lengths, no jagged edges
- Maintains internal I.D. even in tight radius bends
- UL Listed for use as indicated in Article 351 of the 1987 NEC and Section 12-1300 of the 2002 Canadian Electrical Code, Part I.
- UL Listed for outdoor use
- UV resistant

CAT. NO.	DESCRIPTION	UOM	ORDER MULTIPLE
T750-12100	1/2" X 100' LIQUID TITE CONDUIT - NON-METALLIC, 100' PER ROLL	EA	1
T750-12100BOX	1/2" X 100' LIQUID TITE CONDUIT - NON-METALLIC, 100' PER ROLL IN BOX	EA	1
T750-121000*	1/2" X 1000' LIQUID TITE CONDUIT - NON-METALLIC, 1000' PER ROLL	EA	1
T750-34100	3/4" X 100' LIQUID TITE CONDUIT - NON-METALLIC, 100' PER ROLL	EA	1
T750-34800*	3/4" X 800' LIQUID TITE CONDUIT - NON-METALLIC, 800' PER ROLL	EA	1
T750-10100	1" X 100' LIQUID TITE CONDUIT - NON-METALLIC, 100' PER ROLL	EA	1
T750-10500*	1" X 500' LIQUID TITE CONDUIT - NON-METALLIC 500' PER ROLL	EA	1
T750-125100	1-1/4" X 100' LIQUID TITE CONDUIT - NON-METALLIC, 100' PER ROLL	EA	1
T750-1550	1-1/2" X 50' LIQUID TITE CONDUIT - NON-METALLIC, 50' PER ROLL	EA	1
T750-2050*	2" X 50' LIQUID TITE CONDUIT - NON-METALLIC, 50' PER ROLL	EA	1

* Must Ship LTL Freight; \$750 Order to qualify for freight allowed

DiversiWhips



T6-12-4

- Liquid tight flexible conduit system
- A labor saving convenience kit for A/C unit hookup
- Also use for heat pumps, refrigeration, hot tubs, swimming pools and outdoor lighting
- Three distinct wire colors for ease of hook up
- One (1) straight and one (1) 90° metallic or non-metallic connector
- 90° connector is removable for straight connections.
- (Second straight connector not included.)
- U.L. and C.U.L. Listed
- Bagged for Pegboard Display Hanging

CAT. NO.	DESCRIPTION	UOM	ORDER MULTIPLE
T6-12-4	1/2 X 4' #10 THHN WIRE - METALLIC CONNECTORS	EA	1
T6-12-6	1/2 X 6' #10 THHN WIRE - METALLIC CONNECTORS	EA	1
T6-34-4	3/4 X 4' #8 THHN WIRE - METALLIC CONNECTORS	EA	1
T6-34-6	3/4 X 6' #8 THHN WIRE - METALLIC CONNECTORS	EA	1
T6-12-4NM	1/2 X 4' #10 THHN WIRE - NON-METALLIC CONNECTORS	EA	1
T6-12-6NM	1/2 X 6' #10 THHN WIRE - NON-METALLIC CONNECTORS	EA	1
T6-34-4NM	3/4 X 4' #8 THHN WIRE - NON-METALLIC CONNECTORS	EA	1
T6-34-6NM	3/4 X 6' #8 THHN WIRE - NON-METALLIC CONNECTORS	EA	1

DiversiWhips Pallet Packs



TB6-12-4NM

- DiversiWhips are now available in a convenient, bulk packaged pallet pack at a discounted price
- (1) straight and (1) 90° non-metallic connector

CAT. NO.	DESCRIPTION	UOM	ORDER MULTIPLE
TB6-12-4NM*	1/2 X 4' #10 THHN WIRE - NON-METALLIC CONNECTORS	EA	90
TB6-12-6NM*	1/2 X 6' #10 THHN WIRE - NON-METALLIC CONNECTORS	EA	60
TB6-34-6NM*	3/4 X 6' #8 THHN WIRE - NON-METALLIC CONNECTORS	EA	45

* Must Ship LTL Freight; \$750 Order to qualify for freight allowed



LiquidTite Connectors - Straight - Zinc Die Cast



DIMENSIONS = INCHES

CAT. NO.	TRADE SIZE	DIMENSIONS			INNER BOX	OUTER BOX
		A	B	C		
15240	3/8"	1.46	1.20	0.48	25	250
15241	1/2"	1.46	1.20	0.56	25	250
15242	3/4"	1.46	1.46	0.71	15	150
15243	1"	1.87	1.69	0.94	8	80
15244	1-1/4"	2.06	2.17	1.24	5	50
15245	1-1/2"	2.07	2.44	1.45	4	40
15246	2"	2.01	2.87	1.86	2	20
15247	2-1/2"	3.33	3.39	2.22	-	12
15248	3"	3.50	4.09	2.76	-	12
15249	3-1/2"	4.05	4.90	3.05	-	6
15250	4"	4.09	5.04	3.62	-	6



- Terminate and Seal Liquid-tight Flexible Metal Core Conduit to either Oil-tight, Liquid-tight or Rain-tight Box or Enclosure
- Connectors can be used with Tapered Threaded Female Entry or Unthreaded KD using the Sealing Washer and Locknut



LiquidTite Connectors - Straight - Insulated - Zinc Die Cast

DIMENSIONS = INCHES

CAT. NO.	TRADE SIZE	DIMENSIONS			INNER BOX	OUTER BOX
		A	B	C		
15251	3/8"	1.52	1.20	0.48	25	250
15252	1/2"	1.52	1.20	0.56	25	250
15253	3/4"	1.52	1.46	0.71	15	150
15254	1"	1.93	1.69	0.94	8	80
15255	1-1/4"	2.08	2.17	1.24	5	50
15256	1-1/2"	2.15	2.44	1.45	4	40
15257	2"	2.08	2.87	1.86	2	20
15258	2-1/2"	3.41	3.39	2.22	-	10
15259	3"	3.58	4.09	2.76	-	10
15260	3-1/2"	4.07	4.86	3.33	-	6
15261	4"	4.17	5.04	3.62	-	6



- Terminate and Seal Liquid-tight Flexible Metal Core Conduit to either Oil-tight, Liquid-tight or Rain-tight Box or Enclosure
- Connector can be used with Tapered Threaded Female Entry or Unthreaded KD using the Sealing Washer and Locknut



90° LiquidTite Connectors - Zinc Die Cast

DIMENSIONS = INCHES

CAT. NO.	TRADE SIZE	DIMENSIONS			INNER BOX	OUTER BOX
		A	B	C		
15280	3/8"	0.49	1.26	2.04	15	150
15281	1/2"	0.56	1.26	2.10	15	150
15282	3/4"	0.71	1.52	2.36	10	100
15283	1"	0.94	1.77	2.93	5	50
15284	1-1/4"	1.24	2.20	3.34	4	40
15285	1-1/2"	1.45	2.46	3.74	2	20
15286	2"	1.86	2.93	4.21	1	10
15287	2-1/2"	2.22	3.54	5.31	-	6
15288	3"	2.76	4.25	6.47	-	4
15289	3-1/2"	3.54	4.86	6.47	-	3
15290	4"	3.62	5.24	6.90	-	3

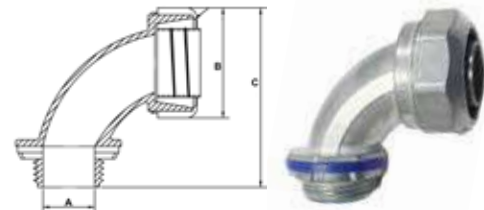

- 90° Orientation
- Terminate and Seal Liquid-tight Flexible Metal Core Conduit to either Oil-tight, Liquid-tight or Rain-tight Box or Enclosure
- Connectors can be used with Tapered Threaded Female Entry or Unthreaded KD using the Sealing Washer and Locknut



90° LiquidTite Connectors - Insulated Throat - Zinc Die Cast

DIMENSIONS = INCHES

CAT. NO.	TRADE SIZE	DIMENSIONS			INNER BOX	OUTER BOX
		A	B	C		
15291	3/8"	.48	1.26	2.09	15	150
15292	1/2"	.56	1.26	2.15	15	150
15293	3/4"	.71	1.52	2.69	10	100
15294	1"	.94	1.77	2.98	5	50
15295	1-1/4"	1.24	2.20	3.40	4	40
15296	1-1/2"	1.45	2.46	3.80	2	20
15297	2"	1.86	2.93	4.27	1	10
15298	2-1/2"	2.22	3.54	5.39	-	6
15299	3"	2.76	4.25	6.13	-	4
15300	3-1/2"	3.33	4.86	6.55	-	3
15301	4"	3.62	5.24	6.98	-	3

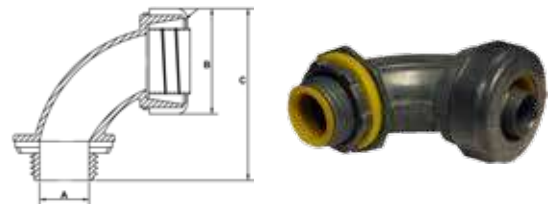

- 90° Orientation
- Terminate and Seal Liquid-tight Flexible Metal Core Conduit to either Oil-tight, Liquid-tight or Rain-tight Box or Enclosure
- Connectors can be used with Tapered Threaded Female Entry or Unthreaded Knockout using the Sealing Washer and Locknut provided



LiquidTite Connectors - Straight - Insulated Throat - Malleable Iron

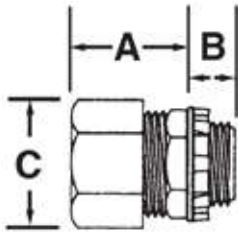

- Terminate and Seal Liquid-tight Flexible Metal Core Conduit to either Oil-tight, Liquid-tight or Rain-tight Box or Enclosure
- Connectors can be used with Tapered Threaded Female Entry or Unthreaded KO using the Sealing Washer and Locknut



DIMENSIONS = INCHES

CAT. NO.	TRADE SIZE	DIMENSIONS			INNER BOX	OUTER BOX
		A	B	C		
15161	1/2"	0.91	0.55	1.30	25	250
15162	3/4"	0.98	0.59	1.50	10	100
15163	1"	1.14	0.63	1.81	5	50
15164	1-1/4"	1.22	0.67	2.20	5	50
15165	1-1/2"	1.30	0.43	2.44	10	50
15166	2"	1.50	0.73	2.95	5	25

LiquidTite

NEW

LiquidTite Connectors - 90° - Insulated Throat - Malleable Iron

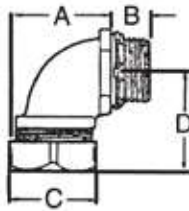

- Terminate and Seal Liquid-tight Flexible Metal Core Conduit to either Oil-tight, Liquid-tight or Rain-tight Box or Enclosure
- Connector can be used with Tapered Threaded Female Entry or Unthreaded KO using the Sealing Washer and Locknut



DIMENSIONS = INCHES

CAT. NO.	TRADE SIZE	DIMENSIONS				INNER BOX	OUTER BOX
		A	B	C	D		
15181	1/2"	1.42	0.55	1.30	1.76	10	100
15182	3/4"	1.73	0.59	1.50	2.01	10	100
15183	1"	2.01	0.65	1.81	2.13	5	50
15184	1-1/4"	2.30	0.67	2.20	2.32	-	10
15185	1-1/2"	2.62	0.71	2.44	2.60	-	10
15186	2"	2.99	0.73	2.95	3.03	-	5

LiquidTite Connectors - 45° - Insulated Throat - Malleable Iron

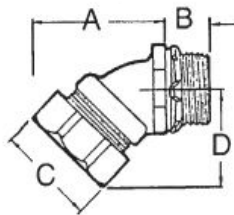

- Terminate and Seal Liquid-tight Flexible Metal Core Conduit to either Oil-tight, Liquid-tight or Rain-tight Box or Enclosure
- Connectors can be used with Tapered Threaded Female Entry or Unthreaded KO using the Sealing Washer and Locknut



DIMENSIONS = INCHES

CAT. NO.	TRADE SIZE	DIMENSIONS				INNER BOX	OUTER BOX
		A	B	C	D		
15221	1/2"	1.89	0.55	1.30	1.34	10	100
15222	3/4"	1.97	0.59	1.50	1.57	10	100
15223	1"	2.60	0.65	1.81	1.81	5	50
15224	1-1/4"	2.76	0.67	2.20	2.09	-	10
15225	1-1/2"	3.11	0.71	2.44	2.36	-	10
15226	2"	3.66	0.73	2.95	2.64	-	5

LiquidTite Connectors - Straight - Insulated Throat - Steel

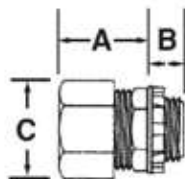

- Terminate and Seal Liquid-tight Flexible Metal Core Conduit to either Oil-tight, Liquid-tight or Rain-tight Box or Enclosure
- Connectors can be used with Tapered Threaded Female Entry or Unthreaded Knockout using the Sealing Washer and Locknut provided



DIMENSIONS = INCHES

CAT. NO.	TRADE SIZE	DIMENSIONS			INNER BOX	OUTER BOX
		A	B	C		
15201	1/2"	0.91	0.47	1.12	25	250
15202	3/4"	1.02	0.53	1.37	10	100
15203	1"	1.12	0.65	1.70	5	50
15204	1-1/4"	1.26	0.67	2.07	5	50
15205	1-1/2"	1.46	0.69	2.30	10	50
15206	2"	1.50	0.73	2.80	5	25



- For use with metallic and non metallic liquid tite conduit, Type B
- Provides smooth connection
- No sharp edges to damage wir.
- Wire easily pulled through
- U. L. Listed, C.U.L. Listed.

CAT. NO.	DESCRIPTION	UOM	ORDER MULTIPLE
	NON-METALLIC	EA	1
T750-NMLT50	1/2" NON-METALLIC STRAIGHT CONNECTOR	EA	1
T750-NMLT75	3/4" NON-METALLIC STRAIGHT CONNECTOR	EA	1
T750-NMLT9050	1/2" NON-METALLIC 90 DEGREE ELBOW CONNECTOR	EA	1
T750-NMLT9075	3/4" NON-METALLIC 90 DEGREE ELBOW CONNECTOR	EA	1



T750-NMLT50



T750-NMLT9050

Single Piece LiquidTite Fittings



- Conduit threads onto ferrule and up inside the outer body
- Inside taper squeezes down on conduit for superior liquid tight seal
 - Cut portion of conduit does not show, giving a more finished appearance
 - Easy to use at a lower cost than regular liquid tite fittings
 - U.L. and C.U.L. Listed

DIMENSIONS = INCHES

CAT. NO.	DESCRIPTION	UOM	ORDER MULTIPLE
T750-SLTC50	1/2" STRAIGHT SCREW-ON FITTING	EA	1
T750-SLTC9050	1/2" 90° SCREW-ON FITTING	EA	1
T750-SLTC75	3/4" STRAIGHT SCREW-ON FITTING	EA	1
T750-SLTC9075	3/4" 90° SCREW-ON FITTING	EA	1



T750-SLTC50



T750-SLTC9050



Non-Metallic LiquidTite Connectors - Straight

- Terminate and Seal Non-Metallic Liquid-tight Conduit
- Nylon Construction with Zinc Die-Cast Locknut
- UV Resistant

DIMENSIONS = INCHES

CAT. NO.	TRADE SIZE	DIMENSIONS			INNER BOX	OUTER BOX
		A	B	C		
21813	1/2"	1.18	0.55	1.42	25	150
21814	3/4"	1.20	0.64	1.69	10	100
21815	1"	1.23	0.72	2.02	5	50
21816	1-1/4"	2.44	0.76	2.40	5	50
21817	1-1/2"	2.70	0.80	2.67	4	40
21818	2"	2.99	0.85	3.28	2	20

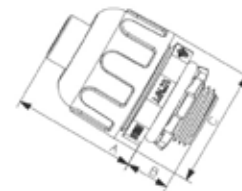

Non-Metallic LiquidTite Connectors - 90°

- 90° Orientation
- Terminate and Seal Non-Metallic liquid-tight Conduit
- Nylon Construction with Zinc Die-Cast Locknut
- UV Resistant

DIMENSIONS = INCHES

CAT. NO.	TRADE SIZE	DIMENSIONS			INNER BOX	OUTER BOX
		A	B	C		
21823	1/2"	2.84	0.50	2.03	25	150
21824	3/4"	3.25	0.50	2.33	10	100
21825	1"	3.54	0.60	2.95	5	50
21826	1-1/4"	4.75	0.76	5.20	3	30
21827	1-1/2"	4.75	0.80	5.20	2	20
21828	2"	5.42	0.86	5.80	1	10

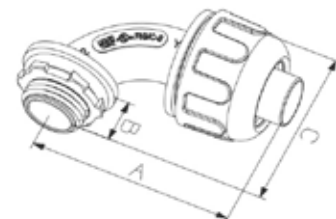



Polypropylene Stud Bushings



- Fits existing irregular shaped holes in metal studs
Alleviates the need to punch holes in metal studs, weakening the structural member
- Protects wire insulation from abrasion in metal studs
- Bushing allows smooth wire pulling
- No tools needed
- Use these bushings to comply with paragraph 300-4(b)(1) of the 2005 NEC code which states that: "In both exposed & concealed locations where nonmetallic-sheathed cables pass through either factory or field punched, cut, or drilled slots or holes in metal members, the cable shall be protected by bushings or grommets covering all metal edges & securely fastened in the opening prior to installation of the cable"

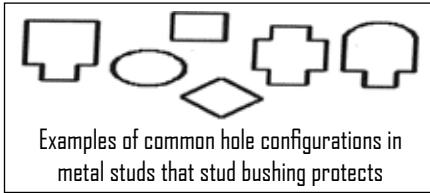
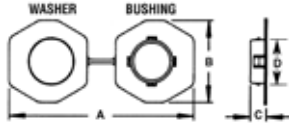

DIMENSIONS = INCHES

CAT. NO.	STUD SIZE	DIMENSIONS				BAG QTY
		A	B	C	D	
21760	2X4	5.67	2.50"	.505	1.30	25

Snap Bushings



- Eliminate sharp edges & insulate your raw-edged holes in metal chassis
- Easily locks into hole firmly with fingertip pressure
- Protect electrical cables, ropes, utility lines passing through metal
- 1/8" maximum steel thickness
- Made from UL approved Nylon 6/6, 94V-2

DIMENSIONS = INCHES

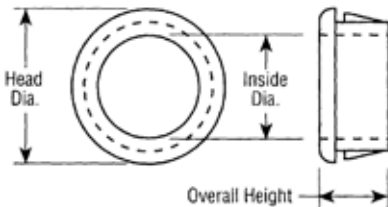

CAT. NO.	MOUNTING HOLE DIAMETER	INSIDE DIAMETER	HEAD DIAMETER	OVERALL HEIGHT	BAG QTY
22311	.28	.23	.34	.24	10
22312	.31	.23	.37	.31	10
22314	.37	.25	.47	.41	10
22314B	.37	.25	.47	.41	1,000
22316	.50	.32	.57	.41	10
22317	.55	.45	.67	.41	10
22318	.63	.48	.73	.41	10
22320	.75	.56	.85	.41	10
22322	.87 (1/2" TRADE)	.68	.94	.45	10
22324	.99	.75	1.10	.45	10
22326	1.17	.95	1.31	.45	10
22328	1.50	1.14	1.62	.45	10
22330	1.72	1.39	1.88	.46	10
22332	1.97	1.64	2.15	.46	10

Snap Bushings with Shutters



- Flexible shutters to accommodate a variety of cable & hose sizes from a minimum of 1/8" to a maximum as shown in the table
- Shutters absorb vibration & cushion cables, tubes, etc.
- Fingertip pressure snap-locks the bushing into the mounting hole
- Universal design to hold various cable ranges
- 1/8" maximum steel thickness
- Made from UL approved Nylon 6/6, 94V-2



DIMENSIONS = INCHES

CAT. NO.	MOUNTING HOLE DIAMETER	MAX CABLE SIZE ID	HEAD DIAMETER	OVERALL HEIGHT	BAG QTY
22342	.63	.44	.72	.41	10
22344	.75	.50	.86	.39	10
22346	.81	.50	.89	.39	10
22348	.87 (1/2" TRADE)	.56	.93	.45	10
22350	1.00	.80	1.12	.44	10
22352	1.09 (3/4" TRADE)	.88	1.21	.44	10
22354	1.35 (1" TRADE)	1.15	1.48	.44	10
22356	1.50	1.22	1.61	.43	10

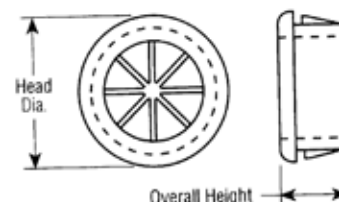

Non-Metallic Bushings



Snap Bushings (Open/Closed)

- Protect wires, tubing, etc. from sharp/uneven drilled & punched metal holes with smooth plastic chassis 1/8" maximum steel thickness
- Finger tip pressure snap-locks the bushing into the mounting hole
- Can be applied where cables are already installed
- Can accommodate cables too large to fit through the inside diameter of a standard bushing Made from UL approved Nylon 6/6, 94V-2



DIMENSIONS = INCHES

CAT. NO.	MOUNTING HOLE DIAMETER	INSIDE DIAMETER	HEAD DIAMETER	OVERALL HEIGHT	BAG QTY
22362	3/8"	.26	.42	.375	10
22364	1/2"	.31	.56	.375	10
22366	5/8"	.45	.70	.375	10
22368	3/4"	.52	.80	.375	10
22370	7/8"	.67	.92	.375	10
22372	1"	.80	1.06	.375	10

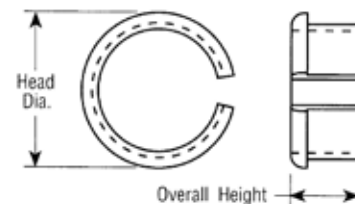



Reducing Washers

Washers/Locknuts



- Use to reduce the size of the knockout in a steel outlet box
- or other metal enclosure or cabinet
- Must use one inside the enclosure opening and one on the outside
- Galvanized Steel

DIMENSIONS = INCHES

CAT. NO.	TRADE SIZE	DIMENSIONS		INNER BOX	OUTER BOX
		A	B		
14620	3/4" X 1/2"	1.44	.87	100	1,000
14621	1" X 1/2"	1.71	.87	100	1,000
14622	1" X 3/4"	1.74	1.10	100	1,000
14623	1-1/4" X 1/2"	2.08	.87	50	500
14624	1-1/4" X 3/4"	2.08	1.125	50	500
14625	1-1/4" X 1"	2.08	1.38	50	500
14626	1-1/2" X 1/2"	2.635	.87	50	500
14627	1-1/2" X 3/4"	2.635	1.06	50	500
14628	1-1/2" X 1"	2.635	1.335	50	500
14629	1-1/2" X 1-1/4"	2.635	1.69	50	500
14630	2" X 1/2"	3.265	.87	25	250
14631	2" X 3/4"	3.265	1.06	25	250
14632	2" X 1"	3.265	1.335	25	250
14633	2" X 1-1/4"	3.265	1.69	25	250
14634	2" X 1-1/2"	3.265	1.935	25	250

Locknuts - Zinc Die Cast

UL LISTED



- Conduit locknuts for securing threaded conduit or connectors with tapered or straight thread, to a knockout or unthreaded slip hole

DIMENSIONS = INCHES

CAT. NO.	TRADE SIZE	DIMENSIONS		INNER BOX	OUTER BOX
		A	B		
14720	1/2"	1.09	0.12	100	4,000
14721	3/4"	1.36	0.14	100	2,500
14722	1"	1.66	0.16	50	1,000

Locknuts - Steel

NEW



- Conduit locknuts for securing threaded conduit or connectors with tapered or straight thread, to a knockout or unthreaded slip hole

DIMENSIONS = INCHES

CAT. NO.	TRADE SIZE	DIMENSIONS		INNER BOX	OUTER BOX
		A	B		
14760	1/2"	1.13	0.10	-	1,000
14761	3/4"	1.39	0.10	-	1,000
14762	1"	1.71	0.13	-	1,000
14763	1-1/4"	2.07	0.13	50	500
14764	1-1/2"	2.39	0.13	50	500
14765	2"	2.88	0.13	25	250
14766	2-1/2"	3.45	0.16	-	100
14767	3"	4.14	0.16	-	100
14768	3-1/2"	4.70	0.16	-	100
14769	4"	5.30	0.16	-	100
14770	5"	6.51	0.37	-	20
14771	6"	7.85	0.37	-	20



- Conduit locknuts for securing threaded conduit or connectors with tapered or straight thread, to a knockout or unthreaded slip hole

DIMENSIONS = INCHES

CAT. NO.	TRADE SIZE	DIMENSIONS		INNER BOX	OUTER BOX
		A	B		
14730	1/2"	1.13	0.11	100	1,000
14731	3/4"	1.39	0.12	100	1,000
14732	1"	1.71	0.15	50	500
14733	1-1/4"	2.06	0.15	25	500
14734	1-1/2"	2.36	0.15	25	200
14735	2"	2.86	0.16	25	200
14736	2-1/2"	3.43	0.20	25	100
14737	3"	4.11	0.20	25	100
14738	3-1/2"	4.69	0.21	25	100
14739	4"	5.26	0.22	25	100
14740	5"	6.50	0.43	-	20
14741	6"	7.80	0.43	-	20

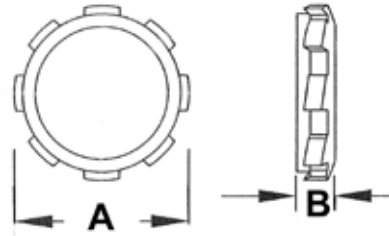

Sealing Locknuts - Steel

- Sealing locknuts provide a rain tight seal when securing threaded conduit or connectors with tapered or straight thread, to a knockout or unthreaded slip hole of a box or enclosure
- Integral Gasket

DIMENSIONS = INCHES

CAT. NO.	TRADE SIZE	DIMENSIONS		INNER BOX	OUTER BOX
		A	B		
14754	1/2"	1.13	.21	100	1,000
14755	3/4"	1.39	.22	100	1,000
14756	1"	1.71	.31	100	1,000
14757	1-1/4"	2.07	.29	50	500
14758	1-1/2"	2.36	.29	50	500
14759	2"	2.88	.29	25	250

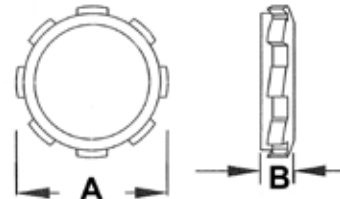

- Used with bushings to bond threaded rigid conduit and IMC to boxes, cabinets, or other enclosures where locknut is exposed

DIMENSIONS = INCHES

CAT. NO.	TRADE SIZE	DIMENSIONS		INNER BOX	OUTER BOX
		A	B		
14742	1/2"	1.14	.17	100	1,000
14743	3/4"	1.39	.18	100	1,000
14744	1"	1.73	.24	50	500
14745	1-1/4"	2.08	.24	25	200
14746	1-1/2"	2.40	.25	25	200
14747	2"	2.91	.29	25	100
14748	2-1/2"	3.46	.29	25	100
14749	3"	4.14	.30	25	100
14750	3-1/2"	4.69	.30	25	100
14751	4"	5.25	.34	25	100

Grounding Locknuts - Steel

UL LISTED

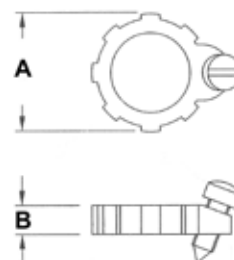



Rigid Water Tight Hubs - Zinc Die Cast



- To secure threaded rigid service entrance conduit & IMC to box or enclosure
- Assembled with 105°C rated flame retardant Lexan throat insulator and BUNA-N sealing ring that completely encircles knockout to prevent contaminants from entering enclosure
- UL Listed and CSA Certified for use in wet locations

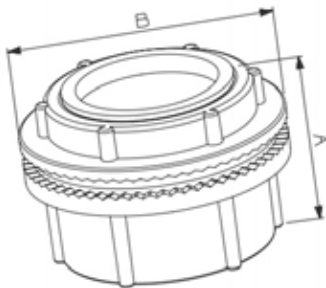

DIMENSIONS = INCHES

CAT. NO.	TRADE SIZE	DIMENSIONS		INNER BOX	OUTER BOX
		A	B		
14800	1/2"	1.41	1.41	-	150
14801	3/4"	1.54	1.66	-	120
14802	1"	1.75	1.95	-	50
14803	1-1/4"	1.69	2.41	-	40
14804	1-1/2"	1.71	2.69	-	30
14805	2"	1.83	3.20	-	30
14806	2-1/2"	2.59	3.69	-	10
14807	3"	2.61	4.39	-	6
14808	3-1/2"	2.53	4.72	-	6
14809	4"	2.56	5.47	-	6

Watertight Hubs

Rigid Water Tight Hubs with Bonding Screw - Zinc



- Male thread type
- Tapered female thread for Rigid conduit and IMC
- Recessed O-ring seal assures watertight connections
- Insulated throat and bonding locknut is suitable for service entrance application
- Assembled with 105°C rated flame retardant Lexan throat insulator and BUNA-N sealing ring
- UL Listed and CSA Certified for use in wet locations

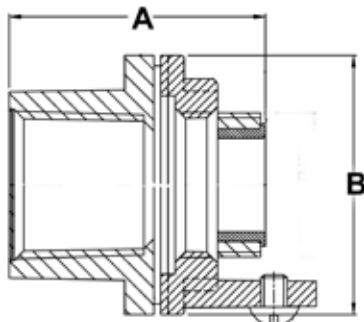

DIMENSIONS = INCHES

CAT. NO.	TRADE SIZE	DIMENSIONS		INNER BOX	OUTER BOX
		A	B		
14810	1/2"	1.42	1.22	25	250
14811	3/4"	1.61	1.50	25	150
14812	1"	1.87	1.89	25	100
14813	1-1/4"	2.01	2.24	10	60
14814	1-1/2"	2.12	2.52	10	60
14815	2"	2.20	3.03	10	40
14816	2-1/2"	2.64	3.54	-	12
14817	3"	2.64	4.07	-	12
14818	3-1/2"	2.70	4.78	-	6
14819	4"	2.70	5.35	-	6



Cord Grips - Zinc Die Cast



- Use to Connect S, SD, ST, SJ, SJD and SJT Cord to a Steel Outlet Box or other Metal Enclosure
- Neoprene Grommet for a moisture proof seal
- Simple Installation, cord can be installed without disassembly of the fitting
- Liquid-tight/Oil-tight/Rain-tight
- Suitable for NEMA 4 Enclosures and other wet locations
- Male Tapered NPT Threading
- Colored Seal allows for Easy Identification

DIMENSIONS = INCHES

CAT. NO.	TRADE SIZE	INSERT COLOR	CABLE RANGE		OVERALL DIM.		INNER BOX	OUTER BOX
			C	A	B			
15450	1/2"	RED	.190 - .260	1.22	1.14	25	250	
15451	1/2"	BLUE	.260 - .375	1.22	1.14	25	250	
15452	1/2"	GREEN	.375 - .500	1.22	1.14	25	250	
15453	3/4"	GREEN	.375 - .500	1.34	1.20	25	250	
15454	3/4"	BROWN	.500 - .625	1.34	1.20	25	250	
15455	3/4"	ORANGE	.625 - .725	1.34	1.20	25	250	
15457	1"	BROWN	.500 - .650	1.42	1.69	10	100	
15458	1"	ORANGE	.625 - .750	1.42	1.69	10	100	
15459	1"	BLACK	.750 - .880	1.42	1.69	10	100	
15460	1"	PURPLE	.880 - .985	1.42	1.69	10	100	

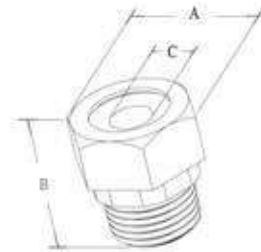

Cord Grips / Cable Glands



Metal Cable Glands - NPT Thread

- Used to introduce cables or leads into metal housings, or to introduce reinforced cables
- Designed for use in areas of zone I(2G) and 2I(1D) with no risk of explosion and for cables with and without reinforcement
- In case of systems or housing manufactured according to NEC, the line or the connecting cable must be introduced by conduits, mounting fittings, etc. with NPT threads
- Working Temp: -40°F to 212°F
- Brass Nickel Plated
- IP 68 (NEMA 6P) rated - Submersible & Dustproof

DIMENSIONS = INCHES

CAT. NO.	CABLE RANGE	DIMENSIONS			INNER BAG QTY	OUTER BOX QTY
		D1 THREAD	GI (INCHES)	H (INCHES)		
22600	.16" - .32"	3/8"	.59	.83	100	1,500
22601	.24" - .48"	1/2"	.51	.94	100	800
22602	.40" - .55"	1/2"	.51	.94	50	600
22603	.51" - .71"	3/4"	.51	.98	50	500
22604	.71" - .99"	1"	.67	1.14	25	400



Metal Cable Glands - Metric Thread

- Cable Glands with Metric threads are now standard and replacements for the PG Cable Glands
- Used to introduce cables or leads into metal housings or to introduce reinforced cables
- Designed for use in areas of zone I(2G), and 2I(1D) with no risk of explosion and for cables with and without reinforcement
- Working Temp: -40°F to 212°F
- Brass Nickel Plated
- IP 68 (NEMA 6P) rated - Submersible & Dustproof

DIMENSIONS = INCHES

CAT. NO.	CABLE RANGE	DIMENSIONS			INNER BAG QTY	OUTER BOX QTY
		D1 THREAD	GI (INCHES)	H (INCHES)		
22590	.12" - .26"	M12	.26	.75	100	2,000
22591	.16" - .32"	M16	.24	.83	100	1,500
22592	.20" - .40"	M16	.24	.83	100	1,000
22593	.24" - .48"	M20	.24	.91	100	800
22594	.40" - .55"	M20	.24	.91	50	600
22595	.51" - .71"	M25	.28	1.02	50	500
22596	.71" - .99"	M32	.31	1.22	20	400
22597	.87" - 1.26"	M40	.31	1.46	10	160
22598	1.26" - 1.50"	M50	.35	1.46	10	120
22599	1.46" - 1.73"	M63	.39	1.50	10	80

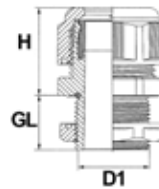



Nylon Cable Glands - NPT Thread

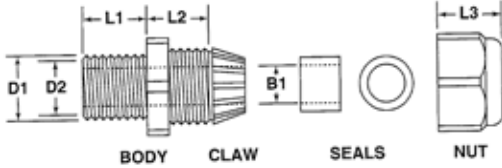

- Seal & Clamp System allows cord connector to tighten in a Circular Sequence on the sealing ring to give Superior Strain Relief without twisting or damaging the cable
- Simply push the cable through the liquid-tight nylon strain relief & tighten nut for quick installation
- Threads into your panel for clearance, locknut included
- Internal Ratchet with Self-Locking Feature protects against vibration
- 'Collet' Design Accommodates Various Size Cords, Cables, Tubing, etc.
- Nylon Body Material is resistant to most common chemicals & solvents
- For Best Results, Use the Minimum Size that accommodates your cable
- No Disassembly Required
- Made of UL approved NYLON 66, 94V-2 (Black)
- IP68 Rated Submersible & Dustproof
- UL Recognized
- 94V-2 Flame Rating, -22°F to 140°F Temp Rating
- Locknut Not Included (Sold Separately)

DIMENSIONS = INCHES

CAT. NO.	NPT THREAD	CABLE RANGE	D1	D2	B1	L1	L2	L3	BAG QTY	MASTER BAG QTY
22550	1/4-18	.118" - .256"	.520"	.327"	.236"	.299"	.500"	.520"	10	100
22551	3/8-18	.197" - .394"	.646"	.421"	.354"	.575"	.539"	.661"	10	100
22552	1/2-14	.394" - .551"	.815"	.587"	.500"	.492"	.740"	.724"	10	100
22553	3/4-14	.512" - .709"	1.008"	.728"	.650"	.575"	.701"	.878"	10	100
22554	1-11.5	.709" - .984"	1.299"	1.024"	.933"	.579"	.811"	1.071"	10	100
22555	1-1/4-11.5"	.866" - 1.260"	1.642"	1.260"	1.142"	.705"	.882"	1.236"	10	100

Nylon Cable Glands - NPT Thread - 90°

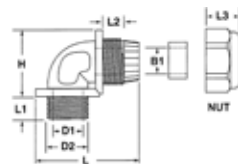

- Same features as Nylon Cable Gland above
- 90° Orientation
- UV Resistant Black
- 94V-2 Flame Rating, -22°F to 140°F Temp Rating
- IP68 Rated Submersible & Dustproof

DIMENSIONS = INCHES

CAT. NO.	NPT THREAD	CABLE RANGE	MOUNTING HOLE DI	D2	B1	L1	L2	L3	L	H	BAG QTY	MASTER BAG QTY
22582	3/8-18	.02-.35"	.47"	.65"	.37"	.46"	.39"	.66"	1.91"	1.18"	10	100
22584	1/2-1/4	.39-.51"	.55"	.83"	.51"	.58"	.46"	.72"	2.03"	1.23"	10	100
22586	3/4-1/4	.51-.63"	.76"	1.04"	.65"	.58"	.49"	.88"	2.54"	1.64"	10	100
22588	1-1/4-11.5	.87-1.14"	1.24"	1.64"	1.15"	.74"	.64"	1.22"	3.35"	2.09"	10	100

Nylon NPT Lock Nuts

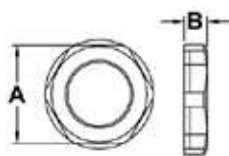

- Nylon 66 Material
- NPT Thread
- Hexagonal Head
- UL 94 V-2 Flame Rating

DIMENSIONS = INCHES

CAT. NO.	TRADE SIZE	DIMENSIONS		BOX QTY
		W	H	
22556	1/4"	.67	.19	50
22557	3/8"	.87	.20	50
22558	1/2"	1.06	.24	50
22559	3/4"	1.30	.28	50
22560	1"	1.66	.32	25
22561	1-1/4"	1.92	.35	10

Nylon Cable Glands - Multi-Conductor - NPT Thread



- Same features as Nylon Cable Gland on previous page
- Multi-Hole Design organizes Multiple Cables within a Gland
- Easy to Assemble
- Wide Clamping Range
- -22°F to 140°F Temperature Rating
- UV Resistant Black
- Made of UL Approved NYLON 66
- Flammability Rating: 94V-2
- IP68 Rated Submersible & Dustproof
- Locknut Not Included (Sold Separately)



DIMENSIONS = INCHES

DIMENSIONS = INCHES

CAT. NO.	NPT THREAD	CABLE RANGE	DI	LI	BAG QTY	MASTER BAG
2 HOLE GLAND						
22230	1/4-18	.078 - .122	.52	.31	10	100
22231	3/8-18	.064 - .102	.66	.57	10	100
22232	3/8-18	.078 - .122	.66	.57	10	100
22233	3/8-18	.119 - .161	.66	.57	10	100
22234	1/2-14	.064 - .102	.83	.51	10	100
22235	1/2-14	.098 - .138	.83	.51	10	100
22236	1/2-14	.130 - .170	.83	.51	10	100
22237	1/2-14	.157 - .240	.83	.51	10	100
22238	3/4-14	.098 - .138	1.04	.57	10	100
22239	3/4-14	.138 - .200	1.04	.57	10	100
22240	3/4-14	.200 - .256	1.04	.57	10	100
22241	3/4-14	.252 - .343	1.04	.57	10	100
22242	1-11.5	.142 - .205	1.31	.59	10	100
22243	1-11.5	.200 - .256	1.31	.59	10	100
22244	1-11.5	.252 - .343	1.31	.59	10	100
22245	1-11.5	.303 - .394	1.31	.59	10	100
22246	1-1/4-11.5	.276 - .354	1.65	.72	10	100
22247	1-1/4-11.5	.433 - .512	1.65	.72	10	100
3 HOLE GLAND						
22248	1/4-18	.063 - .102	.52	.31	10	100
22249	3/8-18	.063 - .102	.66	.57	10	100
22250	3/8-18	.118 - .165	.66	.57	10	100
22251	1/2-14	.078 - .118	.83	.51	10	100
22252	1/2-14	.118 - .165	.83	.51	10	100
22253	1/2-14	.138 - .205	.83	.51	10	100
22254	3/4-14	.102 - .142	1.04	.57	10	100
22255	3/4-14	.142 - .205	1.04	.57	10	100
22256	3/4-14	.189 - .244	1.04	.57	10	100
22257	3/4-14	.244 - .315	1.04	.57	10	100
22258	1-11.5	.142 - .205	1.31	.59	10	100
22259	1-11.5	.189 - .244	1.31	.59	10	100
22260	1-11.5	.244 - .315	1.31	.59	10	100
22261	1-11.5	.303 - .394	1.31	.59	10	100
22262	1-1/4-11.5	.256 - .327	1.65	.72	10	100
22263	1-1/4-11.5	.303 - .394	1.65	.72	10	100
4 HOLE GLAND						
22264	1/4-18	.051 - .091	.52	.31	10	100
22265	3/8-18	.051 - .091	.66	.57	10	100
22266	3/8-18	.094 - .134	.66	.57	10	100
22267	1/2-14	.055 - .094	.83	.51	10	100
22268	1/2-14	.094 - .134	.83	.51	10	100
22269	1/2-14	.134 - .189	.83	.51	10	100
22270	3/4-14	.063 - .098	1.04	.57	10	100
22271	3/4-14	.098 - .142	1.04	.57	10	100
22272	3/4-14	.150 - .205	1.04	.57	10	100
22273	3/4-14	.220 - .287	1.04	.57	10	100
22274	1-11.5	.079 - .122	1.31	.59	10	100
22275	1-11.5	.118 - .161	1.31	.59	10	100
22276	1-11.5	.150 - .205	1.31	.59	10	100
22277	1-11.5	.220 - .287	1.31	.59	10	100
22278	1-11.5	.276 - .354	1.31	.59	10	100
22279	1-1/4-11.5	.394 - .472	1.65	.72	10	100

CAT. NO.	NPT THREAD	CABLE RANGE	DI	LI	BAG QTY	MASTER BAG
5 HOLE GLAND						
22280	3/8-18	.079 - .110	.66	.57	10	100
22281	1/2-14	.051 - .079	.83	.51	10	100
22282	1/2-14	.079 - .110	.83	.51	10	100
22283	1/2-14	.118 - .161	.83	.51	10	100
22284	3/4-14	.047 - .079	1.04	.57	10	100
22285	3/4-14	.079 - .122	1.04	.57	10	100
22286	3/4-14	.118 - .161	1.04	.57	10	100
22287	3/4-14	.142 - .181	1.04	.57	10	100
22288	3/4-14	.181 - .236	1.04	.57	10	100
22289	1-11.5	.102 - .142	1.31	.59	10	100
22290	1-11.5	.142 - .181	1.31	.59	10	100
22291	1-11.5	.181 - .237	1.31	.59	10	100
22292	1-11.5	.237 - .315	1.31	.59	10	100
22293	1-1/4-11.5	.256 - .327	1.65	.72	10	100
6 HOLE GLAND						
22294	3/8-18	.055 - .083	.66	.57	10	100
22295	1/2-14	.051 - .079	.83	.51	10	100
22296	1/2-14	.079 - .118	.83	.51	10	100
22297	3/4-14	.055 - .083	1.04	.57	10	100
22298	3/4-14	.079 - .118	1.04	.57	10	100
22299	3/4-14	.102 - .142	1.04	.57	10	100
22300	3/4-14	.142 - .205	1.04	.57	10	100
22301	1-11.5	.102 - .142	1.31	.59	10	100
22302	1-11.5	.142 - .205	1.31	.59	10	100
22303	1-11.5	.220 - .276	1.31	.59	10	100
7 HOLE GLAND						
22304	1/2-14	.051 - .079	.83	.51	10	100
22305	1/2-14	.079 - .118	.83	.51	10	100
22306	3/4-14	.051 - .079	1.04	.57	10	100
22307	3/4-14	.079 - .118	1.04	.57	10	100
22308	3/4-14	.102 - .142	1.04	.57	10	100
22309	1-11.5	.102 - .142	1.31	.59	10	100
22310	1-11.5	.181 - .236	1.31	.59	10	100

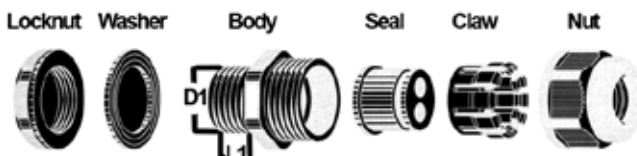



Nylon Cable Glands - Metric Thread



Cable Glands

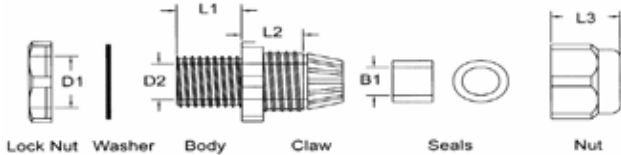

- Seal & Clamp System allows the cord connector to tighten in a Circular Sequence on the sealing ring to give Superior Strain Relief without twisting or damaging the cable
- Simply push the cable through the liquid-tight nylon strain relief & tighten nut for quick installation
- Threads into your panel for clearance, locknut included
- Internal Ratchet with Self-Locking Feature protects against vibration
- 'Collet' Design Accommodates Various Size Cords, Cables, Tubing, etc.
- Nylon Body Material is resistant to most common chemicals & solvents
- For Best Results, Use the Minimum Size that accommodates your cable
- No Disassembly Required
- Made of UL approved NYLON 66, 94V-2 (Black)
- -22°F to 140°F Temperature Rating
- IP68 Rated Submersible & Dustproof
- Metric Thread - Does not have NPT threading
- UL Recognized - 22564-22568 UR Listed

*Not UL Recognized

DIMENSIONS = INCHES

CAT. NO.	MOUNTING HOLE (D1)	CABLE RANGE	THREAD PITCH (MM)	D2	B1	L1	L2	L3	BAG QTY	MASTER BAG QTY
22532*	.47"	.12-.26"	M12-1.25	.33"	.24"	.31"	.48"	.52"	10	100
22534	.63"	.20-.39"	M16-1.50	.43"	.38"	.62"	.57"	.66"	10	100
22536	.79"	.39-.55"	M20-1.50	.58"	.51"	.59"	.78"	.72"	10	100
22538	.98"	.51-.71"	M25-1.50	.73"	.65"	.59"	.74"	.88"	10	100
22540	1.28"	.71-.98"	M32-1.50	1.02"	.92"	.58"	.80"	1.03"	10	100
22542	1.57"	.87-1.26"	M40-1.50	1.30"	1.20"	.70"	.92"	1.24"	10	100
22544*	1.97"	1.18-1.50"	M50-1.50	1.62"	1.50"	.68"	1.01"	1.24"	10	100
22546*	2.40"	1.34-1.73"	M61-1.50	2.13"	1.73"	.73"	1.06"	1.28"	10	100
22548*	2.48"	1.65-1.97"	M63-1.50	2.20"	1.95"	1.00"	1.16"	1.43"	10	100

Nylon Cable Glands - Metric Thread (With Strain Relief)

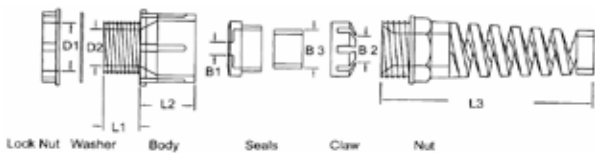

- Extended Cord Support Strain Relief Feature
- Seal & Clamp System allows the cord connector to Tighten in a Circular Sequence on the sealing ring to give Superior Strain Relief without twisting or damaging the cable
- Simply push the cable through the liquid tight nylon strain relief & tighten nut for quick installation
- Threads into your panel for clearance, locknut included
- Internal Ratchet with Self-Locking Feature protects against vibration
- 'Collet' Design Accommodates Various Size Cords, Cables, Tubing, etc.
- Nylon body Material is resistant to most common chemicals & solvents
- For Best Results, Use the Minimum Size that fits into your cable
- No Disassembly Required
- Made of UL approved NYLON 66, 94V-2 (Black)
- -22°F to 140°F Temperature Rating
- IP68 Rated Submersible & Dustproof
- Metric Thread - Does not have NPT threading
- UL Recognized - 22564-22568 UR Listed

*Not UL Recognized

DIMENSIONS = INCHES

CAT. NO.	MOUNTING HOLE (D1)	CABLE RANGE	THREAD PITCH (MM)	D2	B1	L1	L2	L3	BAG QTY	MASTER BAG QTY
22562*	.47"	.12-.26"	M12-1.25	.33"	.24"	.31"	.48"	.52"	10	100
22564	.63"	.20-.39"	M16-1.50	.43"	.38"	.62"	.57"	.66"	10	100
22566	.79"	.39-.55"	M20-1.50	.58"	.51"	.59"	.78"	.72"	10	100
22568	.98"	.51-.71"	M25-1.50	.73"	.65"	.59"	.74"	.88"	10	100



- Accommodates:
 - One or Two 14-2, 14-3 and 12-2 Cables,
 - One 12-3, 10-2 and 10-3 cable,
 - One or Two .300" to .600" Diameter Cords
- Push-in Design with a Captive Locking Wedge that secures cable with a single squeeze with pliers
- Excellent Insulation and Superior Strain Relief
- Sized to fit 1/2" Knockout

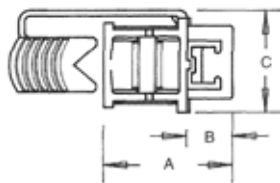

NM Cable Connector



DIMENSIONS = INCHES

CAT. NO.	SIZE	DIMENSIONS			BAG QTY	CASE QTY
		A	B	C		
21762	1/2"	1-3/8"	.1/2"	1"	50	1,000

NM Connectors



- Smaller and Easily Installed in confined areas
- No tools Required
- Simple Snap-in Installation
- Easily Removed from Knockouts and Easy Removal of NM from Connector
- A Labor Saving Connector with 60 pound Test Pull
- 21764 is gray and 21765 is black

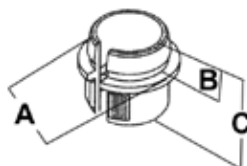

NM Cable Connector



DIMENSIONS = INCHES

CAT. NO.	SIZE	CABLE SIZE	DIMENSIONS			BAG QTY	CASE QTY
			A	B	C		
21764	1/2"	SINGLE CABLE 14/2 - 10/3 TWO CABLES 14/2, 12/2, 14/3	1"	3/8"	15/16"	100	3,000
21765	3/4"	THREE CABLES (3)#6 - (3)#8	1-5/16"	5/8"	1"	50	1,000



- Smaller and Easily Installed in confined areas
- No tools Required
- Simple Snap-in Installation
- Easily Removed from Knockouts and Easy Removal of NM from Connector

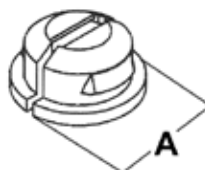

NM Cable Connector

DIMENSIONS = INCHES

CAT. NO.	KO SIZE	CABLE SIZE	DIM. "A"	BAG QTY	CASE QTY
21766	1/2"	14/2 OR 12/2	1-1/16"	100	5,000



3/8" NM Connector - Zinc Die Cast



- Used to connect Non-Metallic Sheath Cable and Flexible Cord from .30" to .45" in diameter to Outlet Boxes, Enclosures, or Raceway Systems
- 3/8" size fits 1/2" knockout
- Assembled with Zinc Die Cast Locknut and Combo Screws

DIMENSIONS = INCHES

CAT. NO.	TRADE SIZE	DIMENSIONS		INNER BOX	OUTER BOX
		A	B		
15330	3/8"	0.78	0.35	100	1,000

Non-Watertight NM Round Connectors - Zinc Die Cast

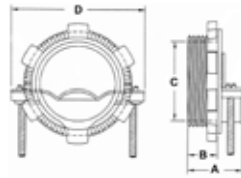

- Used with Locknut to Terminate Service Entrance Cable to Enclosure
- Assembled with Zinc Die Cast Locknut and Combo Screws
- For Type SEU and NM Cable

DIMENSIONS = INCHES

CAT. NO.	TRADE SIZE	DIMENSIONS				INNER BOX	OUTER BOX
		A	B	C	D		
15331	3/4"	.83	.32	.83	1.67	40	400
15332	1"	1.14	.55	1.04	1.95	20	200
15333	1-1/4"	1.24	.57	1.38	2.20	15	150
15334	1-1/2"	1.40	.57	1.61	2.60	10	100
15335	2"	1.50	.65	2.05	3.03	8	80

Non-Watertight NM Oval Connectors - Zinc Die Cast

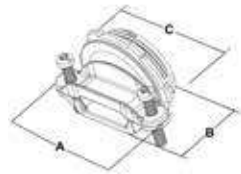

- Used with Locknut to Terminate NM Cable to Enclosure
- Assembled with Zinc Die Cast Locknut and Combo Screws
- For NM Oval Cable

DIMENSIONS = INCHES

CAT. NO.	TRADE SIZE	DIMENSIONS			INNER BOX	OUTER BOX
		A	B	C		
15337	1-1/4"	2.26	1.29	1.91	10	100
15338	1-1/2"	2.84	1.30	2.19	10	100
15339	2"	3.48	1.51	2.76	5	50

Tilt-in NM Connectors - Steel

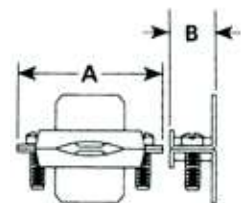

- To terminate one or more Non-Metallic Sheathed Cables to a Knockout in a dry location box or enclosure
- Zinc Plated Steel
- No locknut Required

DIMENSIONS = INCHES

CAT. NO.	TRADE SIZE	DIMENSIONS		INNER BOX	OUTER BOX
		A	B		
19012	1/2"	1.31	.59	100	1000
19013	3/4"	1.73	.75	-	100
19014	1-1/4"	1.97	.69	-	50
19015	1-1/2"	2.52	.78	25	250



BX/Flex Set Screw Box Connectors - Zinc Die Cast



- Use to connect 1/2 BX cable to a Steel Box or other Metal Enclosure
- Suitable for #14-2 Steel armored cable
- 3/8" size - fits 1/2" Knockout
- Furnished with Zinc Die-Cast locknuts
- Combo Head Screws

DIMENSIONS = INCHES

CAT. NO.	TRADE SIZE	DIMENSIONS			INNER BOX	OUTER BOX
		A	B	C		
15052	3/8"	.79	.97	.39	50	500



Flex Angled Set Screw Box Connectors - Zinc Die Cast

- Use to connect Steel or Aluminum Flexible Metallic Conduit to a Steel Box or other Metal Enclosure
- Angled Combo Head Set Screw for Easy Access
- Furnished with Die Cast Zinc locknuts

DIMENSIONS = INCHES

CAT. NO.	TRADE SIZE	DIMENSIONS		INNER BOX	OUTER BOX
		A	B		
15055	3/8"	.95	1.00	40	400
15053	1/2"	1.20	1.46	25	250
15054	3/4"	1.33	1.56	25	250

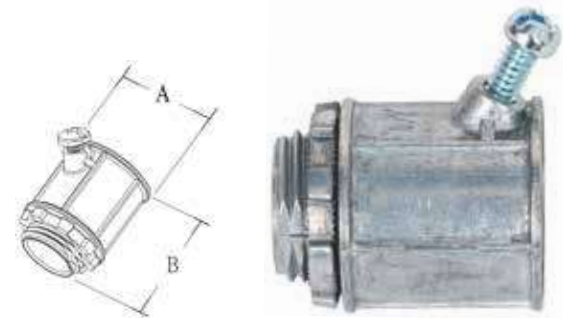

Flex 2 Set Screw - Strap Type Multi-Purpose Box Connectors

- Terminate flexible metallic conduit FMC, AC, MC, or NM cable to a Steel box or other enclosure:
 - 1/2, 1/2 or 1/3 NM Cable
 - 1/2 Thru 1/4 AC or MC Cable
 - 3/8" FMC
- 3/8" Trade Size fits a 1/2" knockout
- Male Hub - NPSM Thread
- Combination Head Screws
- Zinc Die Cast

DIMENSIONS = INCHES

CAT. NO.	TRADE SIZE	DIMENSIONS		INNER BOX	OUTER BOX
		A	B		
15058	3/8"	0.78	0.35	100	1,000

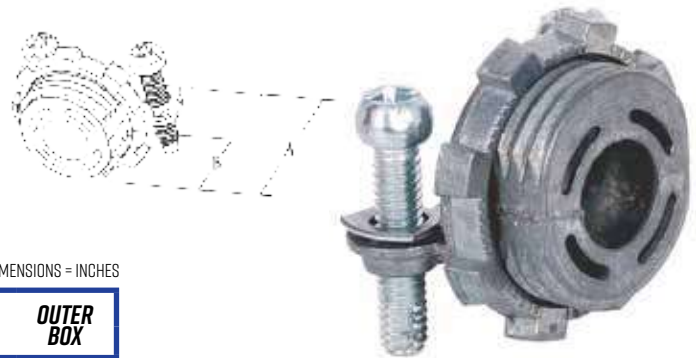

Flex Saddle Box Connector For AC & MC Flex Conduits - Zinc

- Use to connect flexible metal conduit, AC, MC and NM sheathed cable to a Steel Box or other Metal Enclosure
- 3/8" size fits 1/2" knockout
- End Stopped
- Combo Head Screws
- Zinc Die Cast

DIMENSIONS = INCHES

CAT. NO.	TRADE SIZE	DIMENSIONS			INNER BOX	OUTER BOX
		A	B (MIN)	B (MAX)		
15060	3/8"	0.93	0.40	0.50	500	500

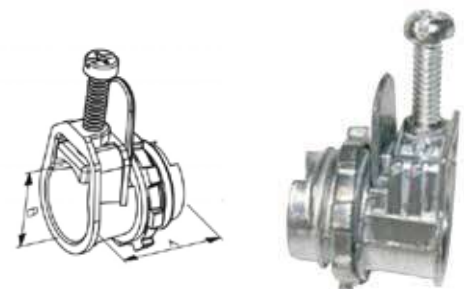



Flex Duplex Box Connectors - Zinc Die Cast



FIG 1

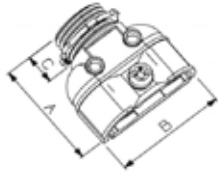

FIG 1

- Use to connect two pieces of Flexible Metallic Conduit, AC, MC, or NM sheathed cable to a steel box or other metal enclosure when using only one knockout opening:
 - 14/2 Thru 12/3 NM
 - 14/2 Thru 10/4 AC
 - 14/2 Thru 10/3 MC
 - 3/8" FMC
- 3/8" size fits 1/2" knockout
- One Screw or Two Screw design



FIG 2

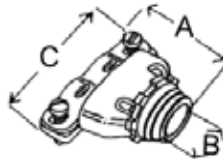

FIG 2

DIMENSIONS = INCHES

CAT. NO.	TRADE SIZE	FIGURE	# OF SCREWS	DIMENSIONS			INNER BOX	OUTER BOX
				A	B	C		
15065	3/8"	1	1	1.59	1.62	0.46	25	250
15066	3/8"	2	2	1.57	.61	2.32	25	250

BX - Flex - MC

90° Flex Conduit Duplex Box Connector - Zinc Die Cast

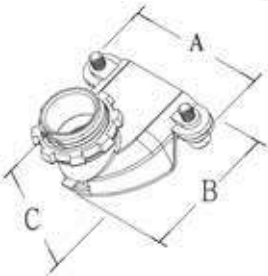

- Use to connect two pieces of Flexible Metallic Conduit, AC, MC or NM sheathed cable to a steel outlet box or other metal enclosure when using only one knockout opening in a dry location:
 - 14/2 Thru 10/3 NM
 - 14/2 Thru 10/4 AC
 - 14/2 Thru 10/3 MC
 - 3/8" FMC
- 3/8" size fits 1/2" knockout
- Two Combo Head Mounting Screws

DIMENSIONS = INCHES

CAT. NO.	TRADE SIZE	DIMENSIONS			INNER BOX	OUTER BOX
		A	B	C		
15067	3/8"	2.02	1.64	1.24	25	250

Anti-Short Bushings

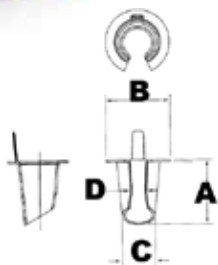

- Insulates conductor from cut armor ends on flexible BX or Greenfield conduit
- Inserted into I.D. at termination point
- Overlapping horizontal flange protects against sharp metal edges
- Tapered design assures fast insertion
- Extra length assures positive grip
- Polypropylene material resists weather extremes, oil, moisture and chemicals
- Rated up to 194°F

DIMENSIONS = INCHES

CAT. NO.	SIZE	CABLE SIZES	DIMENSIONS				BAG QTY
			A	B	C	D	
21752	0	14/2, 14/3, 12/2	.56"	.671"	.38"	.312"	35
21753	1	14/4, 12/3, 6/1, 4/1	.65"	.671"	.45"	.312"	35
21754	2	12/4, 10/2, 10/3, 2/1	.61"	.859"	.58"	.125"	35
21755	3	10/4, 8/2, 8/3, 1/1	.67"	1.046"	.79"	.109"	20
21756	4	8/4, 6/4, 6/3, 6/2, 4/3, 4/2	.83"	1.266"	1.00"	.156"	16



Screw-In Connector For Greenfield/Flex Conduit



- Use to connect Flexible Metallic Conduit to steel outlet box, load center or other metal enclosure
- Zinc Die Cast
- Assembled with Zinc Die Cast locknut

DIMENSIONS = INCHES

CAT. NO.	TRADE SIZE	DIMENSIONS			INNER BOX	OUTER BOX
		A	B	C		
15070	3/8"	1.22	.38	1.1	80	800
15071	1/2"	1.30	.64	1.1	60	600
15072	3/4"	1.52	.81	1.38	35	350
15073	1"	1.87	1.00	1.70	15	150
15074	1-1/4"	2.13	1.27	2.1	10	100
15075	1-1/2"	2.32	1.51	2.42	6	60
15076	2"	2.48	2.02	2.98	3	30

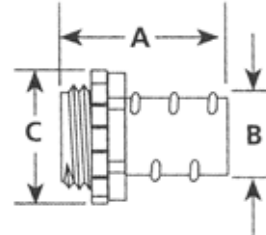

Screw-In Connector Insulated Throat For Greenfield/Flex Conduit

- Use to connect Flexible Metallic Conduit to steel outlet box, load center or other metal enclosure
- Insulated Throat
- Zinc Die Cast
- Assembled with Zinc Die Cast locknut

DIMENSIONS = INCHES

CAT. NO.	TRADE SIZE	DIMENSIONS			INNER BOX	OUTER BOX
		A	B (OD)	C		
15077	3/8"	1.26	.38	1.10	80	800
15078	1/2"	1.34	.64	1.10	60	600
15079	3/4"	1.56	.81	1.38	35	350
15080	1"	1.91	1.00	1.70	15	150
15081	1-1/4"	2.17	1.27	2.10	10	100
15082	1-1/2"	2.36	1.51	2.42	6	60
15083	2"	2.52	2.02	2.98	3	30

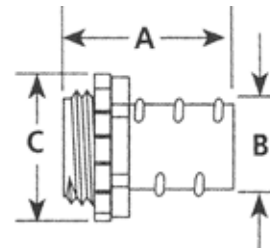

Screw-In Couplings For Greenfield/Flex Conduit

- Use to connect two pieces of Flexible Metal Conduit
- Zinc Die Cast

DIMENSIONS = INCHES

CAT. NO.	TRADE SIZE	DIMENSIONS			INNER BOX	OUTER BOX
		A	B	C		
15084	1/2"	1.81	.91	.20	40	400
15085	3/4"	2.09	1.10	.24	25	250
15086	1"	2.40	1.36	.32	15	150
15087	1-1/4"	2.76	1.66	.32	10	100
15088	1-1/2"	3.08	1.93	.32	6	60
15089	2"	3.32	2.48	.32	3	30

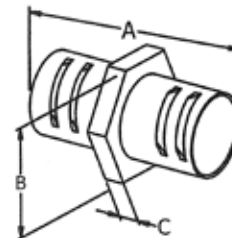



Straight Squeeze Box Connectors



BX - Flex - MC

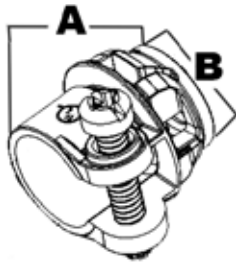

- Used with a locknut to terminate steel or aluminum Flexible Metal Conduit, Armored Cable & MC to enclosure
- Assembled with Zinc Die Cast Locknut & Combo Screws

DIMENSIONS = INCHES

CAT. NO.	TRADE SIZE	DIMENSIONS		INNER BOX	OUTER BOX
		A	B		
15110	3/8"	1.15	.35	50	500
15111	1/2"	1.44	.59	25	250
15112	3/4"	1.58	.77	25	250
15113	1"	1.76	.98	-	100
15114*	1-1/4"	1.87	1.21	-	100
15115*	1-1/2"	2.01	1.41	-	50
15116*	2"	2.09	1.95	4	40
15117*	2-1/2"	2.85	2.32	-	10
15118*	3"	2.24	2.82	-	10
15119*	3-1/2"	4.06	3.28	-	10
15120*	4"	4.16	3.76	-	10

* Flexible Metal Conduit Only

Straight Squeeze Box Connectors - Insulated Throat

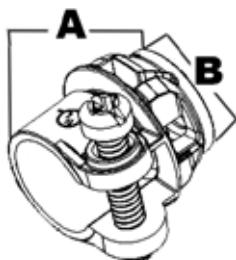

- Used with a locknut to terminate steel or aluminum Flexible Metal Conduit, Armored Cable & MC to Enclosure
- Insulated Throat
- Assembled with Zinc Die Cast Locknut & Combo screws

DIMENSIONS = INCHES

CAT. NO.	TRADE SIZE	DIMENSIONS		INNER BOX	OUTER BOX
		A	B		
15121	1/2"	1.44	.54	25	250
15122	3/4"	1.58	.70	25	250
15123	1"	1.76	.92	10	100
15124*	1-1/4"	1.87	1.65	10	100
15125*	1-1/2"	2.01	1.97	5	50
15126*	2"	2.09	2.47	4	40
15127*	2-1/2"	2.85	2.32	-	18
15128*	3"	2.24	2.82	-	12
15129*	3-1/2"	4.06	3.28	-	8
15130*	4"	4.24	3.76	-	8

* Flexible Metal Conduit Only



Squeeze Box Connectors 90°



- Used with a locknut to Terminate Steel or Aluminum Flexible Metal Conduit, AC and MC Cable to a steel outlet box or other metal enclosure
- Assembled with Zinc Die Cast Locknut & Combo Screws



DIMENSIONS = INCHES

CAT. NO.	TRADE SIZE	DIMENSIONS					INNER BOX	OUTER BOX
		A	B	C	D	E		
15131	3/8"	1.22	1.34	.63	.97	1.75	50	500
15132	1/2"	1.50	1.65	.63	.97	2.12	25	250
15133	3/4"	1.58	1.89	.86	1.20	2.35	10	100
15134	1"	2.26	2.38	1.04	1.45	2.77	5	50
15135*	1-1/4"	2.76	2.68	1.42	1.86	3.89	10	40
15136*	1-1/2"	4.06	3.76	1.58	2.32	6.01	2	12
15137*	2"	4.08	3.76	2.07	2.66	6.01	2	12
15138*	2-1/2"	6.90	5.40	2.50	3.07	6.80	-	10
15139*	3"	7.80	5.70	3.15	3.71	7.89	-	6
15140*	3-1/2"	9.40	7.52	3.46	4.53	5.66	-	3
15141*	4"	10.50	8.28	3.94	5.04	9.78	-	3

* Flexible Metal Conduit Only

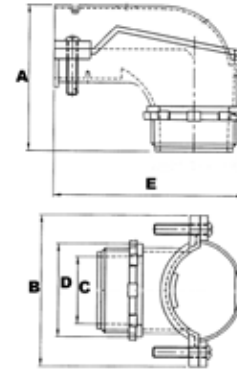

BX-Flex - MC



Squeeze Box Connectors 90° - Insulated Throat

- Used with a locknut to Terminate Steel or Aluminum Flexible Metal Conduit, AC and MC Cable to a steel outlet box or other metal enclosure
- Insulated Throat
- Assembled with Zinc Die Cast Locknut & Combo Screws



DIMENSIONS = INCHES

CAT. NO.	TRADE SIZE	DIMENSIONS					INNER BOX	OUTER BOX
		A	B	C	D	E		
15142	3/8"	1.26	1.34	.55	.97	1.81	50	500
15143	1/2"	1.54	1.65	.55	.97	2.18	25	250
15144	3/4"	1.61	1.89	.73	1.20	2.41	10	100
15145	1"	2.26	2.38	.96	1.46	2.83	5	50
15146*	1-1/4"	2.82	2.68	1.24	1.81	2.85	10	40
15147*	1-1/2"	4.08	3.76	1.44	2.32	6.01	2	12
15148*	2"	4.08	3.76	1.89	2.58	6.01	2	12
15149*	2-1/2"	6.90	5.40	2.30	3.07	6.875	-	6
15150*	3"	7.80	5.70	2.95	3.70	7.97	-	4
15151*	3-1/2"	9.40	7.52	3.27	4.53	5.57	-	3
15152*	4"	10.50	8.26	3.74	5.04	9.86	-	3

* Flexible Metal Conduit Only

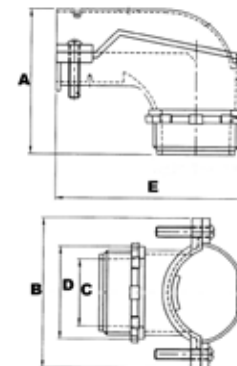



EMT to Flex Combination Coupling Squeeze Type - Zinc Die Cast



- Use to join EMT Conduit to Flexible Metal Conduit
- They allow a quick connection between different conduits to create one continuous raceway
- Their smooth interior surface ensures a snag free wire pull every time
- Pre-set and staked Robertson combo head screws

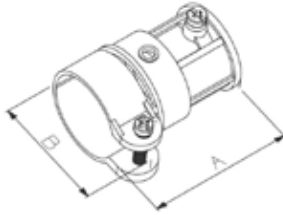

DIMENSIONS = INCHES

CAT. NO.	TRADE SIZE	DIMENSIONS			INNER BOX	OUTER BOX
		A	B			
15416	1/2"	1.65	1.42	25	250	
15417	3/4"	1.97	1.55	15	150	
15418	1"	2.00	1.63	-	200	

BX - Flex - MC

EMT to BX or NM Cable Combination Set Screw Couplings



- Set Screw 1/2" EMT to 2 Screw 3/8" BX/NM Cable
- Used on EMT Conduit, BX cable, NM cable
- They allow a quick connection between different conduits to create one continuous raceway
- Zinc Die Cast

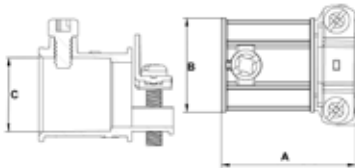

DIMENSIONS = INCHES

CAT. NO.	TRADE SIZE	DIMENSIONS			INNER BOX	OUTER BOX
		A	B	C		
15411	1/2"	1.33	.93	.73	50	500

EMT to Greenfield Combination Compression Couplings



- To join EMT to Flexible Metallic Conduit
- Compression for EMT and Screw-In for Flex Conduit
- Zinc Die Cast

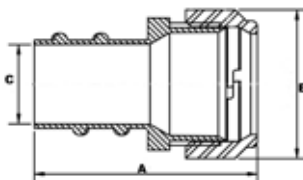

DIMENSIONS = INCHES

CAT. NO.	TRADE SIZE	DIMENSIONS			INNER BOX	OUTER BOX
		A	B	C		
15420	1/2"	1.61	.98	.57	50	500
15421	3/4"	1.87	1.20	.73	25	250
15422	1"	1.96	1.43	.92	10	100

Water-Tight Service Entrance Connectors - Zinc Die-Cast



- Compression Type SEU Connector
- Used to Connect Service Entrance Cable to a Service Enclosure in Wet Locations
- Accepts 2 Insulated Conductors, 1 Bare
- U/Flat Style Conductor Only
- Assembled with Rubber Grommet and Steel Washer
- Locknut Included

DIMENSIONS = INCHES

CAT. NO.	TRADE SIZE	CABLE SIZE	MAX GROMMET OPENING		OVERALL DIMENSIONS		INNER BOX	OUTER BOX
			LENGTH	WIDTH	A	B		
15370	1"	#8	.67	.40	1.67	1.45	20	100
15371	1"	#6	.77	.50	1.67	1.45	20	100
15372	1"	#4	.81	.53	1.67	1.45	20	100
15373	1-1/4"	#3	.92	.56	2.05	1.80	10	50
15374	1-1/4"	#2	.98	.59	2.05	1.80	10	50
15375	1-1/4"	#1	1.09	.65	2.05	1.80	10	50
15377	1-1/2"	#2/0	1.34	.86	2.31	2.02	10	50
15379	2"	#2/0	1.34	.86	2.82	2.39	5	25
15380	2"	#3/0	1.37	.87	2.82	2.39	5	25
15381	2"	#4/0	1.50	.90	2.82	2.39	5	25
15382	2"	#4/0	1.73	1.11	2.82	2.39	5	25

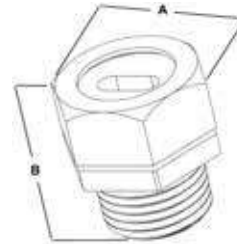

Service Entrance



Underground Feed UF To Box Connector - Zinc Die Cast

- Used to Connect Underground Feeder Cables (UF) To Weatherproof Enclosures in Wet Locations.
- Assembled with a Rubber Grommet and Steel Washer
- Sealing Locknut System

DIMENSIONS = INCHES

CAT. NO.	TRADE SIZE	CABLE SIZE	MAX GROMMET OPENING		OVERALL DIMENSIONS		INNER BOX	OUTER BOX
			LENGTH	WIDTH	A	B		
15386	1/2"	14/2, 12/2, 10/2	.475	.235	1.22	1.14	25	250
15387	3/4"	14/3, 12/3, 10/3, 8/2	.720	.260	1.34	1.20	25	250

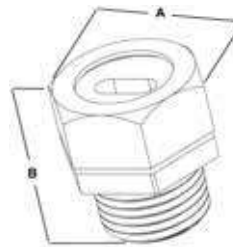

- UL 467 listed connector for use with Equipment Ground Conductors, Ground Electrode Conductors and Bonding Jumpers
- The Kenny Clamp bonds the enclosure of a service panelboard, load center, separately derived system or switchboard to the grounding electrode conductor per the requirements of NEC 250.8; 312.5(A); 250.53 D(2); 250.52 (A)(1); 250.52(A)(3); 250.66; 250.104 (D)(1); 250.24; 450.10(A)
- Assures good metallic connection and low impedance path for grounding and bonding of electrical equipment
- 12,000 Amp listed and tested
- Brass

Kenny Clamps

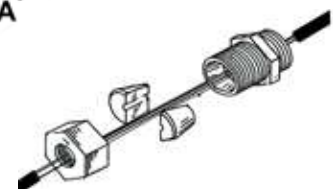
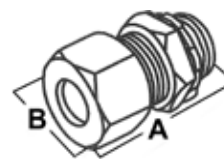

CAT. NO.	MODEL NO.	TRADE SIZE	DIMENSIONS		INNER BOX	OUTER BOX
			A	B		
15390	KC8ST	8 AWG STRANDED	1.75	1.06	10	100
15391	KC8SO	8 AWG SOLID	1.75	1.06	10	100
15392	KC6SO	6 AWG SOLID	1.75	1.06	10	100
15393	KC6ST	6 AWG STRANDED	1.75	1.06	10	100
15394	KC4SO	4 AWG SOLID	1.75	1.06	10	100
15395	KC4ST	4 AWG STRANDED	1.75	1.06	10	100
15396	KC2ST	2 AWG STRANDED	1.75	1.06	10	100
15397	KCIAST	1/0 STRANDED	1.75	1.06	10	100
15398	KC2AST	2/0 STRANDED	1.75	1.06	10	100
15399	KC3AST	3/0 STRANDED	1.75	1.06	10	100



Non-Metallic Service Entrance Cable Hoods

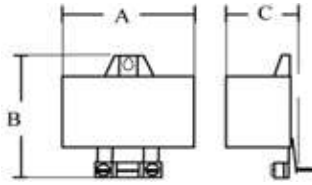

- Provides Protection to Service Entrance Cables
- Non-Metallic PVC construction
- Suitable for Outdoor use

DIMENSIONS = INCHES

CAT. NO.	CABLE SIZE	DIMENSIONS			BOX QTY
		A	B	C	
15500	(3)#3 TO #1	4.25	6.02	2.00	10
15501	(3)2/0 TO 4/0	5.90	6.12	2.50	10

Aluminum Service Entrance Caps - SEU Cable

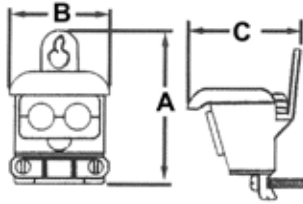

- Used with Type U Service Entrance Cable
- Removable Cap and 2 Piece Insulator Make Wire Pulling and Assembly Easy
- Cable Clamp
- Suitable for Outdoor use

DIMENSIONS = INCHES

CAT. NO.	CABLE SIZE	DIMENSIONS			BOX QTY
		A	B	C	
15502	(3)#8 TO #1	2.96	2.76	2.59	175
15504	(3)1/0 TO 4/0	4.48	3.79	3.60	54

PVC Entrance Caps - Cable Clamp

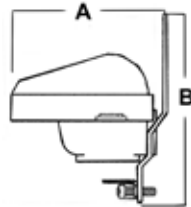

- Rigid, weather-resistant material assembled with a Galvanized Back Plate for easy installation

DIMENSIONS = INCHES

CAT. NO.	SIZE	CABLE SIZE	DIMENSIONS		BOX QTY
			A	B	
21772	SMALL	(3) #8, 6, 4, 2	2.75	2.80	20
21773	MEDIUM	(3) 1/0 TO 2/0	4.25	4.90	10
21774	LARGE	(3) 3/0 TO 4/0	4.25	4.90	10

PVC Entrance Caps - Conduit Mount

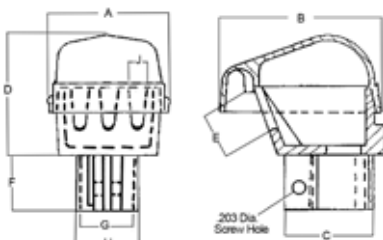

- Entrance head for mounting on PVC, RIGID, IMC and EMT Conduit (Red adaptor included for EMT)
- Rugged Non-Metallic Design is resistant to adverse weather conditions
- Provides 50% Larger Wiring Compartment than other entrance heads
- Entire Head acts as an Insulator of high dielectric strength

DIMENSIONS = INCHES

CAT. NO.	SIZE	DIMENSIONS									BOX QTY
		A	B	C	D	E	F	G	H	J	
21782	1/2"	2.00	2.71	1.50	1.97	.69	.94	.86	2.61	.31	200
21783	3/4"	2.41	2.30	1.72	2.23	.81	.94	1.07	1.25	.44	140
21784	1"	2.41	2.30	1.97	2.23	.81	1.13	1.33	1.31	.44	140
21785	1-1/4"	3.03	4.03	2.34	2.66	.88	1.09	1.68	1.89	.53	75
21786	1-1/2"	3.50	4.03	2.59	2.63	.88	1.13	1.92	2.13	.63	75
21787	2"	4.53	6.31	3.38	3.81	1.44	1.63	2.39	2.69	.75	20



Aluminum Service Entrance Cap - Clamp On



- Clamp-on type head used with Rigid conduit, IMC or E.M.T. for pulling service drop conductors
- Cast Aluminum
- Bar type Clamp
- Heavy pressure clamp in body
- Weather resistant
- Assembled with electrical grade phenolic insulator with multiple holes

DIMENSIONS = INCHES

CAT. NO.	TRADE SIZE	DIMENSIONS			INNER BOX	OUTER BOX
		A	B	C		
15520	1/2"	2.68	2.50	2.19	-	100
15521	3/4"	3.04	2.76	2.39	-	100
15522	1"	3.48	2.96	2.58	-	100
15523	1-1/4"	4.22	3.27	3.06	-	60
15524	1-1/2"	5.22	4.28	3.49	-	60
15525	2"	6.68	5.81	4.33	-	30
15526	2-1/2"	9.94	7.05	6.54	1	4
15527	3"	11.69	8.54	6.93	1	4
15528	3-1/2"	11.69	8.54	7.28	1	4
15529	4"	11.69	8.54	7.86	1	4

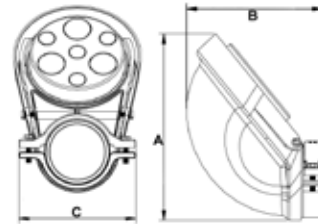

Service Entrance



Aluminum Service Entrance Cap - Conduit Mount Threaded

- Conduit Mount Head used with Rigid or IMC for Pulling Service Entrance Conductors
- Weather Resistant
- Assembled with Electrical Grade Phenolic Insulator with multiple holes

DIMENSIONS = INCHES

CAT. NO.	TRADE SIZE	DIMENSIONS			INNER BOX	OUTER BOX
		A	B	C		
15530	1/2"	1.97	2.68	2.29	-	100
15531	3/4"	2.13	3.04	2.66	-	100
15532	1"	2.36	3.48	2.96	-	100
15533	1-1/4"	2.68	4.22	3.11	-	60
15534	1-1/2"	3.39	5.22	4.06	-	60
15535	2"	4.33	6.69	5.28	-	30
15536	2-1/2"	6.30	9.94	6.69	1	4
15537	3"	7.99	11.69	8.08	1	4
15538	3-1/2"	7.99	11.69	8.08	1	4
15539	4"	7.99	11.69	8.08	1	4

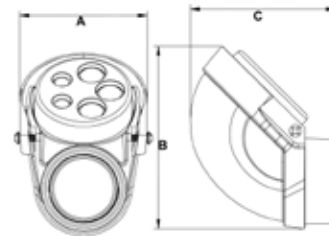

Aluminum Service Entrance Cap - Slip Fitter Mast Head

- Slip Fitter Mast Head used with Rigid or IMC Conduit for Pulling Service Drop conductors
- Cast Aluminum
- Mast type Clamp
- Screw does not bear directly on conduit
- Weather Resistant
- Assembled with electrical grade phenolic insulator with multiple holes

DIMENSIONS = INCHES

CAT. NO.	CONDUIT SIZE	INSULATOR CAP SIZE	DIMENSIONS			SET SCREW	BOX QTY
			A	B	C		
15540	2"	1-1/4"	3.46	1.95	3.75	1/4-20 X 5/8	50
15541	2-1/2"	1-1/4"	3.46	1.95	3.75	1/4-20 X 1/2	50
15542	2-1/2"	2"	4.68	1.95	4.88	1/4-20 X 5/8	50

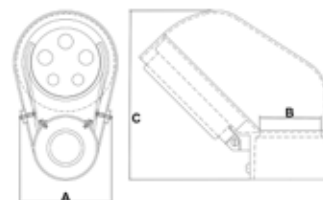



Malleable Mast Support Clamp

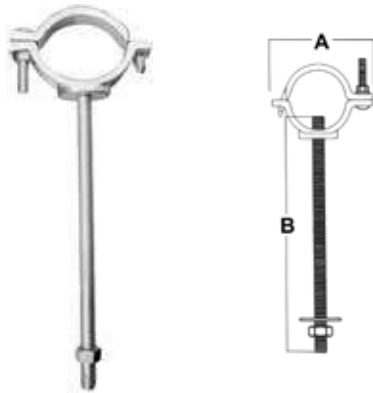

- Used to secure Service Entrance Conduit to the Outside surface of a building
- Hinged on one side and bolted on other side for easy installation
- Machined Bolt and Nut
- Malleable Iron

DIMENSIONS = INCHES

CAT. NO.	CONDUIT SIZE	DIMENSIONS		BOX QTY
		A	B	
21830	2"	4.23	10	25
21831	2-1/2"	4.79	10	25

Conduit Support Split Ring

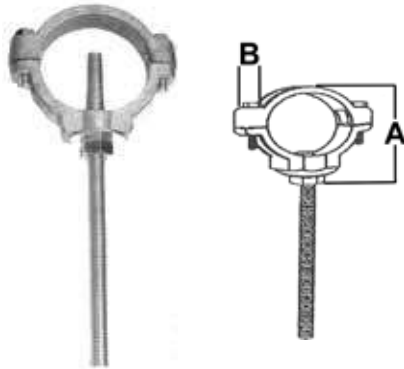

- Used to secure Service Entrance Conduit to the Outside surface of a building
- Bolted on both sides
- Malleable Iron

DIMENSIONS = INCHES

CAT. NO.	CONDUIT SIZE	BOLT SIZE	DIMENSIONS		BOX QTY
			A	B	
21835	2"	1/2" X 10"	2.70	.99	25
21836	2-1/2"	1/2" X 10"	3.33	1.07	25
21837	3"	5/8" X 13"	4.50	1.04	10
21838	3-1/2"	5/8" X 13"	5.13	1.08	10
21839	4"	5/8" X 13"	5.60	1.08	10

Conduit Support Universal



- Used to secure Service Entrance Conduit to the Outside surface of a building
- 1/2" x 10" Bolt
- Zinc Plated Steel

DIMENSIONS = INCHES

CAT. NO.	CONDUIT SIZE	DIMENSIONS		BOX QTY
		A	B	
21833	1-1/4" TO 3"	3.80	10.00	20

Malleable U-Bolt Pipe Clamps

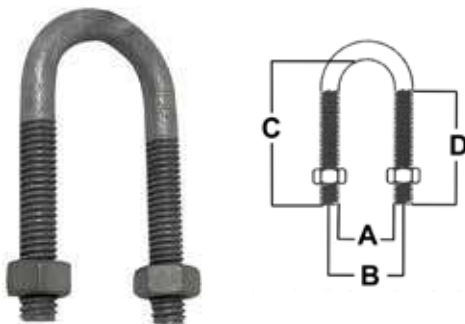

- Recommended for supporting or guiding heavy loads along runs of non-insulated pipe
- 2 hex nuts
- Malleable Iron - Galvanized

DIMENSIONS = INCHES

CAT. NO.	TRADE SIZE	DIMENSIONS				INNER BOX	OUTER BOX
		A	B	C	D		
21840	1/2"	1.00	1.25	2.50	1.81	25	250
21841	3/4"	1.12	1.38	2.81	1.81	25	250
21842	1"	1.38	1.63	3.06	1.81	25	250
21843	1-1/4"	1.75	2.00	3.19	1.81	20	200
21844	1-1/2"	2.00	2.38	3.50	1.81	20	200
21845	2"	2.50	2.50	4.50	2.63	10	100
21846	2-1/2"	3.00	3.25	4.88	2.63	-	20
21847	3"	3.63	3.88	5.38	2.63	-	20
21848	3-1/2"	4.06	4.56	5.88	2.63	-	20
21849	4"	4.69	5.06	6.69	2.63	-	20

Lag Type Service Insulator Wire Holder



- Indoor or Outdoor use in Overhead Service Entrance
- These small porcelain insulators can also be used with all fence wire including high tensile, poly rope and poly tape
- 600V or Less

DIMENSIONS = INCHES

CAT. NO.	DUTY	SCREW SIZE	DIMENSIONS			BOX QTY
			A	B	C	
21892	LIGHT	1/4" X 1-11/16"	1.37	1.98	1.62	100
21894	MEDIUM	3/8" X 2-1/4"	1.90	2.90	1.85	50



Porcelain Wire Holders - Heavy Duty Reinforced

- Single-point wire holders are strong and compact
- Solid Rivet through head
- Made with Porcelain and Galvanized Steel
- Quick and easy installation for most projects
- For use with wooden construction

DIMENSIONS = INCHES

CAT. NO.	SCREW SIZE	DIMENSIONS			BOX QTY
		A	B	C	
21896	3/8" X 2-1/4" LAG	2.11	2.90	3.00	50



Porcelain Wire Holders - Heavy Duty Adjustable

- Porcelain Wire holder has a steel reinforced saddle for use with pipe or pole attachment
- Adjustable Steel Clamp
- Fits 1-1/4" to 3" Conduit/Pipe

DIMENSIONS = INCHES

CAT. NO.	CONDUIT SIZE	DIMENSIONS			CLAMP MIN. DIA.	CLAMP MAX. DIA.	BOX QTY
		A	B	C			
21898	1-1/4" TO 3"	2.11	2.90	3.80	1.62	3.93	20



Service Entrance Insulator Wire Holder - 2" Pipe Hanger

- Ceramic Service Entrance Wire Insulator with 2" Conduit/Pipe Hanger Clamp
- Fits 2" Rigid or EMT Conduit

DIMENSIONS = INCHES

CAT. NO.	CONDUIT SIZE	DIMENSIONS			BOX QTY
		A	B	C	
21897	2"	2.11	2.90	2.38	25



Service Entrance Insulator Wire Holder - 3/8" X 5" Bolt

- Single-point wire holders are strong and compact
- Solid Rivet through head
- Made with Porcelain and Galvanized steel
- Bolt & Nut Type Wire Holder

DIMENSIONS = INCHES

CAT. NO.	BOLT SIZE	DIMENSIONS			BOX QTY
		A	B	C	
21899	3/8" X 5"	2.11	2.90	5.00	25



Porcelain Insulators



Wedge Clamps

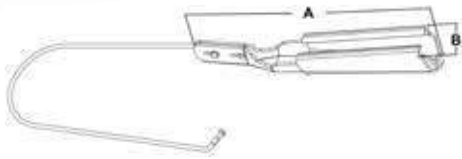

- Designed to hold triplex overhead service-entrance cable to a mounting structure
- Aluminum wedge and shell with a stainless-steel ball
- Can be used indoors or outdoors
- Corrosion resistant
- Installs quickly and easily

DIMENSIONS = INCHES

CAT. NO.	ACSR RANGE	DIMENSIONS		BOX QTY
		A	B	
28881	#6-#2	5.94	.85	50
28882	#4-1/0	7.21	1.04	25
28883	2/0-4/0	7.21	1.22	25

Hole Plugs

Wire Rope Clip - Guy Wire

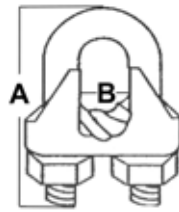

- For Guy Wire
- Malleable Iron
- Galvanized

DIMENSIONS = INCHES

CAT. NO.	TRADE SIZE	DIMENSIONS		BOX QTY
		A	B	
17302	1/4"	1.50	0.25	50

Steel Snap-In Blanks

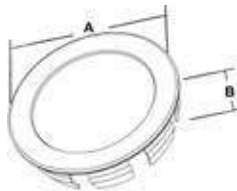

- For use in closing off unused openings in boxes or panel boards
- All steel construction provides installation integrity
- Snap-Fit Design

DIMENSIONS = INCHES

CAT. NO.	TRADE SIZE	DIMENSIONS		INNER BOX	OUTER BOX
		A	B		
21800	1/2"	1.08	.29	100	1,000
21801	3/4"	1.23	.31	100	1,000
21802	1"	1.47	.34	100	1,000
21803	1-1/4"	1.88	.37	50	500
21804	1-1/2"	2.22	.31	50	500
21805	2"	2.67	.34	10	100

Type S With Screw and Bar Knockout Seals



- Set screw/bar type knockout seals are inserted in open box knockouts to protect exposed wires
- Used in standard, air tight or dust tight applications
- Pre-assembled screw and backer bar slides on open knockout holes without removing box devices or covers
- Steel Galvanized

DIMENSIONS = INCHES

CAT. NO.	TRADE SIZE	DIMENSIONS		INNER BOX	OUTER BOX
		A	B		
21790	1/2"	1.20	.27	100	500
21791	3/4"	1.39	.32	100	500
21792	1"	1.66	.28	50	500
21793	1-1/4"	2.10	.33	50	500
21794	1-1/2"	2.46	.33	10	300
21795	2"	2.94	.34	10	300
21796	2-1/2"	3.75	.34	-	100
21797	3"	4.51	.34	-	100
21798	3-1/2"	5.01	.344	-	100
21799	4"	5.50	.34	-	100

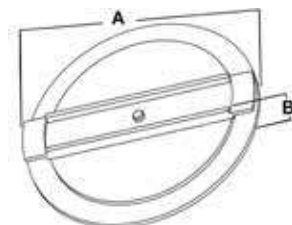



- To cap knockout holes in box or enclosure

DIMENSIONS = INCHES

CAT. NO.	TRADE SIZE	MOUNTING HOLE DIAMETER	A	BAG QTY
21721	1/2"	.85"	1-1/8"	100
21722	3/4"	1.10"	1-1/4"	100
21723	1"	1.35"	1-1/2"	50

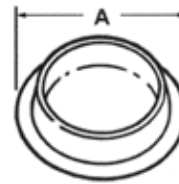

Plastic Knockout Plugs - Snap-In

- Plugs electrical knockouts with finger tip pressure
- Snap-In Winged Protrusion for Positive Lock
- Low cost and assures good appearance
- Less costly & safer than steel snap-in blanks
- 1/8" maximum steel thickness
- Made from UL approved Nylon 6/6, 94V-2

DIMENSIONS = INCHES

CAT. NO.	MOUNTING HOLE DIAMETER	HEAD DIAMETER	OVERALL HEIGHT	BAG QTY
22380	.18 (3/16")	.25"	.23"	10
22382	.31 (5/16")	.47"	.31"	10
22384	.37 (3/8")	.51"	.41"	10
22386	.50 (1/2")	.67"	.41"	10
22388	.63 (5/8")	.78"	.41"	10
22390	.75 (3/4")	.90"	.41"	10
22392	.87 (7/8") (1/2" TRADE)	.98"	.44"	10
22394	.98 (1")	1.11"	.44"	10
22396	1.18 (1-1/4")	1.35"	.44"	10
22398	1.50 (1-1/2")	1.67"	.44"	10
22400	1.75 (1-3/4")	1.93"	.44"	10

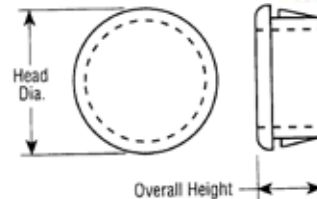

SIZES LISTED ARE ACTUAL DIAMETER
(NOT TRADE SIZES EXCEPT WHERE NOTED)

Plastic Pull Caps

- Used for capping EMT, IMC & Rigid Conduits and most bushings

DIMENSIONS = INCHES

CAT. NO.	TRADE SIZE	DIMENSIONS		BOX QTY
		A	B	
21712	1/2"	11/16"	5/8"	100
21713	3/4"	15/16"	13/16"	100
21714	1"	1-3/16"	1-1/16"	100
21715	1-1/4"	1-1/2"	1-3/8"	50
21716	1-1/2"	1-3/4"	1-9/16"	25
21717	2"	2-3/16"	2-1/16"	25

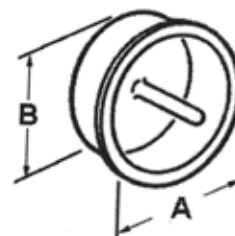



1 Hole EMT Pipe Straps - Steel



DIMENSIONS = INCHES



- Secures EMT Conduit
- Reinforced Rib for Extra Strength
- Reinforced Hole
- Snap-On Installation
- 3", 3-1/2" & 4" Fits EMT, Rigid or IMC conduit
- Zinc Plated Steel

CAT. NO.	TRADE SIZE	INNER BOX	OUTER BOX
19400	1/2"	100	1000
19401	3/4"	100	1000
19402	1"	100	500
19403	1-1/4"	25	250
19404	1-1/2"	20	100
19405	2"	10	100
19431*	3"	-	10
19432*	3-1/2"	-	10
19433*	4"	-	10

*Suitable for EMT, Rigid or IMC conduit

Straps

2 Hole EMT Pipe Straps - Steel



DIMENSIONS = INCHES



- Secures EMT Conduit
- Reinforced Rib for Extra Strength
- 2 Hole - Reinforced Holes
- Snap-On Installation
- Zinc Plated Steel

CAT. NO.	TRADE SIZE	INNER BOX	OUTER BOX
19412	1/2"	100	1,000
19413	3/4"	50	500
19414	1"	25	250
19415	1-1/4"	25	250
19416	1-1/2"	10	100
19417	2"	5	50

1 Hole Rigid Pipe Straps - Heavy Duty - Steel



DIMENSIONS = INCHES



- Secures Rigid & IMC Conduit
- Reinforced Rib for Extra Strength
- Reinforced Hole
- Snap-On Installation
- 3", 3-1/2", 4" Fits EMT, Rigid or IMC conduit
- Zinc Plated Steel

CAT. NO.	TRADE SIZE	INNER BOX	OUTER BOX
19424	1/2"	100	1,000
19425	3/4"	50	500
19426	1"	25	250
19427	1-1/4"	25	250
19428	1-1/2"	20	200
19429	2"	10	100
19430	2-1/2"	5	50
19431*	3"	-	10
19432*	3-1/2"	-	10
19433*	4"	-	10
19434**	5"	-	10
19435**	6"	-	10

* Suitable for EMT, Rigid or IMC conduit

**Not UL listed

2 Hole Rigid Pipe Straps - Steel



DIMENSIONS = INCHES



- Secures Rigid & IMC Conduit
- Reinforced Rib for Extra Strength
- Reinforced Holes
- Snap-On Installation
- Zinc Plated Steel

CAT. NO.	TRADE SIZE	INNER BOX	OUTER BOX
19436	1/2"	100	1,000
19437	3/4"	50	500
19438	1"	25	250
19439	1-1/4"	20	200
19440	1-1/2"	10	100
19441	2"	5	50
19442	2-1/2"	-	50
19443	3"	-	50
19444	4"	-	10
19445*	5"	-	10
19446*	6"	-	10

*Not UL listed

1 Hole Rigid Pipe Straps - Malleable Iron



- Secures Rigid & IMC Conduit
- Malleable Iron, Heavy Duty Casting
- Reinforced Rib for Extra Strength
- Snap-On Installation
- Zinc Plated

DIMENSIONS - INCHES

CAT. NO.	TRADE SIZE	DIMENSIONS				INNER BOX	OUTER BOX
		A	B	C	D		
19522	1/2"	2.25	.66	.94	.35	100	1,000
19523	3/4"	2.26	.75	1.22	.49	50	500
19524	1"	3.06	.81	1.50	.63	25	250
19525	1-1/4"	3.69	.88	1.88	.82	20	200
19526	1-1/2"	4.00	1.00	2.06	.91	10	100
19527	2"	5.06	1.13	2.56	1.16	-	25
19528	2-1/2"	6.10	1.60	3.30	1.38	-	25
19529	3"	7.28	1.46	3.70	1.71	-	25
19531	4"	8.86	2.08	4.85	2.23	-	10
19532	5"	9.38	2.59	6.00	2.88	-	2
19533	6"	10.38	3.13	7.00	3.38	-	2

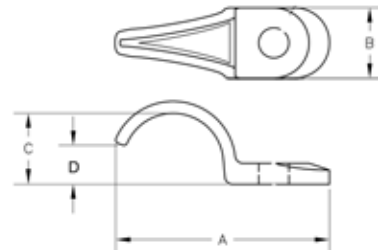

Malleable EMT/Rigid Clamp Back Spacers

- Provides Space between conduit and mounting surface
- For use with malleable iron or aluminum straps
- Can be used with one hole straps
- Heavy Duty Casting

DIMENSIONS - INCHES

CAT. NO.	TRADE SIZE	DIMENSIONS							INNER BOX	OUTER BOX
		A	B	C	D	E	F	G		
14782	1/2"	2.06	1.00	.50	.43	.32	.40	.08	25	250
14783	3/4"	2.38	1.06	.50	.53	.32	.40	.08	25	250
14784	1"	2.94	1.25	.56	.67	.32	.40	.08	25	250
14785	1-1/4"	3.50	1.38	.75	.84	.32	.40	.08	10	100
14786	1-1/2"	3.81	1.44	.81	.96	.32	.40	.08	10	100
14787	2"	4.75	1.94	1.00	1.20	.32	.40	.08	5	50
14788	2-1/2"	5.75	2.44	.75	1.45	.32	.40	.08	-	25
14789	3"	6.69	2.63	.088	1.77	.32	.40	.08	-	10
14790	3-1/2"	7.13	2.88	1.08	2.02	.32	.40	.08	-	10
14791	4"	8.88	3.06	1.06	2.27	.32	.40	.08	-	10
14792	5"	10.13	3.75	.06	2.81	.32	.40	.08	-	10
14793	6"	12.19	4.00	.75	3.35	.32	.40	.08	-	10

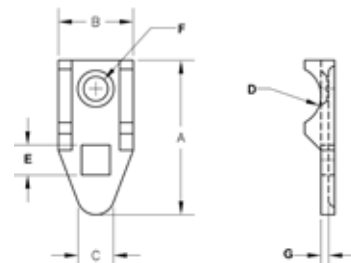

1 Hole SEU Pipe Straps

- Secures SE & SEU Service Entrance Cable
- Zinc Plated Steel

CAT. NO.	CABLE SIZE	INNER BOX	OUTER BOX
19452	(3)#8, (3)#6 OR (3)#4	100	1,000
19453	(3)#3 OR (3)#2	100	1,000
19454	(3)#1, (3)#1/0, (3)#2/0	50	500
19455	(3)#3/0, (3)#4/0	50	500



2 Hole SEU Pipe Straps

- Secures SE & SEU Service Entrance Cable
- Zinc Plated Steel

CAT. NO.	CABLE SIZE	INNER BOX	OUTER BOX
19456	(3)#8 OR (3)#6, (3)#4	100	1,000
19457	(3)#2 OR (3)#3	100	1,000
19458	(3)#1, (3)#1/0, OR (3)#2/0	50	500
19459	(3)#3/0, (3)#4/0	25	250





Non Metallic Cable One Hole Strap



BX 1 Hole Strap

- Used To Secure 14/2 NM Romex Cables
- Zinc Plated Steel
- Reinforced Rib for Extra Strength

CAT. NO.	CABLE SIZE	INNER BOX	OUTER BOX
19460	14/2	25	250



- These one-hole pipe straps are ideal for hanging tubing, pipe, conduit and BX cable
- Pre-galvanized zinc plated steel

CAT. NO.	CABLE SIZE	BOX QTY
19463*	BX: 14-2 THRU 10-3	100
19464	EMT: 1/2", RIGID: 1/4", BX: 12-3,10-2,10-3 SER 8	100

*Not UL listed



2 Hole PVC Pipe Straps



- For Schedule 40 PVC Conduit
- Heavy Duty Polyethylene resists deterioration from UV rays and breakage from extreme cold

DIMENSIONS = INCHES

CAT. NO.	TRADE SIZE	BOX QTY
19490	1/2"	100
19492	3/4"	100
19494	1"	100
19496	1-1/4"	50
19498	1-1/2"	50
19498B	1-1/2"	900
19500	2"	50
19500B	2"	550
19501	2-1/2"	25
19502	3"	25
19503	4"	25

Conduit Hanger with Bolt



- Secures EMT or Rigid Conduit to any mounting surface, Threaded Rod or Insulated Supports
- Zinc Plated Steel

DIMENSIONS = INCHES

CAT. NO.	TRADE SIZE	OUTER BOX
19470	1/2"	100
19471	3/4"	100
19472	1"	100
19473	1-1/4"	100
19474	1-1/4" RIGID TO 1-1/2" EMT	100
19475	1-1/2"	100
19476	2"	50
19477	2-1/2"	25
19478	3"	25
19479	3-1/2"	25
19480	4"	25





Channel Nut - No Spring



- For all channel sizes
- 7404 can not be used with 13/16" & 1" channel
- Zinc Electroplate Finish

DIMENSIONS = INCHES

CAT. NO.	THREAD	THICKNESS	BOX QTY
17400	1/4"-20	.25"	100
17402	3/8"-16	.37"	100
17404	1/2"-13	.50"	100

Channel Nut - Short Spring



- For 13/16" & 1" channel
- Zinc Electroplate Finish

DIMENSIONS = INCHES

CAT. NO.	THREAD	THICKNESS	BOX QTY
17412	1/4"-20	.25"	100
17420	3/8"-16	.37"	100

Channel Nut Regular Spring

- For 1-3/8" & 1-5/8" channel
- Zinc Electroplate Finish

DIMENSIONS = INCHES

CAT. NO.	THREAD	THICKNESS	BOX QTY
17430	1/4"-20	.25"	100
17438	3/8"-16	.37"	100
17442	1/2"-13	.50"	100



Post Base Single Channel 2 Hole Standard Strut 1-5/8"

- Secures Strut Assembly to Floor or other Surface
- Galvanized Steel
- 2 Mounting Holes
- 4" X 6" Base

CAT. NO.	BOX QTY
17450	5

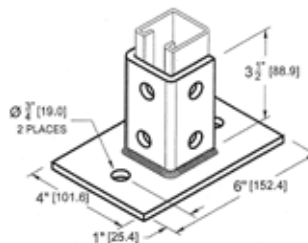

Post Base Single Channel 4 Hole Standard Strut 1-5/8"

- Secures Strut Assembly to Floor or other Surface
- Galvanized Steel
- 4 Mounting Holes
- Corner Orientation
- 6" X 6" Base

CAT. NO.	BOX QTY
17452	5

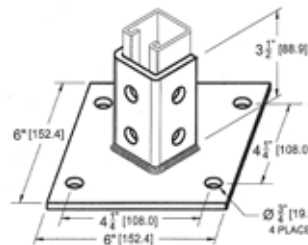

Post Base Single Channel 4 Hole Square Strut 1-5/8"

- Secures Strut Assembly to Floor or other Surface
- Galvanized Steel
- 4 Mounting Holes
- Side Orientation
- 6" X 6" Base

CAT. NO.	BOX QTY
17454	5

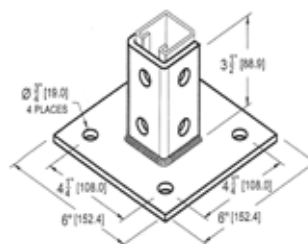



STEEL HAS ZINC ELECTROPLATE FINISH, 1-5/8" WIDE X 1/4" THICK. HOLES ARE 9/16" DIAMETER, 13/16" CENTER TO EDGE ON 1-7/16" CENTERS

Square Washer

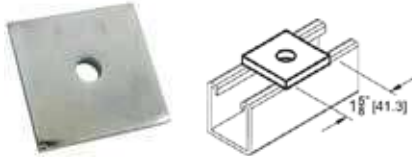

DIMENSIONS = INCHES

CAT. NO.	BOLT SIZE	HOLE SIZE	BOX QTY
17612	1/4"	5/16"	100
17616	3/8"	7/16"	100
17618	1/2"	9/16"	100

2 Hole Splice Plate



CAT. NO.	BOX QTY
17622	50

3 Hole Splice Plate

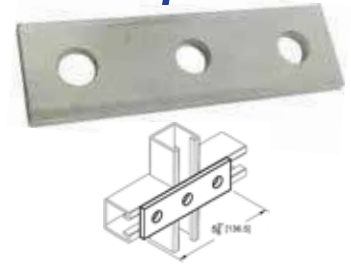

CAT. NO.	BOX QTY
17624	25

4 Hole Splice Plate

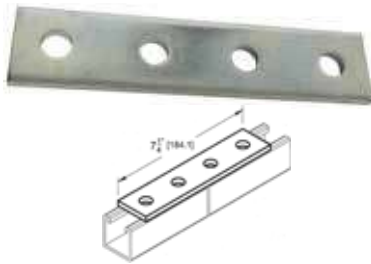

CAT. NO.	BOX QTY
17626	25

4 Hole Tee Plate



CAT. NO.	BOX QTY
17636	20

3 Hole Corner Plate

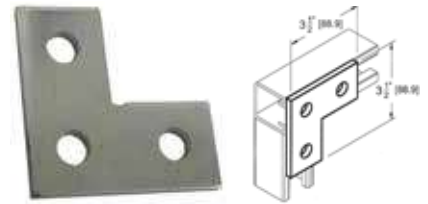

CAT. NO.	BOX QTY
17632	25

2 Hole Cross Corner Angle

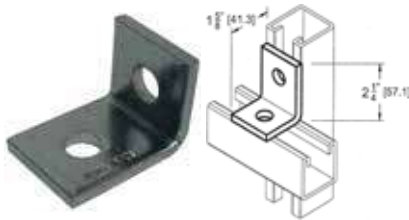

CAT. NO.	BOX QTY
17630	50

2 Hole Corner Angle

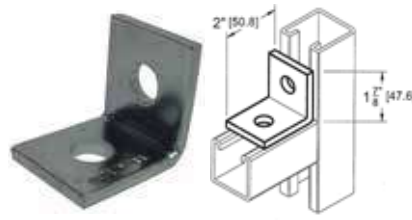

CAT. NO.	BOX QTY
17628	50

4 Hole 3 Way Corner Angle

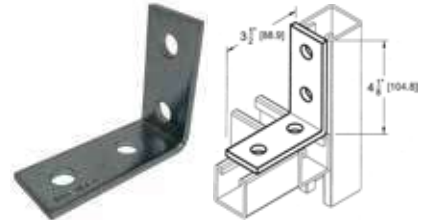

CAT. NO.	BOX QTY
17634	25

3 Hole Cross Corner Angle

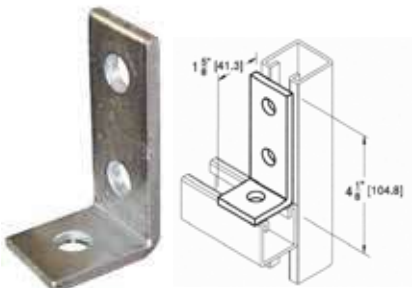

CAT. NO.	BOX QTY
17633	50

2 Hole Open Corner Angle

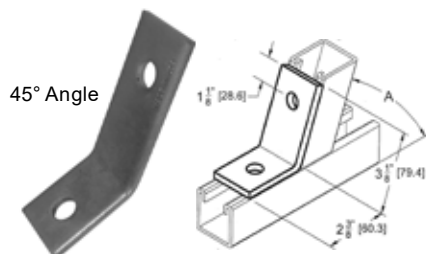

CAT. NO.	BOX QTY
17638	50

Plastic White End Caps

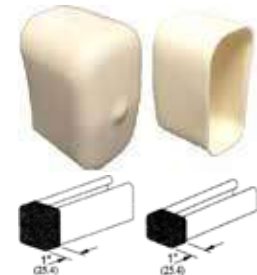

CAT. NO.	CHANNEL USED WITH	BOX QTY
17682	13/16"	100
17684	1-5/8"	100

- Secures Rigid/IMC Conduit To Strut
- Zinc Electroplate Finish
- 2-1/2" through 8" Suitable for Rigid and EMT

DIMENSIONS = INCHES

CAT. NO.	PIPE SIZE (INCH)	O.D. (INCH)	DESIGN LOAD (LBS)	BOX QTY
17514	1/2"	.840"	400	100
17515	3/4"	1.050"	600	100
17516	1"	1.315"	600	100
17517	1-1/4"	1.660"	600	50
17518	1-1/2"	1.900"	800	50
17519	2"	2.375"	800	50
17520*	2-1/2"	2.875"	800	50
17521*	3"	3.500"	800	25
17522*	3-1/2"	4.000"	1000	25
17523*	4"	4.500"	1000	25
17524*	5"	5.562"	1000	25
17525*	6"	6.625"	1000	25
17526*	8"	8.625"	1000	25

*Suitable for Rigid or EMT Conduit

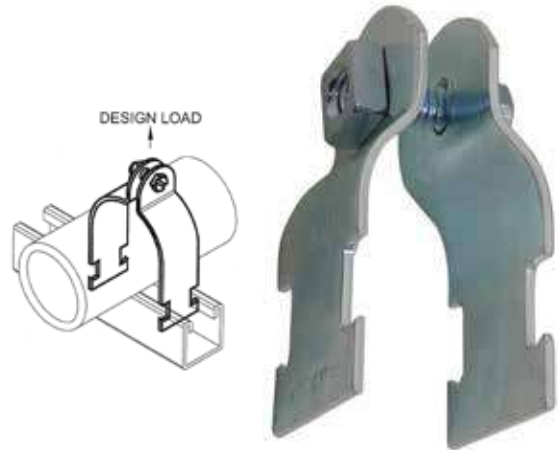

Universal Strut Clamp

- Secures Rigid/IMC & EMT Conduit To Strut
- Zinc Electroplate Finish

DIMENSIONS = INCHES

CAT. NO.	PIPE SIZE (INCH)	O.D. (INCH)	DESIGN LOAD (LBS)	BOX QTY
17532	1/2"	.773"	400	100
17533	3/4"	.986"	600	100
17534	1"	1.239"	600	100
17535	1-1/4"	1.585"	600	50
17536	1-1/2"	1.820"	800	50
17537	2"	2.286"	800	50

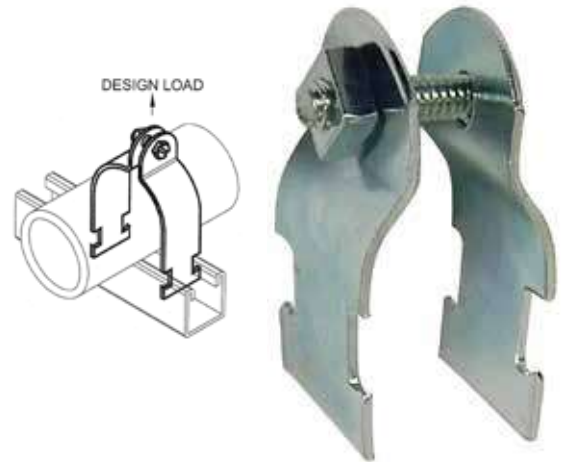

EMT Strut Clamp

- Secures EMT Conduit To Strut
- Zinc Electroplate Finish

DIMENSIONS = INCHES

CAT. NO.	PIPE SIZE (INCH)	O.D. (INCH)	DESIGN LOAD (LBS)	BOX QTY
17542	1/2"	.706"	400	100
17543	3/4"	.922"	400	100
17544	1"	1.163"	600	100
17545	1-1/4"	1.510"	600	50
17546	1-1/2"	1.740"	800	50
17547	2"	2.197"	800	50

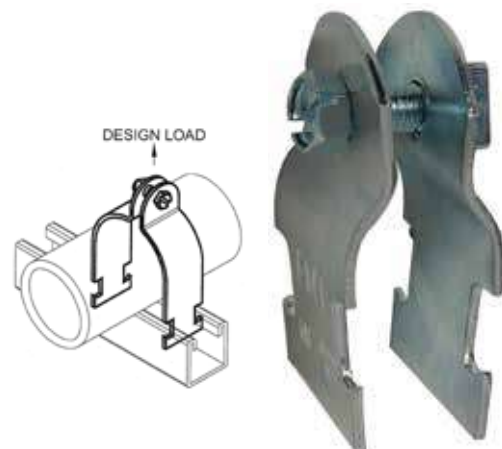



Malleable Right Angle Pipe Clamp



- Right Angle 90° Conduit Support Secures Rigid, IMC or EMT Perpendicular to Steel Beam, Strut Channel or Angle Supports
- Electro Zinc Plated
- Malleable Iron Cradle
- Steel Galvanized Bolt/Hex Nuts

DIMENSIONS = INCHES

CAT. NO.	TRADE SIZE	DIMENSIONS			OUTER BOX
		A	B	C	
21850	3/8"	.820	1.00	1.12	50
21851	1/2"	1.00	1.25	2.50	50
21852	3/4"	1.125	1.125	2.81	50
21853	1"	1.375	1.375	3.06	50
21854	1-1/4"	1.75	1.75	3.19	50
21855	1-1/2"	2.00	2.375	3.50	50
21856	2"	2.50	2.50	4.50	50
21857	2-1/2"	3.00	3.00	4.875	25

Malleable Parallel Pipe Clamp



- Parallel Conduit Support Secures Rigid, IMC or EMT Parallel to Steel Beam, Strut Channel or Angle Supports
- Electro Zinc Plated
- Malleable Iron Cradle
- Steel Galvanized Bolt/Hex Nuts

DIMENSIONS = INCHES

CAT. NO.	TRADE SIZE	DIMENSIONS		OUTER BOX
		A	B	
21861	1/2"	2.00	1.37	50
21862	3/4"	2.88	1.44	50
21863	1"	3.06	1.69	50
21864	1-1/4"	3.63	2.125	25
21865	1-1/2"	3.88	2.19	25
21866	2"	4.63	2.88	25
21867	2-1/2"	5.25	3.25	25
21868	3"	5.88	3.88	10
21869	3-1/2"	6.31	4.31	10
21870	4"	6.81	4.81	10

Malleable Edge Pipe Clamp

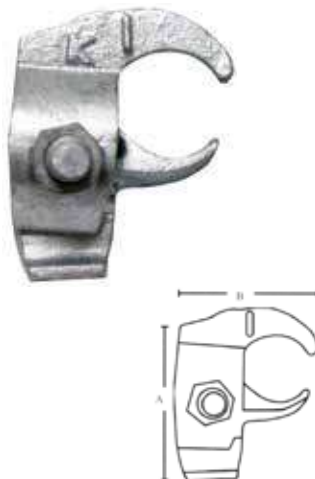

- Edge Conduit Clamp Secures Rigid, IMC or EMT Perpendicular to edge of Steel Beam, Strut Channel or Angle Supports
- Electro Zinc Plated
- Malleable Iron Cradle
- Steel Galvanized Bolt/Hex Nuts

DIMENSIONS = INCHES

CAT. NO.	TRADE SIZE	DIMENSIONS		OUTER BOX
		A	B	
21871	1/2"	2.81	2.13	50
21872	3/4"	2.94	2.38	50
21873	1"	3.06	2.63	25
21874	1-1/4"	3.06	3.06	25
21875	1-1/2"	3.94	3.25	25
21876	2"	4.50	4.06	25
21877	2-1/2"	5.13	4.63	10
21878	3"	5.75	5.25	10

Strut to Beam Clamp with Square U-Bolt



- For 13/16" & 1-5/8" Channel
- Design load 1,200 lbs. when used in pairs
- Zinc Electroplate Finish

CAT. NO.	DESCRIPTION	BOX QTY
17462	BEAM CLAMP FOR 13/16" & 1-5/8" CHANNEL	25

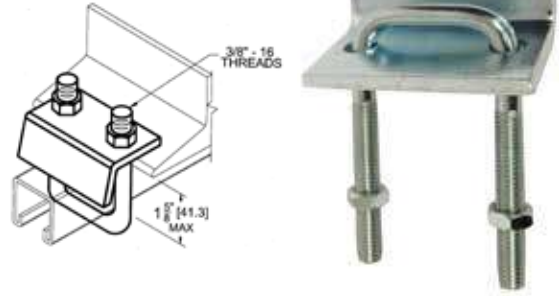

Strut to Beam Clamp with Square U-Bolt

- For 2-7/16" & 3-1/4" Channel
- Design load 1,200 lbs. when used in pairs
- Zinc Electroplate Finish

CAT. NO.	DESCRIPTION	BOX QTY
17464	BEAM CLAMP FOR 2-7/16" & 3-1/4" CHANNEL	25

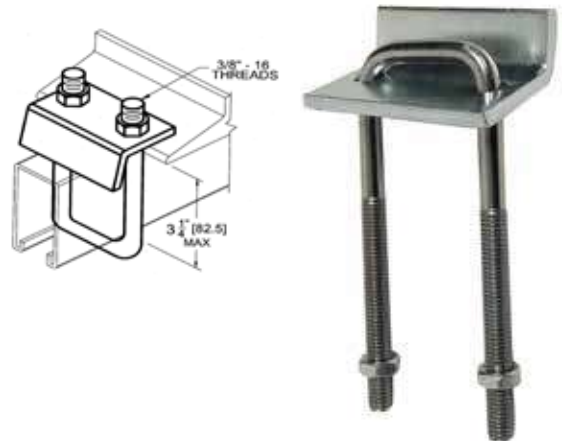

Strut Fitting Torque Values

- The following are the torque values used for determining the load ratings of fittings when attached to channel framing as specified in the Metal Framing Manufacturers Association (MFMA) Standard #2

THREAD SIZE	TORQUE		
	IN. LB.	FT. LB.	NM
1/4"	72	6	8.1
3/8"	228	19	25.8
1/2"	600	50	67.8

Beam Clamp Torque Values

- For beam clamps or other applications the following torque values from Manufacturer's Standardization Society (MSS) SP-69 are recommended unless otherwise specified

THREAD SIZE	TORQUE		
	IN. LB.	FT. LB.	NM
1/4"	40	3.3	4.5
3/8"	60	5.0	6.8
1/2"	125	10.4	14.1



Beam Clamps Universal



Strut Accessories

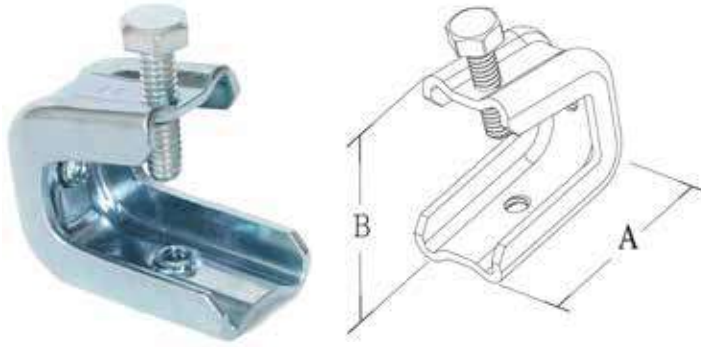

- Used with Conduit Hangers, Bridle Rings and Threaded Rod
- Tapped for Rods - bottom and back
- Case Hardened Steel Set Screw tapped at an angle - locks on beam
- Zinc Plated Steel

DIMENSIONS = INCHES

CAT. NO.	FITS FLANGE	BOTTOM & BACK THREADS	STATIC LOAD LIMIT BOTTOM HOLE ONLY	SCREW DIMENSIONS	A	B	INNER BOX	MASTER BOX
17468	1/2	1/4-20	75 LBS	1/4-20 X 1"	1.69	1.66	25	250
18111*	1/2	10-24	75 LBS	1/4-20 X 1"	1.65	1.40	-	50
17469	3/4	3/8-16	200 LBS	5/16-18 X 1-3/8"	2.15	2.01	-	50

*Not UL Listed

Malleable Iron Universal Beam Clamp

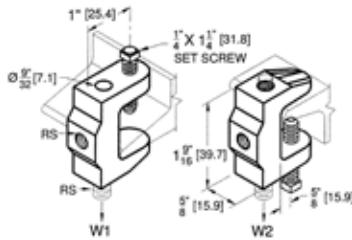

- Maximum Flange Thickness of 5/8"
- The threaded hole on the back side of the clamp is not load rated
- Zinc Electroplate Finish

CAT. NO.	ROD SIZE (RS)	MAX LOAD (W1)	MAX LOAD (W2)	BOX QTY
17486	1/4"-20	100 LBS.	250 LBS.	100

Malleable Iron Rod Support Beam Clamp

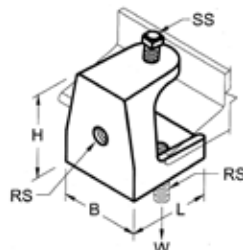

- Used with Conduit Hangers, Bridle Rings & Drop Rods. 1/4" to 1/2"
- Tapped for Rods - bottom and back on all sizes
- Malleable Iron - Zinc plated

DIMENSIONS = INCHES

CAT. NO.	JAW OPENING	ROD SIZE (RS)	SET SCREW SIZE	MAX LOAD (W)	B	L	H	BOX QTY
17472	3/4"	1/4"-20	5/16"-18	125 LBS.	1.18"	1.38"	1.38"	50
17474	7/8"	3/8"-16	1/2"-13	300 LBS.	2.00"	1.87"	1.75"	50
17476	1-1/8"	1/2"-13	1/2"-13	750 LBS.	2.50"	2.37"	2.14"	25



- Impact resistant, non-corrosive
- Complete with corrosion resistant, hardened steel nails for securing cable to wood, cement, plaster, brick, etc.
- Nail heads are recessed for minimum exposure
- Smooth saddle prevents damage to insulation
- High-grade injection-molded polyethylene
- Resists rot, rust and the effects of temperature extremes



FIG 1

FIG 2

FIG 3

DIMENSIONS = INCHES

CAT. NO.	FIG	USED FOR WIRE SIZES	COLOR	W X HT X INSIDE HT	INNER BAG	MASTER BAG
35000	1	2 NAIL 12/2 & 14/2 NM & UF (1/2" WIDE)	WHITE	.49 X .31 X .21	100	1,000
35001	1	2 NAIL 10/2 NM & UF (3/4" WIDE)	WHITE	.74 X .31 X .21	100	1,000
35002	2	12/2 & 14/2 NM & UF	WHITE	.39 X .39 X .26	100	1,000
35004	3	14/3 NM	GRAY	.31 X .51 X .32	100	1,000
35006	3	10/3 & 12/3 NM	GRAY	.43 X .65 X .48	100	1,000
35008	3	RG 59 COAX CABLE, CAT 5 UTP 4 PAIR	GRAY	.24 X .35 X .26	100	1,000
35040	3	RG 59 COAX CABLE, CAT 5 UTP 4 PAIR	WHITE	.24 X .35 X .26	100	1,000
35041	3	RG 59 COAX CABLE, CAT 5 UTP 4 PAIR	BLACK	.24 X .35 X .26	100	1,000
35010	3	RG 6 COAX CABLE	GRAY	.28 X .43 X .30	100	1,000
35042	3	RG 6 COAX CABLE	WHITE	.28 X .43 X .30	100	1,000
35043	3	RG 6 COAX CABLE	BLACK	.28 X .43 X .30	100	1,000
35012	3	4 CONDUCTOR TELEPHONE WIRE	GRAY	.14 X .23 X .15	100	1,000
35044	3	4 CONDUCTOR TELEPHONE WIRE	WHITE	.14 X .23 X .15	100	1,000
35045	3	4 CONDUCTOR TELEPHONE WIRE	BLACK	.14 X .23 X .15	100	1,000
35014	2	SMALL CORDS SUCH AS LAMP, THERMOSTAT, SPEAKER & PHONE	WHITE	.24 X .25 X .15	100	1,000



- Plastic insulated staples quickly and easily secure vertical stacks of non-metallic cable
- Electro-zinc plated nails provide strength and durability
- Smooth saddles prevent damage to insulation
- UV-protected Polyethylene saddle resists rot, rust and deterioration
- 1/2" wide, white color

CAT. NO.	CABLE SIZE	INNER BAG	OUTER BAG
35016	(2) 14/2 & 12/2	50	500
35018	(3) 14/2 & 12/2	50	500
35020	(4) 14/2 & 12/2	50	500

Plastic Stacking Staples



Plastic Service Entrance Cable Straps

- Plastic insulated straps quickly and easily secure service entrance cable
- Electro-zinc plated nails provide strength and durability
- Stabilized against UV rays and extreme cold; withstand deterioration and breakage
- Smooth saddles prevent damage to insulation
- Polyethylene Material

CAT. NO.	CABLE SIZE	INNER BAG	OUTER BAG
35022	#6 & #8 SEU	50	500
35024	#2 SEU	25	250
35026	4/0 SEU	25	250
35028	#6 SER & 1/2" EMT	50	500
35030	#2 SER & 3/4" EMT	25	250
35032	2/0 SER	25	250
35034	4/0 SER	25	250



35028 THRU 35034

35022 THRU 35026



Cable Stacker

Cable Stacker

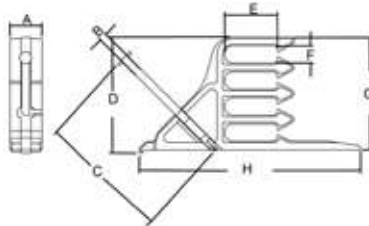

- Accepts a wide range of NM cables
- Angled nail allows easy installation from any direction regardless of stud positioning and spacing
- Keeps a professional look in exposed areas
- Cables snap easily in between tines for a secure hold
- Makes cable identification simple
- Also used with CATV, Telephone, Instrumentation and Security Cables
- Material: Polypropylene

DIMENSIONS = INCHES

CAT. NO.	DIMENSIONS								BAG QTY	CASE QTY
	A	B	C	D	E	F	G	H		
21757	.47	.11	1.93	1.72	.78	.26	1.67	3.26	25	1,000

Nail Straps - Heavy Duty - Rigid IMC & EMT



- Secures Rigid, IMC & EMT Conduits thru 1" Diameter
- Zinc Plated Stamped Steel
- Wood or Masonry Applications

DIMENSIONS = INCHES

CAT. NO.	TRADE SIZE	DIMENSIONS		INNER BOX	OUTER BOX
		A	B		
19482	1/2"	2.13	1.10	100	1,000
19483	3/4"	2.13	1.20	100	1,000
19484	1"	2.25	1.50	50	500

Nail Plates

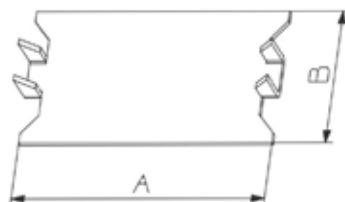

- Used to protect internal wire runs from nail punctures
- Hammer On
- Zinc Plated Stamped Steel

DIMENSIONS = INCHES

CAT. NO.	TRADE SIZE	DIMENSIONS		INNER BOX	OUTER BOX
		A	B		
19542	1-1/2" X 2-1/2"	2.5	1.5	100	500

14650	8	14400-14403	5	15040-15045	5,17	17682-17684	61	22582-22588	39
15627	8	14404-14407	6	15052-15060	44	19012-19015	43	22590-22599	38
15636	8	14408-14409	1	15065-15067	45	19400-19405	57	22600-22604	38
17302	55	14420-14425	6	15070-15089	46	19412-19417	57	28881-28883	55
17486	65	14440-14456	3	15110-15130	47	19424-19446	57	35000-35034	66
18111	65	14460-14467	7	15131-15152	48	19431-19433	57	35040-35045	66
19542	67	14480-14489	7	15161-15166	31	19452-19459	58	T6-12-4	29
21757	67	14490-14499	8	15181-15186	31	19460-19464	59	T6-12-4NM	29
21760	33	14502-14504	7	15201-15206	31	19470-19480	59	T6-12-6	29
14002-14016	28	14530-14549	9	15221-15226	31	19482-19484	67	T6-12-6NM	29
14030-14036	28	14570-14585	9	15240-15261	30	19490-19503	59	T6-34-4	29
14040-14079	19	14600-14604	8	15280-15301	30	19522-19533	58	T6-34-4NM	29
14080-14119	20	14610-14619	8	15330-15339	43	21700-21709	16	T6-34-6	29
14120-14139	21	14620-14634	35	15370-15399	50	21712-21716	56	T6-34-6NM	29
14140-14145	22	14635-14637	8	15411-15422	49	21721-21723	56	T750-10100	29
14150-14155	22	14638-14641	8	15450-15460	38	21732-21743	10	T750-10500	29
14160-14165	22	14642-14646	8	15500-15504	51	21752-21756	45	T750-12100	29
14170-14175	22	14647-14648	8	15520-15542	52	21762-21766	42	T750-12100BOX	29
14180-14185	23	14655-14659	8	15601-15615	8	21772-21774	51	T750-121000	29
14190-14195	23	14660-14689	10	15643-15645	8	21782-21787	51	T750-125100	29
14200-14205	23	14691-14697	8	15650-15658	8	21790-21799	55	T750-1550	29
14210-14215	23	14700-14709	10	15661-15663	8	21800-21805	55	T750-2050	29
14220-14225	24	14720-14722	35	15670-15676	8	21813-21828	32	T750-34100	29
14230-14235	24	14730-14741	36	15680-15682	8	21830-21849	53	T750-34800	29
14240-14251	25	14742-14751	36	16001-16020	18	21850-21857	63	T750-NMLT50	32
14252-14263	25	14754-14759	36	16101-16122	4	21861-21878	63	T750-NMLT75	32
14264-14287	26	14760-14771	35	16151-16168	4	21892-21899	54	T750-NMLT9050	32
14288-14299	27	14782-14793	58	16172-16175	4	22230-22310	40	T750-NMLT9075	32
14300-14306	21	14800-14819	37	17400-17454	60	22311-22332	33	T750-SLTC50	32
14307-14314	27	14850-14879	11	17462-17464	64	22342-22356	34	T750-SLTC75	32
14340-14345	1	14880-14909	12	17468-17469	65	22362-22372	34	T750-SLTC9050	32
14350-14359	1	14910-14939	13	17472-17476	65	22380-22400	56	T750-SLTC9075	32
14360-14365	2	14940-14969	14	17514-17526	62	22532-22548	41	TB6-12-4NM	29
14370-14375	2	14970-14999	15	17532-17537	62	22550-22555	39	TB6-12-6NM	29
14380-14385	2	15010-15022	16	17542-17547	62	22556-22561	39	TB6-34-6NM	29
14387-14398	3	15030-15045	17	17612-17638	61	22562-22568	41		

**WIRE
MANAGEMENT**

CONNECTORS

FITTINGS

LIGHTING

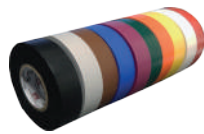

MORRIS PRODUCTS INC.
53 CAREY ROAD
QUEENSBURY, NY 12804
INFO@MORRISPRODUCTS.COM
1.888.777.6678



MORRISPRODUCTS.COM

7 / 2022

**SINGLE SOURCE...
ELECTRICAL & LIGHTING**